



## Model Number

NBN8-18GM60-WS

## Features

- 8 mm not embeddable
- 2-wire AC

## Connection

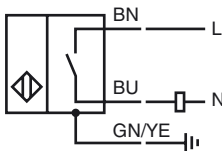

## Accessories

### BF 18

Mounting flange, 18 mm

## Dimensions

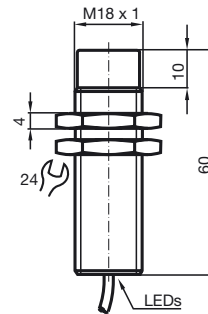

## Technical Data

### General specifications

Switching element function	AC	NO
Rated operating distance	$s_n$	8 mm
Installation	not embeddable	
Output polarity	AC	
Assured operating distance	$s_a$	0 ... 6.48 mm
Reduction factor $r_{Al}$	0.4	
Reduction factor $r_{Cu}$	0.4	
Reduction factor $r_{303}$	0.7	

### Nominal ratings

Operating voltage	$U_B$	20 ... 253 V
Switching frequency	$f$	0 ... 20 Hz
Hysteresis	$H$	typ. 7.5 %
Reverse polarity protected	tolerant	
Voltage drop	$U_d$	< 5 V ( $I_L > 50$ mA); < 8 V ( $I_L < 50$ mA)
Momentary current (20 ms, 0.1 Hz)	0 ... 1600 mA	
Operating current	$I_L$	5 ... 200 mA
Off-state current	$I_r$	0 ... 1.7 mA typ.
Operating voltage display	LED, green	
Indication of the switching state	LED, yellow	

### Ambient conditions

Ambient temperature	-25 ... 70 °C (-13 ... 158 °F)
---------------------	--------------------------------

### Mechanical specifications

Connection type	cable PVC , 2 m
Core cross-section	0.34 mm <sup>2</sup>
Housing material	brass, nickel-plated
Sensing face	PBT
Protection degree	IP67
Note	1) In the temperature range below 0 °C, permissible operating voltage $U_B$ 80...253 V Safety fuse $\leq 0.8$ A (quick-blow) according to IEC 60127-2 Sheet 1 Recommendation: after a short circuit, check that the device is functioning correctly.

### Compliance with standards and directives

Standard conformity	
Standards	EN 60947-5-2:2007 IEC 60947-5-2:2007

### Approvals and certificates

UL approval	cULus Listed, General Purpose
CSA approval	cCSAus Listed, General Purpose
CCC approval	Certified by China Compulsory Certification (CCC)