

Detail partie active

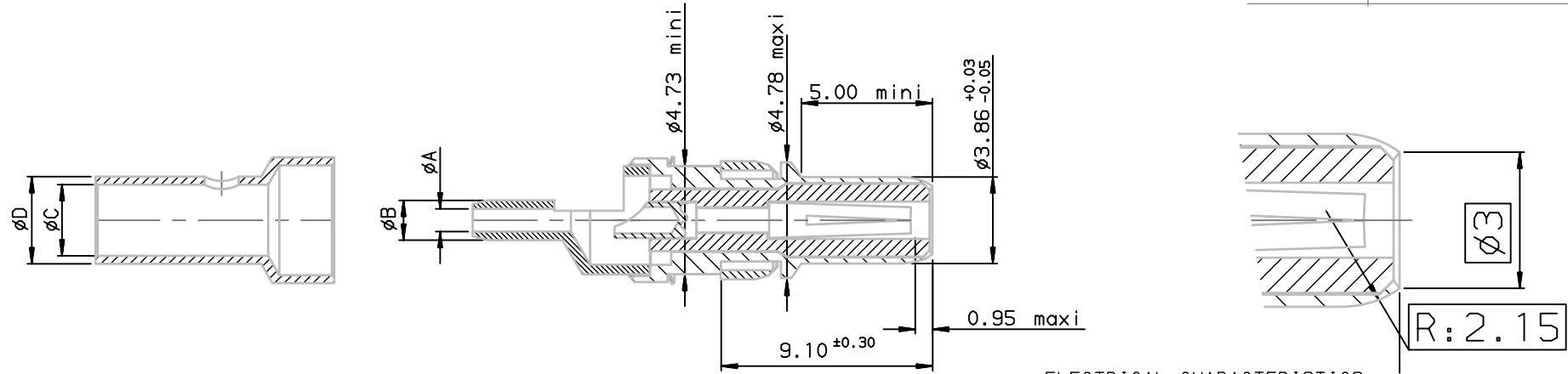

ELECTRICAL CHARACTERISTICS

- Impedance: 500HMS
- Working frequency: 1GHz max
- Dielectric with standing voltage: 600V
- Insulation resistance 5000: 14 OHMS
- Contact resistance ≤ 5 m OHMS
- Insertion lost: ≤ 0.2 dB

MECHANICAL CHARACTERISTICS

- Mating force per set of contact 0.4 N to 9 N
- Mating endurance 500
- Temperature -55° to +125 °C

TOOLING

- Coaxial contact extraction tool 8630-07A

DM 53740-5001 NCLF	Ct coax male sortie droite	1.70	2.46	3.13	3.84	RG 179 BU
Ref contact	Designation	$\phi A^{+0.10}_0$	$\phi B^{\pm 0.05}$	$\phi C^{+0.10}_0$	$\phi D^{\pm 0.10}$	Ref cable

Part number **DM537405001NCLF**

European Views

www.fciconnect.com		surface ISO 1302 ✓	tolerance std ISO 406 ISO 1101	projection mm	size A3	Scale 5
TOLERANCES UNLESS OTHERWISE SPECIFIED				ANGULAR 0.X ±0.1	LINEAR 0.XX ±0.1	ECN LS07-0001
Dr	PESSON	2005/10/14	0.XX' ±2°	0.XXX ±0.1	Product family D-SUB	Spec ref -
Eng	PESSON	2005/10/14	D-SUB Spec ref -			
Chr	LEGARE	2005/10/14	D-SUB Spec ref -			
Appr	LEGARE	2005/10/14	D-SUB Spec ref -			
FCI title MALE COAX CONTACT STRAIGT SOLDER TO CABLE		catalog no		dvg no C01-8639-2155		Rev. C
CUSTOMER		sheet 1 of 1				

NOTE:RoHS INFORMATIONS

- The "LF" product meets European union Directives and other country regulations as described in G5-22-008.
- The product is not intended to be exposed to a manufacturing solder process.
- Packaging spec: see G5-14-920.

rev	ecn no	dr	date
A	LS05-0086	MPE	2005/10/14
B	LS05-0107	MPE	2005/12/20
C	LS07-0001	LGO	2007/01/09
-	-	-	-
-	-	-	-
-	-	-	-

