

# Technical Diagrams

107 Electronic Installation Buzzer

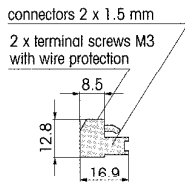

109 Electronic Installation Buzzer

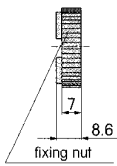
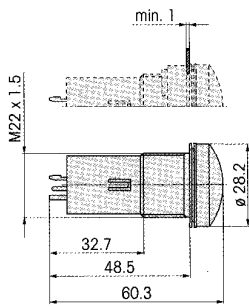
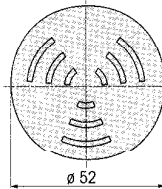
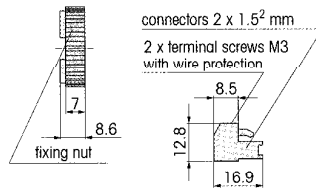
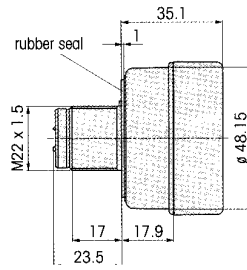

109/110 Special parts

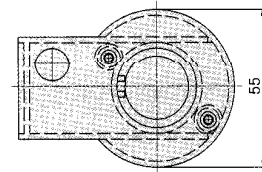
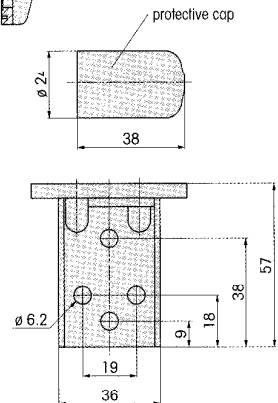
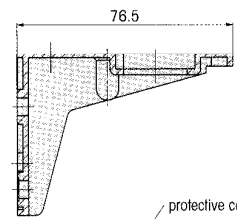

108 Electronic Buzzer

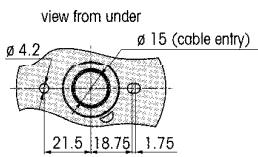
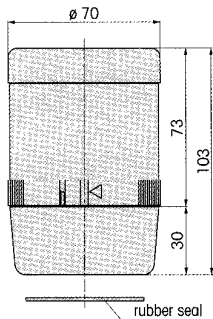

110 Electronic Buzzer

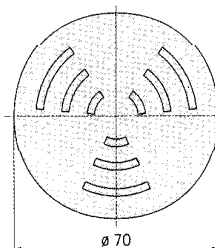
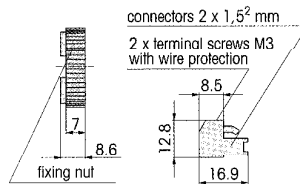
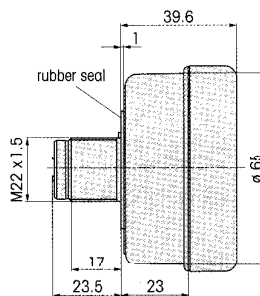

975 109 01

Bracket

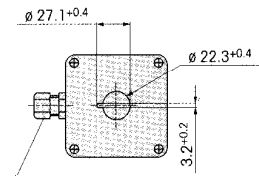
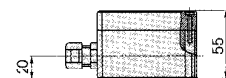
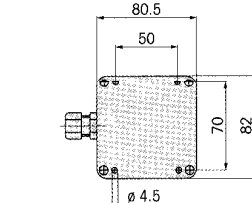

Cable gland M16 x 1.5  
(for cables with  $\varnothing$  5-10 mm)

975 109 02

Single surface housing

Special parts: see 840 Kombi/SIGN 70  
Pages 82 + 83

# Technical Diagrams

109/110 Special parts

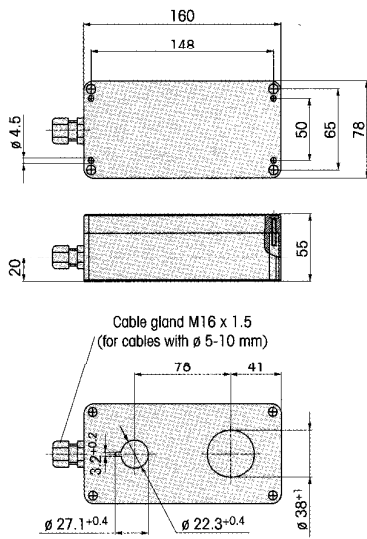

975 109 03 Double surface housing

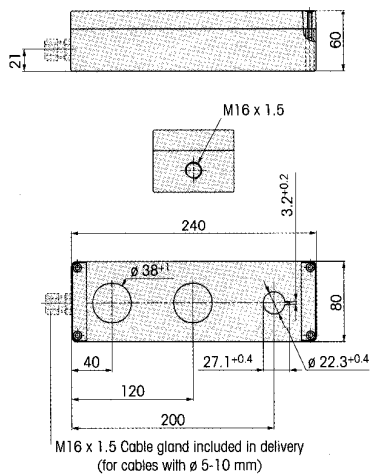

975 109 04 Triple surface housing

114 Electronic Installation Buzzer

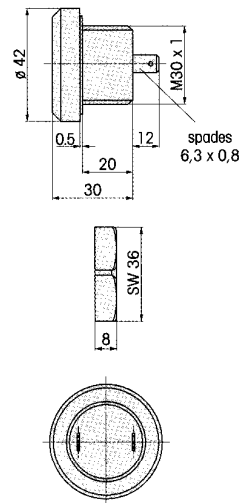

115 Buzzer/Light Combination

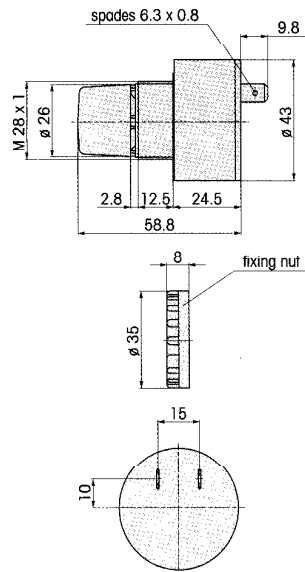

117 Electronic Installation Buzzer

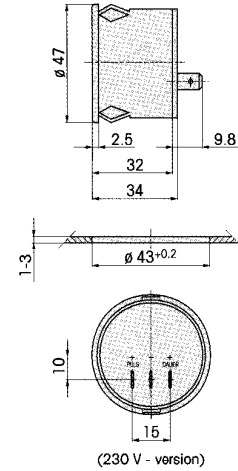

118/119 Electronic Installation Buzzer

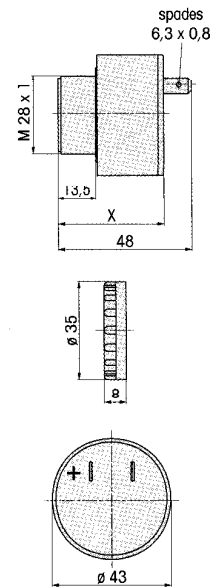

Measurement X:  
38 mm at U = 48 V to 230 V  
40 mm at U = 12 and 24 V

# Technical Diagrams

118 493/119 483 Electronic Buzzer 126

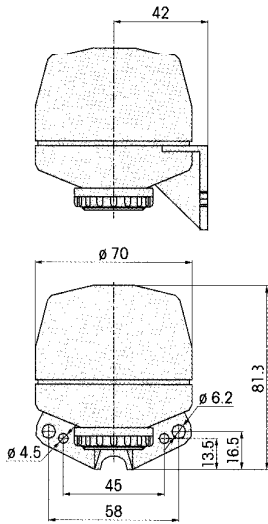

Electronic Sound Transmitter 130

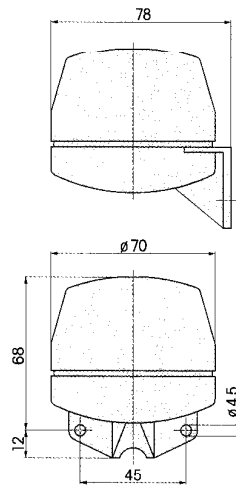

Electronic Sound Transmitter

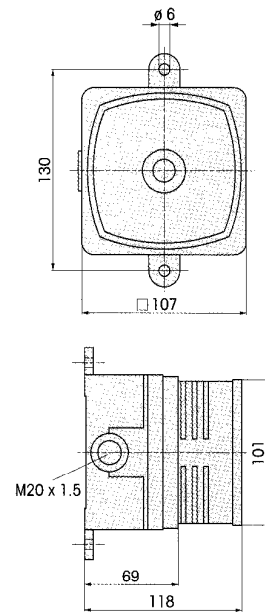

123 Electronic Siren

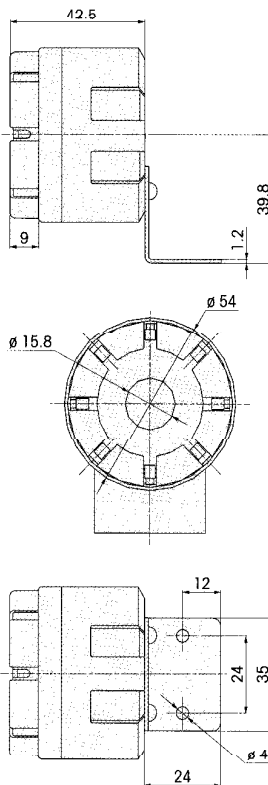

129 Electronic Sound Transmitter

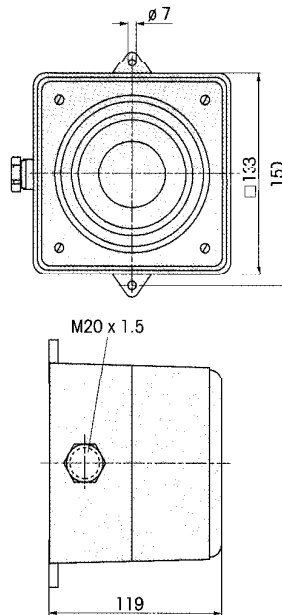

338 234 Installation Buzzer

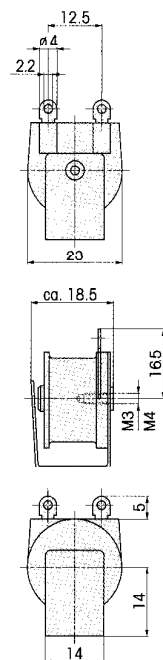

# Technical Diagrams

338 323

Installation Buzzer 382

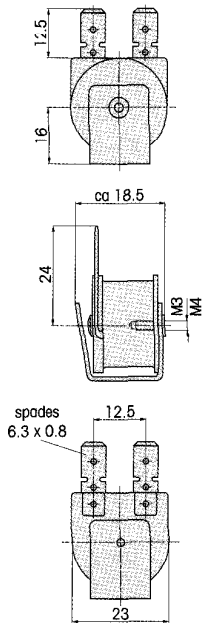

Installation Buzzer 481

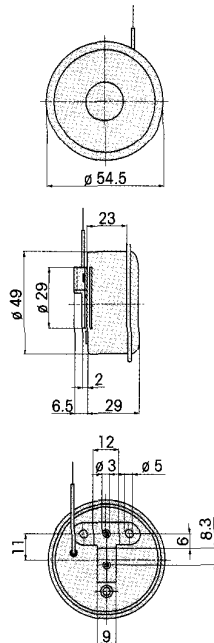

Flashing Light Buzzer

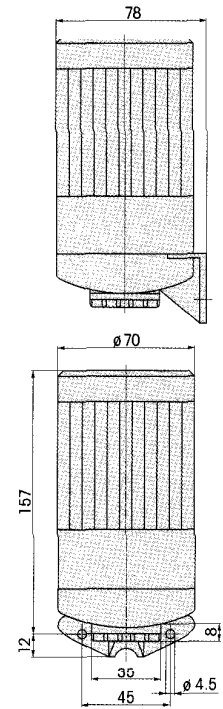

338 373

Installation Buzzer 480

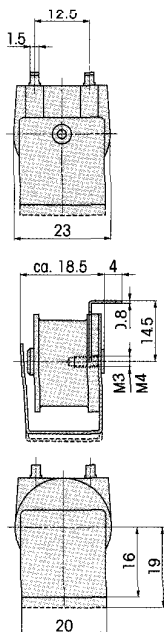

Buzzer/Light Combination

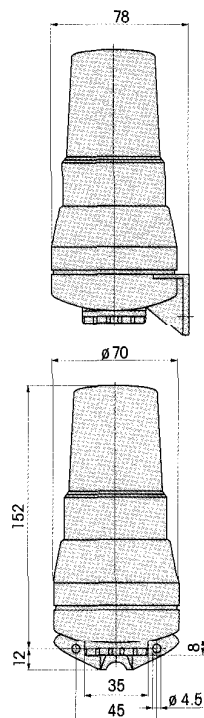

482

Signal Horn

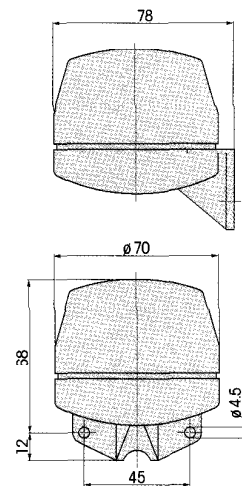

# Technical Diagrams

558

Signal Horn 571

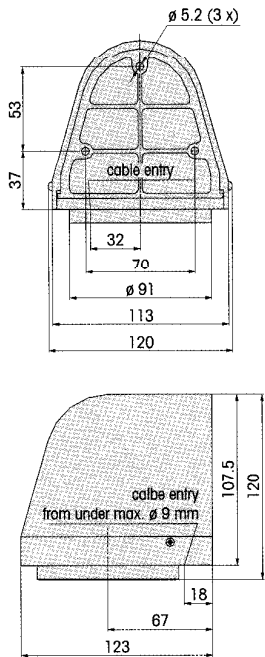

Signal Horn 580

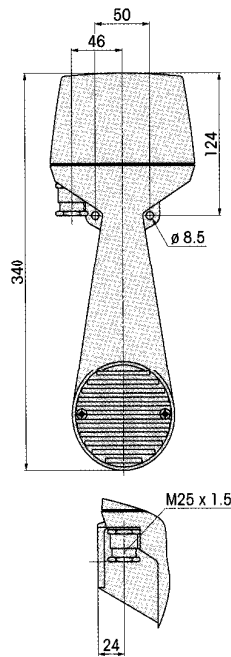

Warning Light Horn

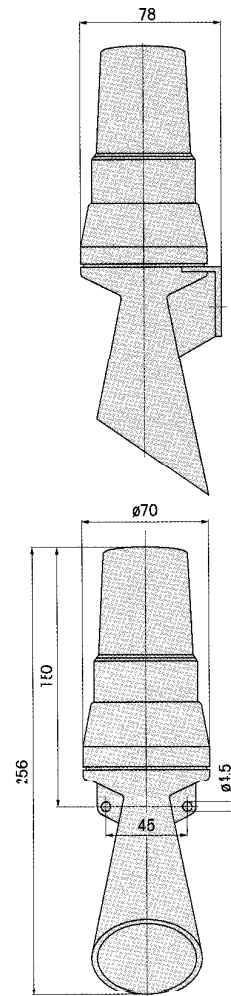

570

Signal Horn

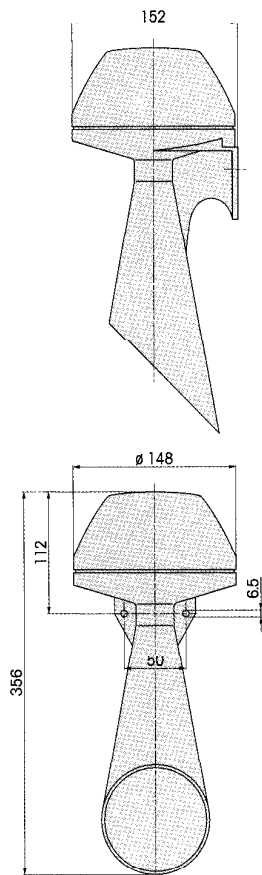

572

Signal Horn

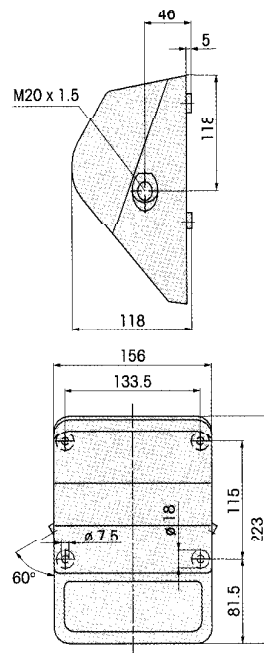

# Technical Diagrams

581

Flashing Light Buzzer

582

Signal Horn

730

EEx-Double Flash Beacon

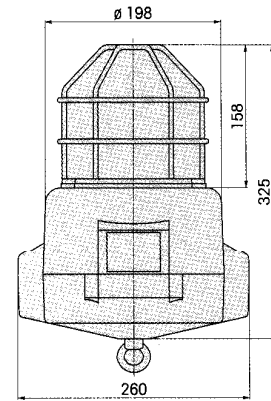
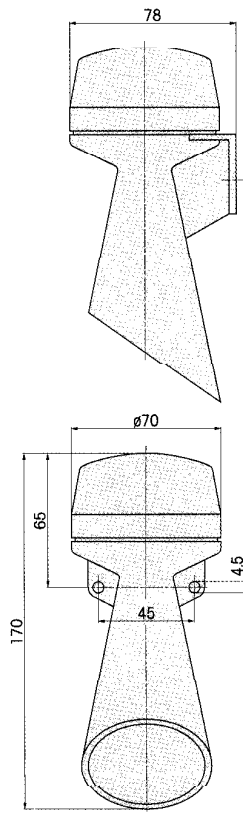
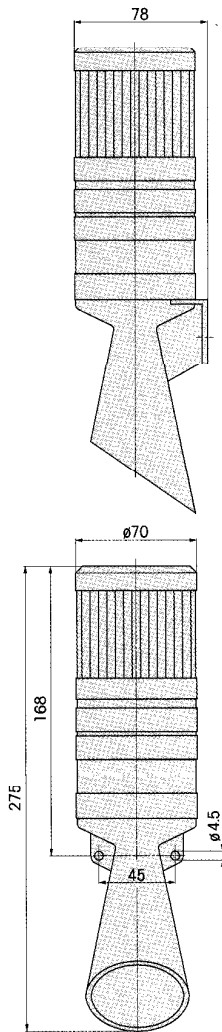

740

EEx-Warning Beacon

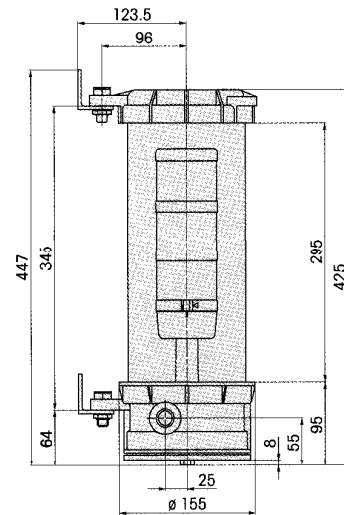

718

EEx-Electronic Buzzer

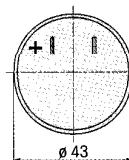
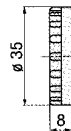
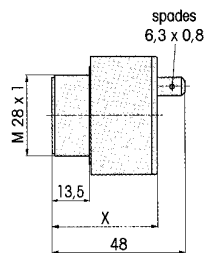

Measurement X:  
38 mm at U = 48 V to 230 V  
40 mm at U = 12 and 24 V

# Technical Diagrams

/58

EEx-Signal Horn

/60

EEx-Signal Horn

/90

EEx-Alarm Bell

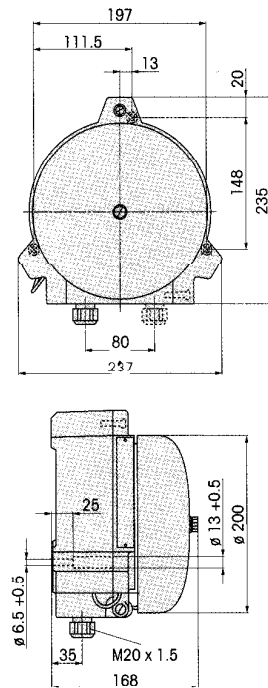
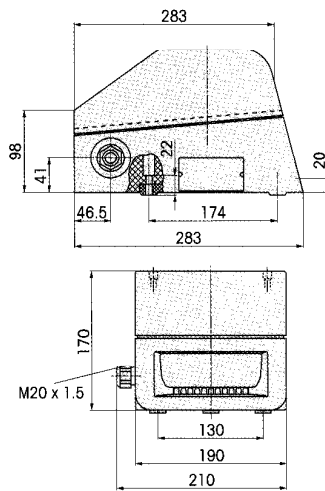
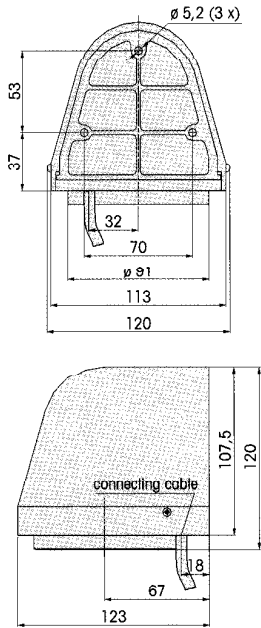

780

EEx-Rotating Signal Beacon

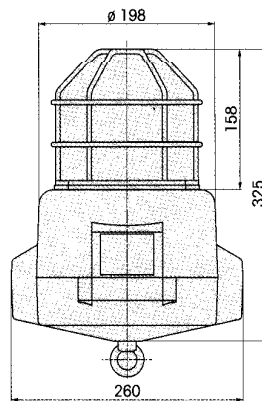

759

EEx-Signal Horn

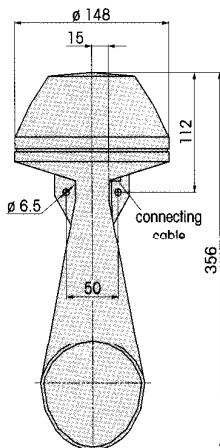
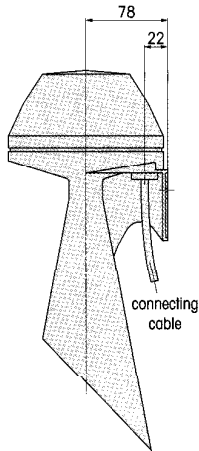

805/806/807 Perman./LED/Flash Beacon

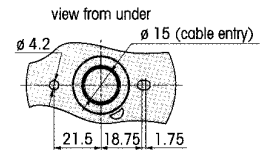
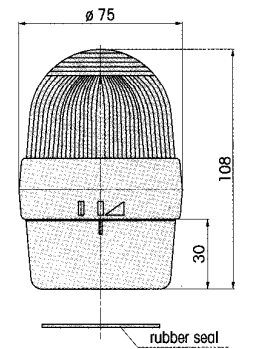

Special parts: see KombiSIGN 70  
Pages 82 + 83

# Technical Diagrams

806

Monitored LED 810

Display 815/816/817 Installation Signal Beacon

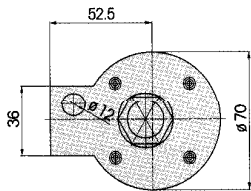
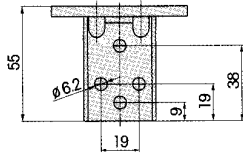
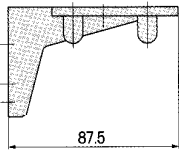
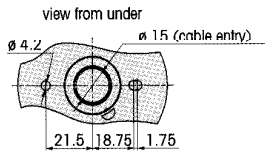
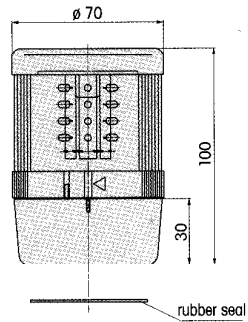

960 000 01

Bracket

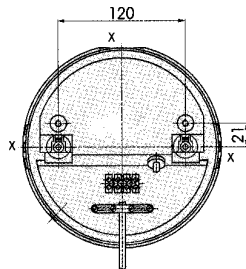
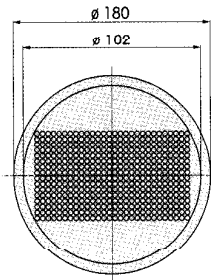

x cable end possible in 3 places

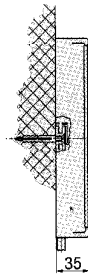

811

Display

815/816/817 Installation Signal Beacon

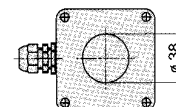
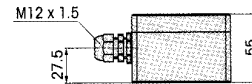
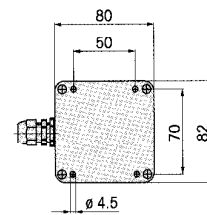
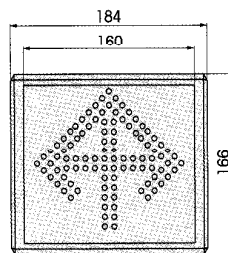
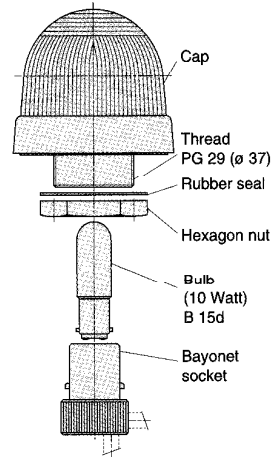
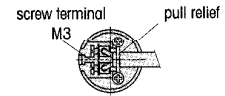
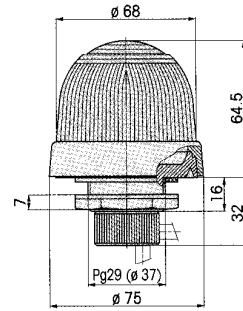

975 815 03

Single surface housing



# Technical Diagrams

815/816/817 Special parts

820

Flashing Beacon

826/827/828

Permanent/  
Blinking/Flashing Beacon

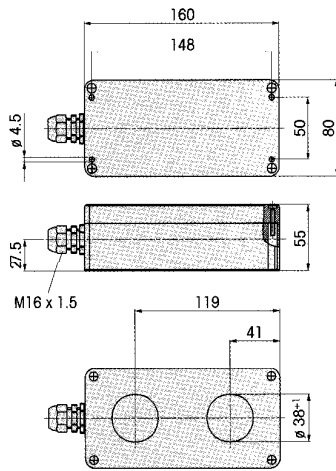

975 815 07 Double surface housing

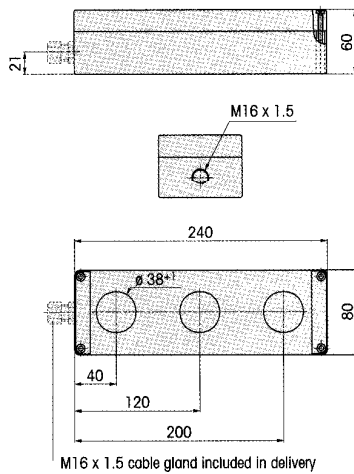

975 815 08 Triple surface housing

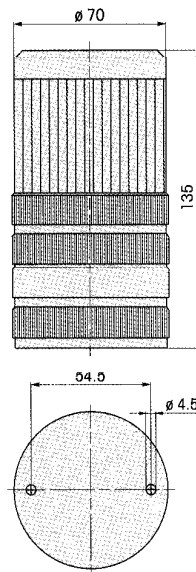

825

Flashing Beacon

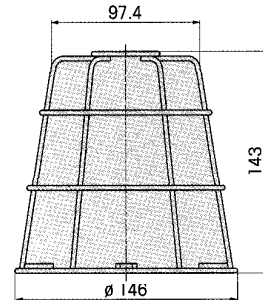
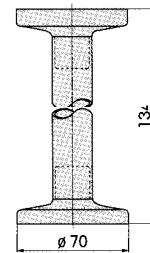
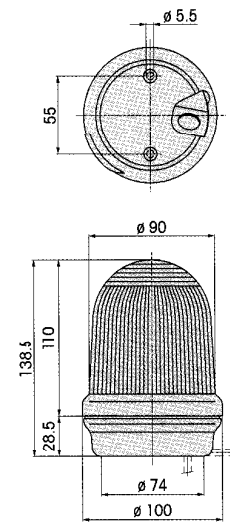
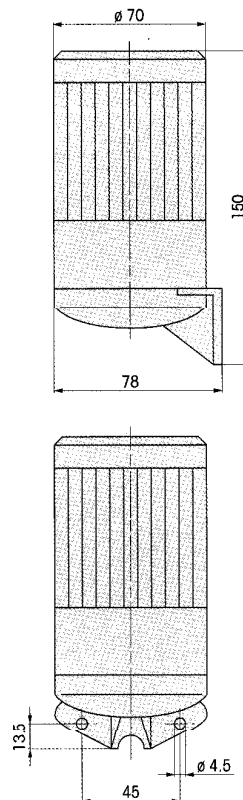

975 826 03

Wire guard

# Technical Diagrams

826/827/828 Special parts

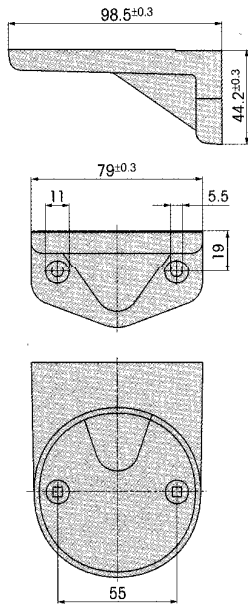

975 826 05 Bracket

826/827/828 Special parts

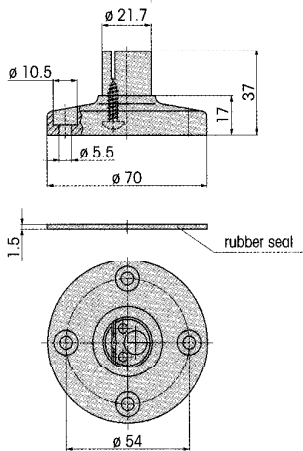

975 840 90 Base

830/834/835

Flashing Beacon

837

Double Flashing Beacon

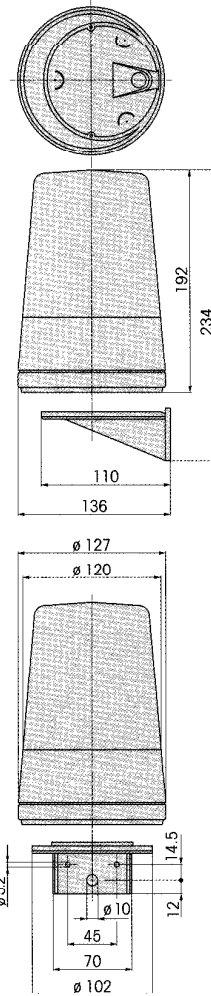
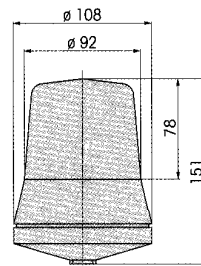
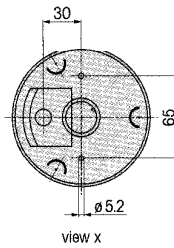
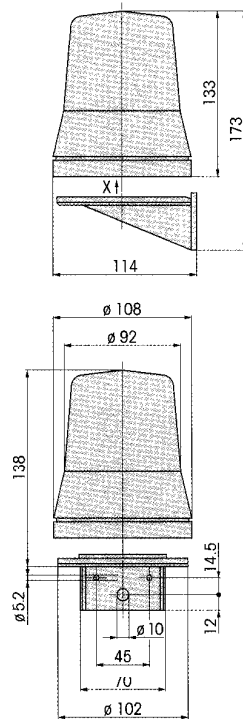

839

Double Flashing Beacon

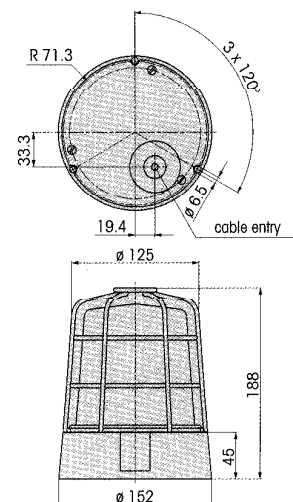

# Technical Diagrams

840

KombiSIGN 70

840

840 Special parts

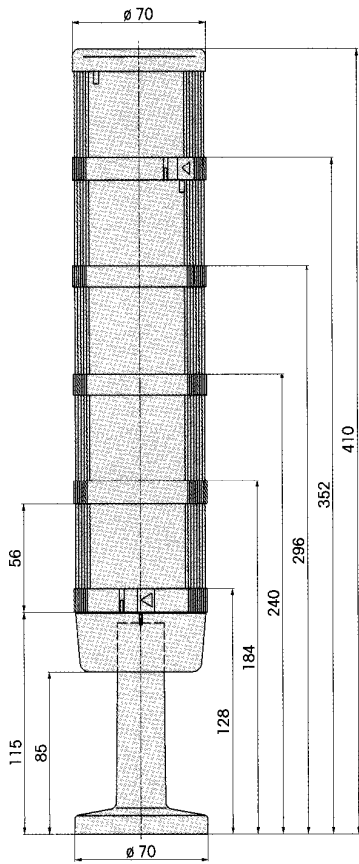

Connection plan

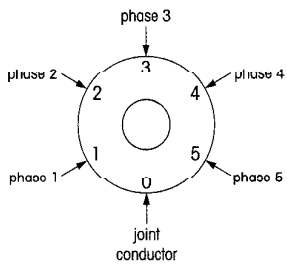

Connection plan AS-Interface element

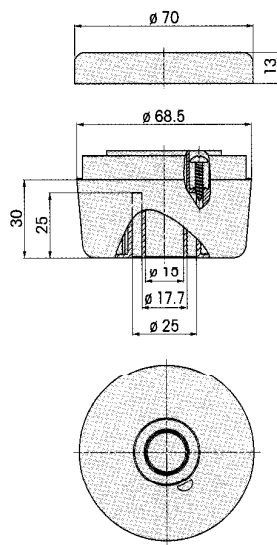
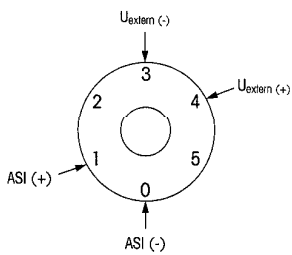

840 080 00 Terminal element

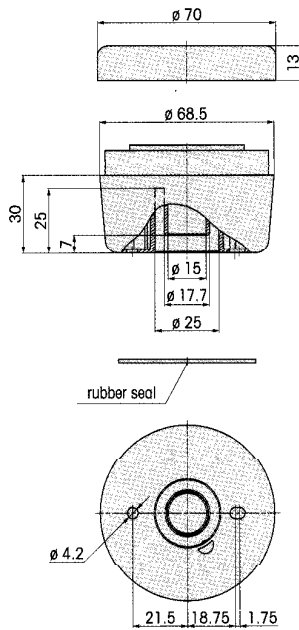

840 085 00 Terminal element

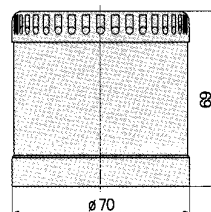

844 900 55 Vocal element

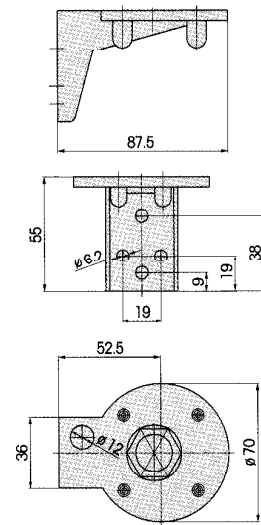

960 000 01 Bracket

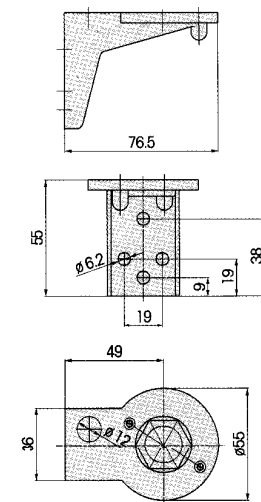

960 000 02 Bracket

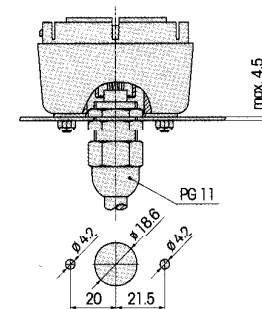

960 000 04 PG screw for base mounting

# Technical Diagrams

## 840 Special parts

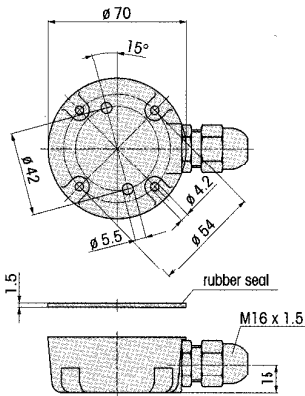

975 840 01 Adapter box

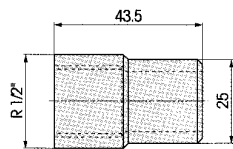

975 040 02 Adapter

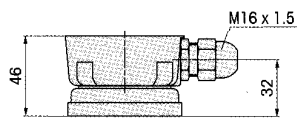

975 840 04 Adapter with magnetic base

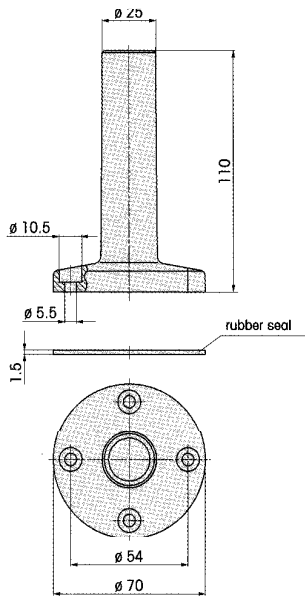

975 840 10 Base with tube

## 840 Special parts

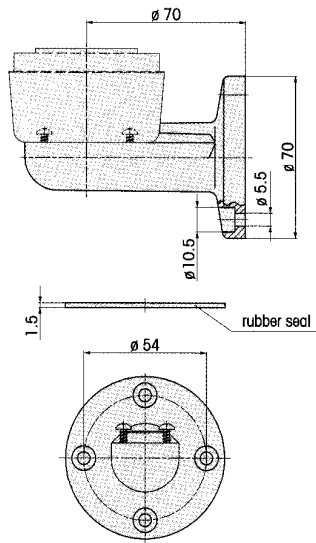

975 840 85 Bracket

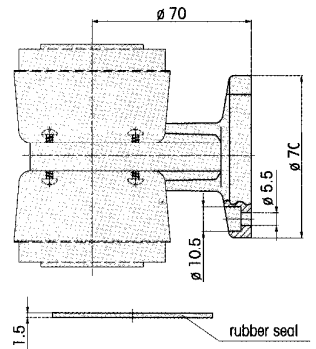

975 840 86 Bracket

## 840 Special parts

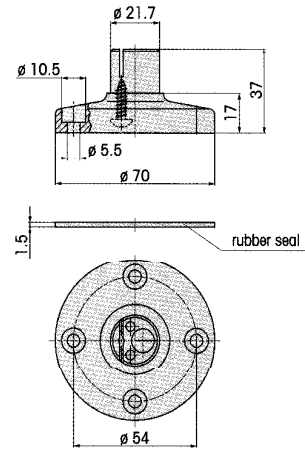

975 840 90 Base

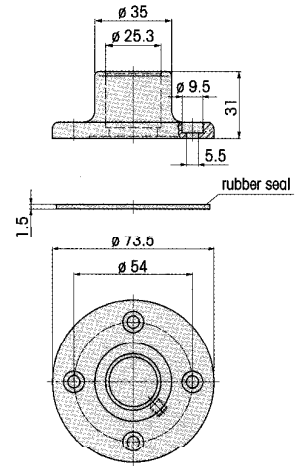

975 840 91 Base

# Technical Diagrams

845

KombiSIGN 50

845 Special parts

845 Special parts

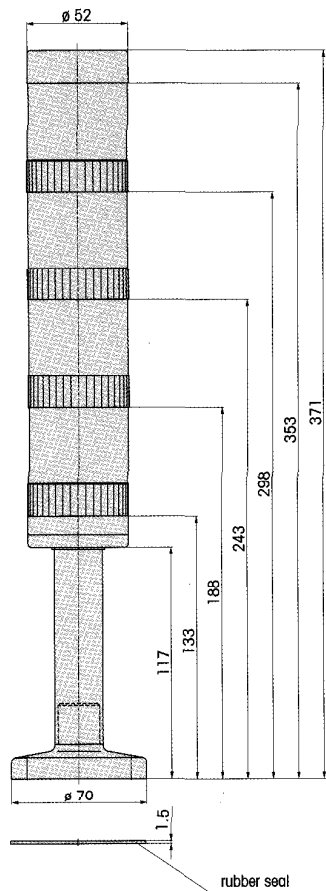

## Connection plan

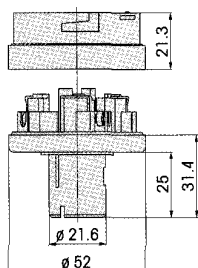
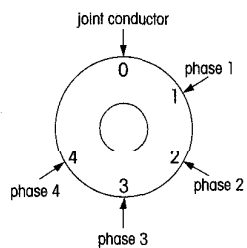

845 000 00

Terminal element

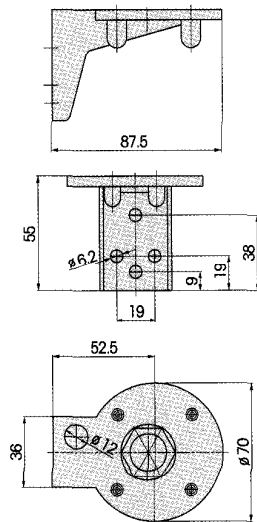

960 000 01

Bracket

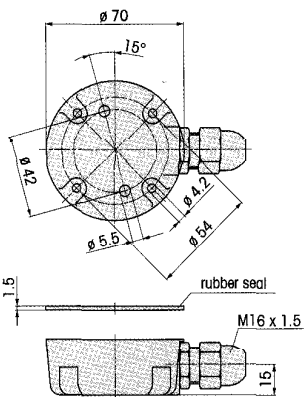

975 840 01

Adapter box

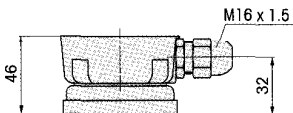

975 840 04

Adapter with magnetic base

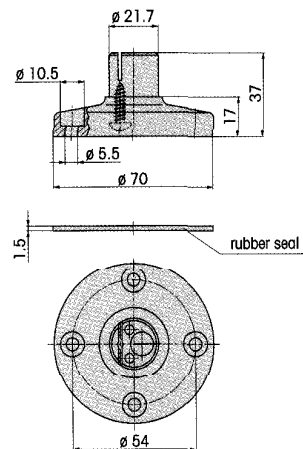

975 840 90

Base

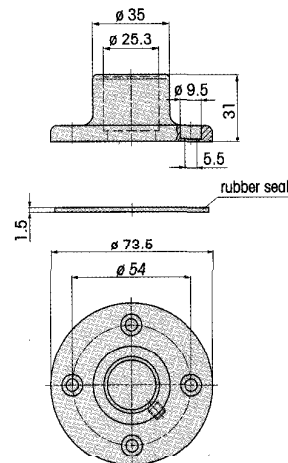

975 840 91

Base

# Technical Diagrams

845 Special parts

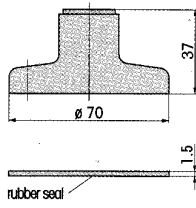

975 845 01

Base

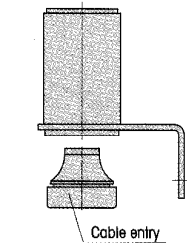
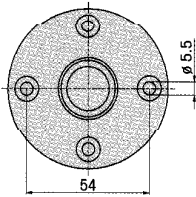

975 845 02

Bracket

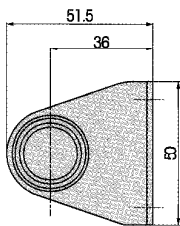
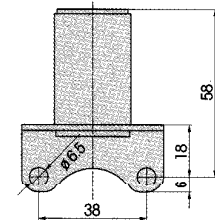

845 Special parts

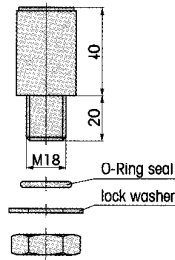

975 845 03

Adapter

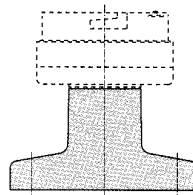

Base mounting

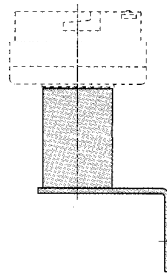

Bracket mounting

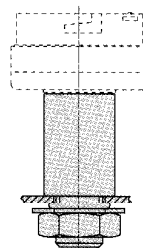

Single hole mounting

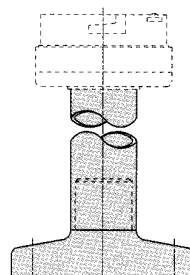

Tube mounting

850

Permanent Beacon

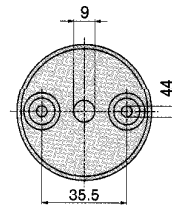
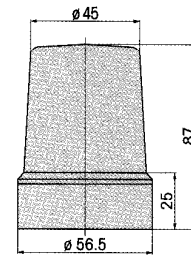

851

Permanent Beacon

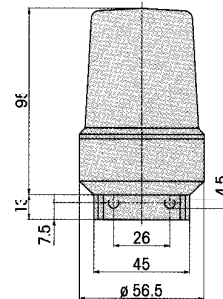
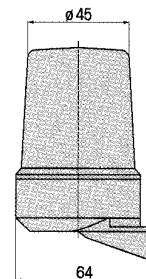

852

Permanent Beacon

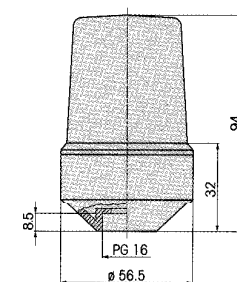

# Technical Diagrams

867/868/869

LED-Signal Tower 870

Permanent Beacon 880

Rotating Mirror Beacon

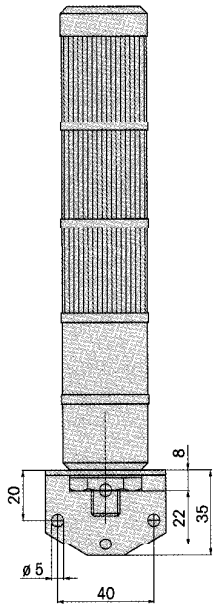
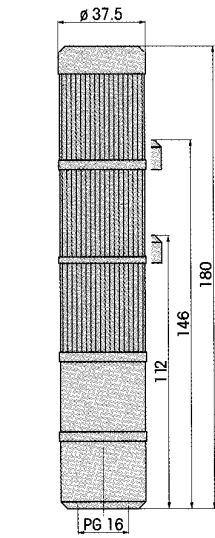

Connection plan

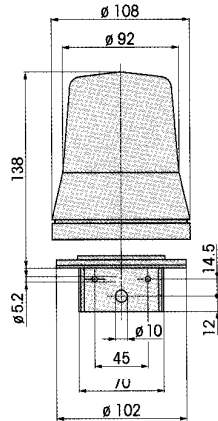
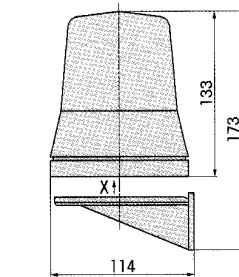
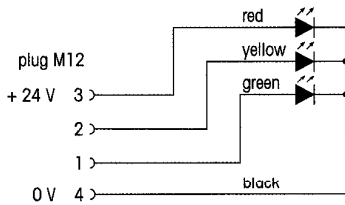

875

Blinking Beacon

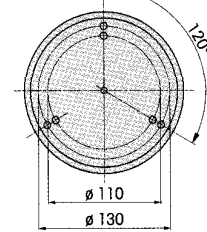
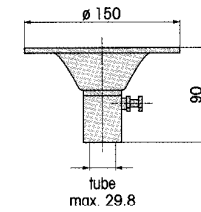
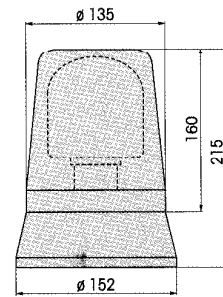
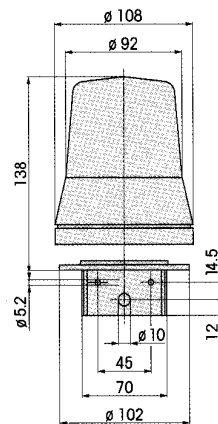
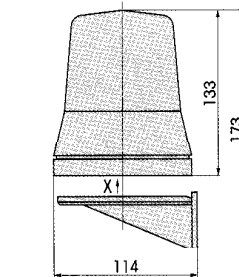

880 000 00 Flange for tube mounting

881

Rotating Mirror Beacon

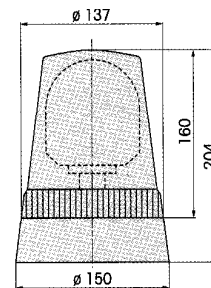

# Technical Diagrams

## 881 Special parts

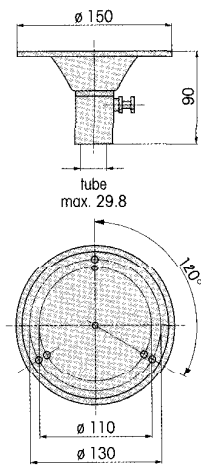

880 000 00 Flange for tube mounting

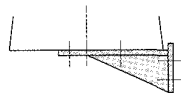

875 881 01

Winkel

## 883

### Rotating Mirror Beacon

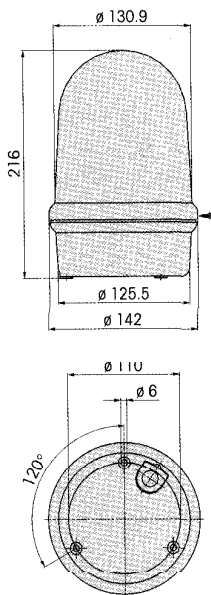

## 884

### Revolving Signal Beacon

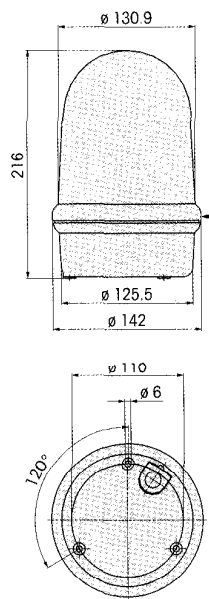

## 883/884 Special parts

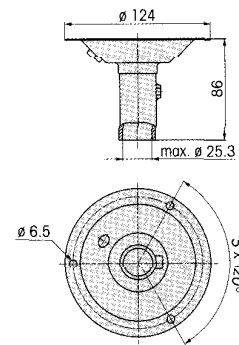

975 883 02 Flange for tube mounting

## 890

### Signal Beacon

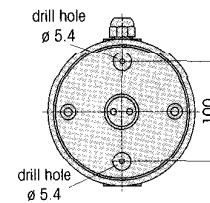
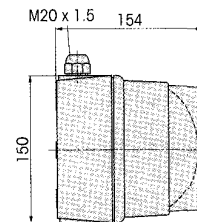

## 890

### Signal Beacon

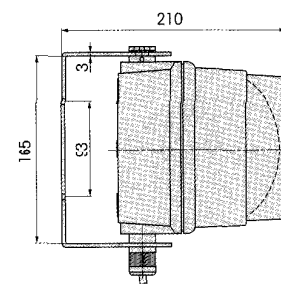

## 893/894 Special parts

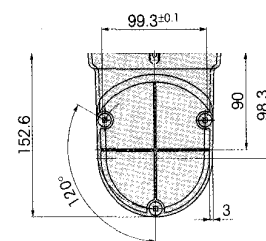
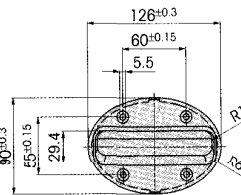
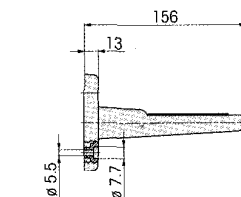

975 883 06

Bracket



# Technical Diagrams

890

Signal Beacon

896/898/899 Installation Signal Beacon 914

Alarm Bell

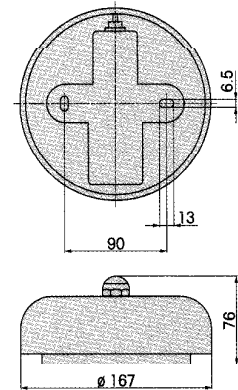
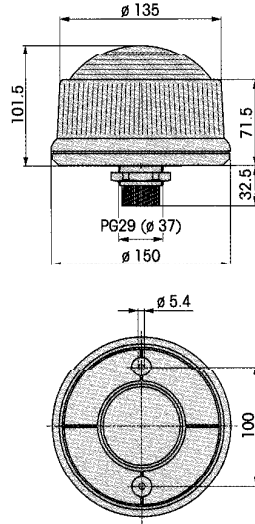
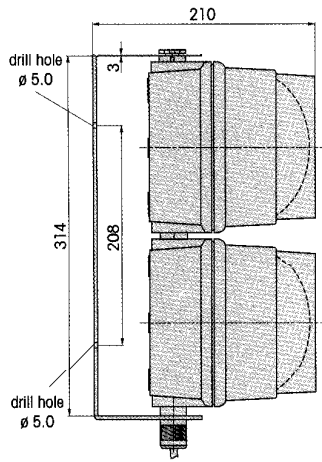

895

Signal Beacon

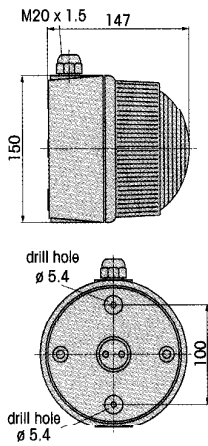

911

Alarm Bell

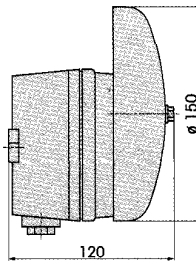

897

Flashing Beacon

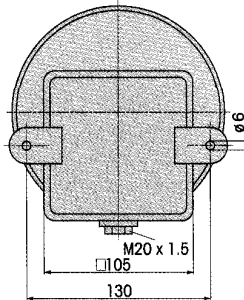
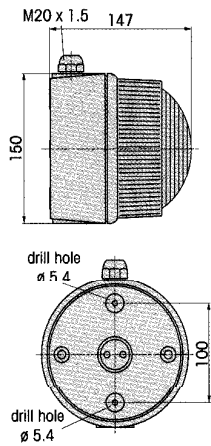

# Technical Diagrams Special Parts

880 000 00 Flange for tube mounting

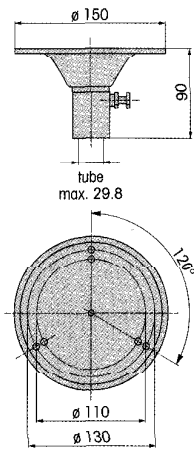

960 000 04

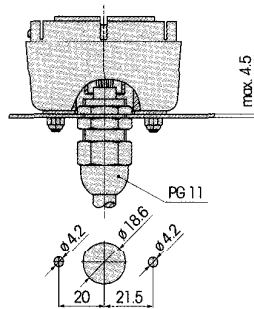

PG screw

975 109 02

Surface housing

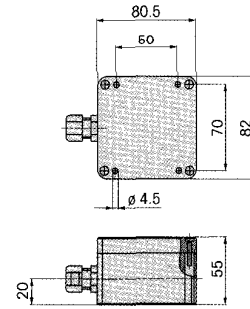

975 109 01

Bracket

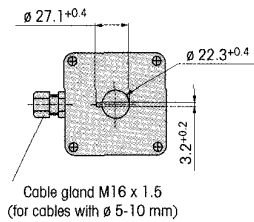
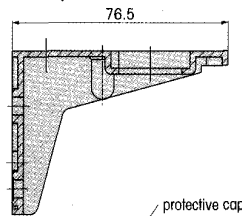

960 000 01

Bracket

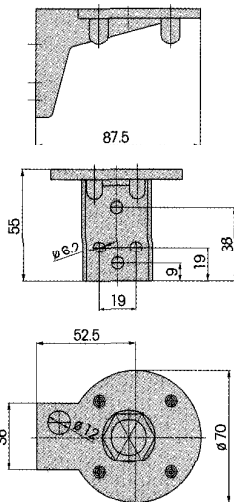

975 109 03

Surface housing

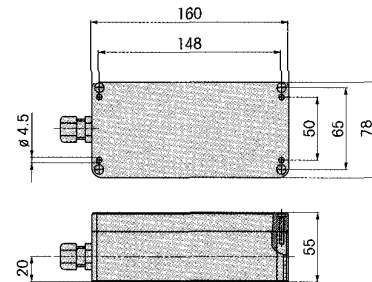

960 000 02

Bracket

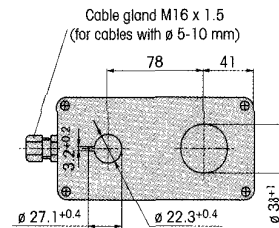
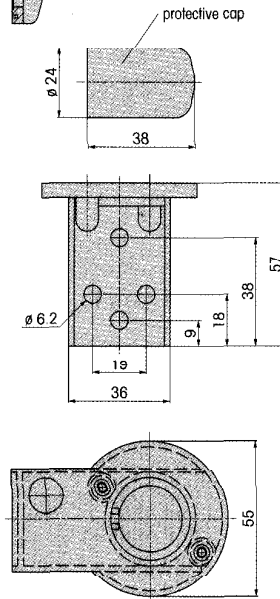
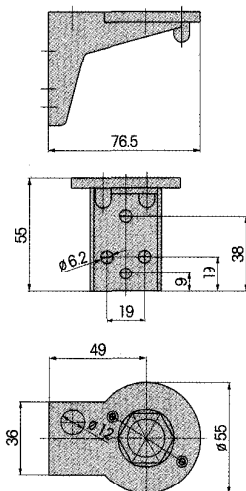

# Technical Diagrams Special Parts

975 109 04

Surface housing

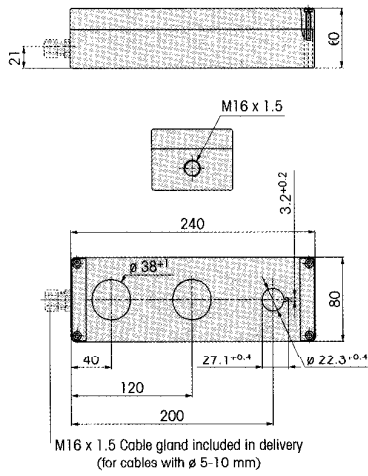

975 815 08

Triple surface housing

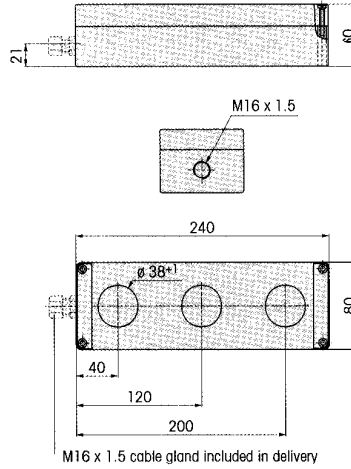

975 840 01

Adapter box

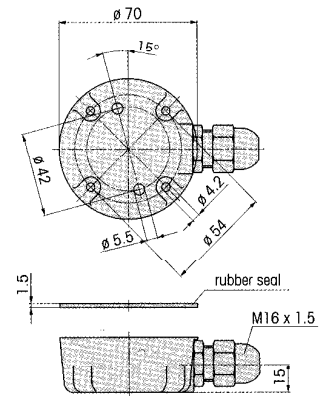

975 815 03

Single surface housing

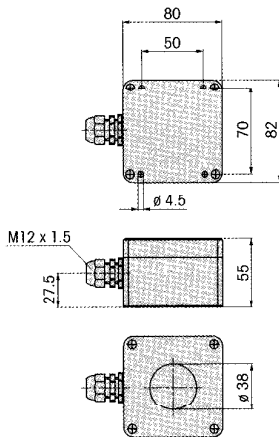

975 826 05

Bracket

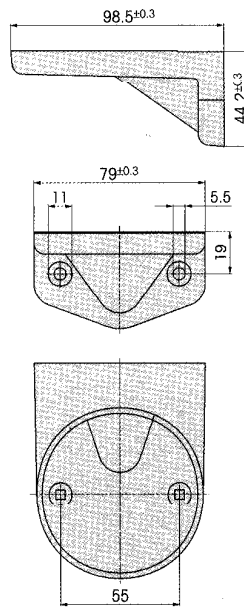

975 840 02

Adapter

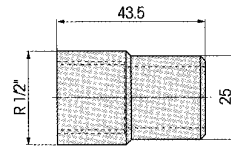

975 840 04 Adapter with magnetic base

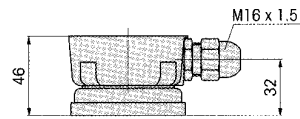

975 815 07

Double surface housing

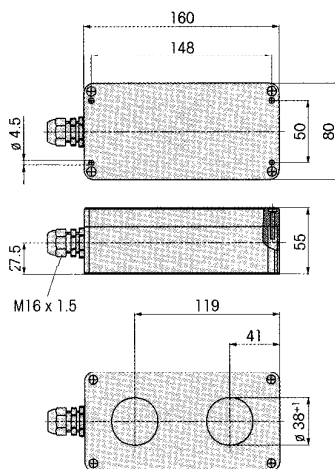

975 840 10

Base

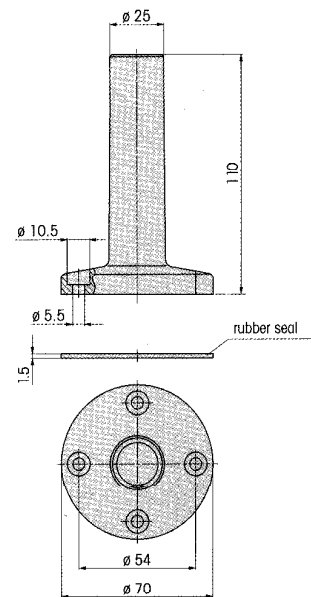

# Technical Diagrams Special Parts

975 840 85

Bracket

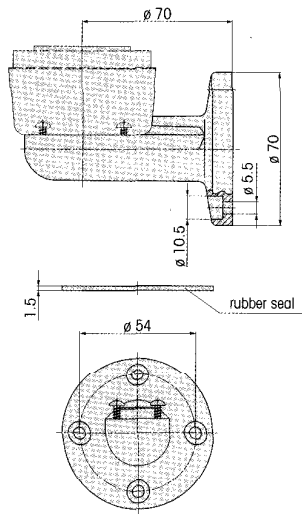

975 840 91

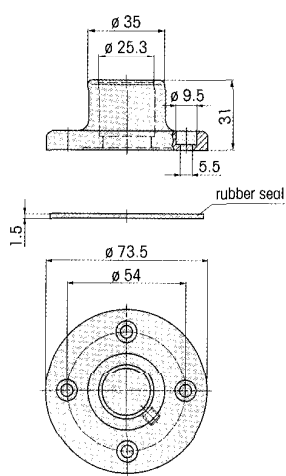

Base

975 845 03

Adapter

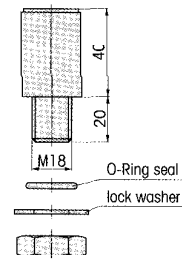

975 883 02 Flange to tube mounting

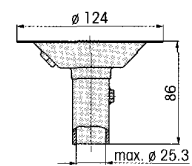

975 840 86

2-sided-bracket

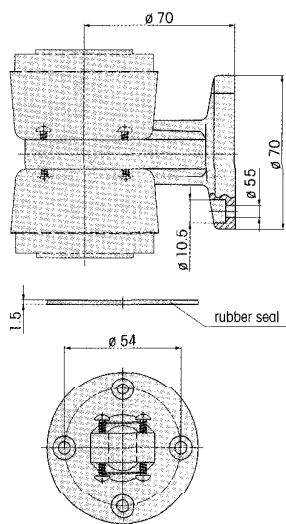

975 845 01

Base

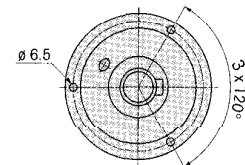
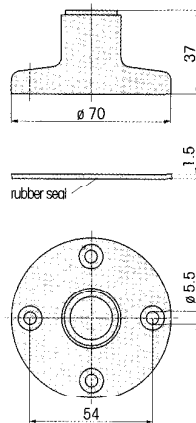

975 883 06

Bracket

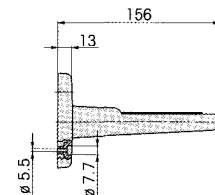

975 840 90

Base

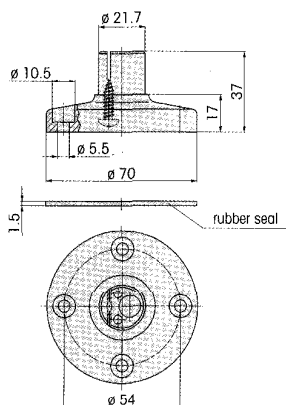

975 845 02

Bracket

