



**SCHROFF**

Project - 0 item(s)

**MY PROJECT LIST**

- [PRODUCTS](#)
- [APPLICATIONS](#)
- [INDUSTRIES](#)
- [NEW PRODUCTS](#)
- [CONFIGURATORS](#)
- Products ▾
- Search
- 

Home > Front Panel, anodized with untreated edges, unshielded, screw assembly



# Front Panel, anodized with untreated edges, unshielded, screw assembly

**SCHROFF**



**Catalog Number: 30818-273**

[Back To Product](#)

- Partial width front panel, Al, 2.5 mm
- Al, clear anodized, cut edges plain

**Note:**

Please order fixing material (sleeves, collar screws) separately, see Downloads-Mounting Hardware

**Specification:**

- IEC 60297-3-101
- IEEE 1101.1/10

**Material and Surface Finish:**

Al, Anodized, Untreated Edges

**Assembly:**

Screw on - Front Side

**EMC Shielding:**

Unshielded

**Type:**

Individual Components

**Individual Component Type:**

Front Panels

**Standard pack quantity (SPQ):**

Please take into consideration that deliveries may be carried out in the stated SPQs (SPQ, e.g. 5 pieces, 10 pieces, 50 pieces, etc.). Differing order quantities (e.g. 2 pieces) may be changed to the next possible delivery quantity = Standard Pack Quantity.



Other Views

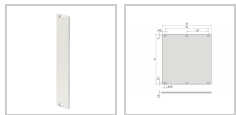

**Select product specifications before modifying or adding to project list or requesting a quote.**

Height-U-defining

Width-HP-defining

[Clear Selection](#)

Quantity

**Modify Product** ▶

**Add Item to Project List** +

**Documents**

Main Catalog - Front panels

**Links**

Mounting Hardware

Native CAD files

## Technical Data

<b>Height mm</b>	128.4
<b>Qty</b>	1 piece (SPQ 5)
<b>B mm</b>	20.0
<b>Thickness mm</b>	2.5
<b>Height U</b>	3
<b>Width HP</b>	4

## Delivery Comprises:

Item	Quantity	Description
1	1	Front panel, Al, 2.5 mm, anodised, cut edges plain

## Accessories

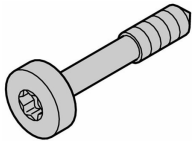

Collar screw, Torx (M2.5x12.3), steel black, PU 21101-783

[Add Item to Project List +](#)

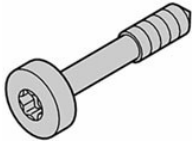

Collar screw, Torx (M2.5x12.3), steel nickel plated, PU 21101-782

[Add Item to Project List +](#)



Collar screw, cross recess/slotted (M2.5x12.3), steel nickel plated, PU 21101-101

[Add Item to Project List +](#)

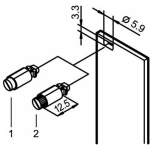

Quarter-turn fastener with knurled and slotted head, grey, PU 21101-849

[Add Item to Project List +](#)

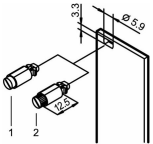

Quarter-turn fastener with slotted head, grey, PU 21101-847

[Add Item to Project List +](#)



Sleeve, brass, black, PU 21100-886

[Add Item to Project List +](#)



Sleeve, stainless steel, PU 21100-662

[Add Item to Project List +](#)



Sleeve, brass nickel-plated, PU 21100-660

[Add Item to Project List +](#)

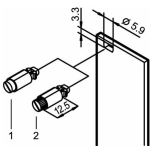

Quarter-turn fastener with knurled and slotted head, black, PU 21101-850

[Add Item to Project List +](#)

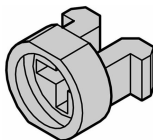

Sleeve, plastic, grey, PU 21100-464

[Add Item to Project List +](#)



Collar screw, cross recess/slotted (M2.5x12.3), steel black, PU 21101-102

[Add Item to Project List +](#)

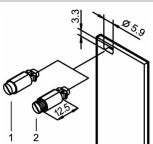

Quarter-turn fastener with slotted head, black, PU 21101-848

[Add Item to Project List +](#)

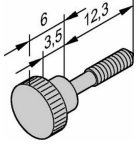

Collar screw, knurled head short (M2.5x12.3),  
brass nickel plated, PU 100 pcs

21101-  
749

[Add Item to Project List +](#)

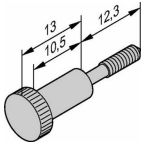

Collar screw, knurled head long for LD  
(M2.5x12.3), brass nickel plated, PU 100 pcs

21101-  
909

[Add Item to Project List +](#)

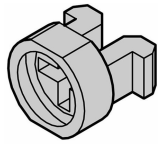

Sleeve, plastic, black, PU 100 pcs

21100-  
591

[Add Item to Project List +](#)

## EXPLORE

[About Us](#)  
[Services & Capabilities](#)  
[News & Events](#)  
[Newsletter Subscriptions](#)  
[Strategic Partnerships](#)  
[Investor Relations](#)

## CONTACT

[Customer Service](#)  
[Find a Sales Office or Distributor](#)  
[Global Locations](#)  
[Product Compliance & Certifications](#)  
[Partner Login](#)

## DOWNLOAD

[Download Center](#)  
[Reference Projects](#)  
[Videos](#)  
[Product Configurators](#)  
[Warranties and Terms of Sale & Procurement](#)

© 2018 nVent. All rights reserved | [Privacy Policy](#) | [Terms of Use](#) | [Cookie Policy](#) | [Imprint](#) | [Site Map](#)

## Connect With Us

