

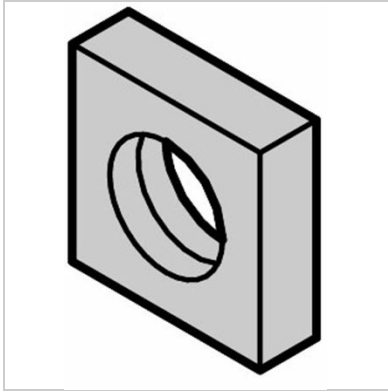

Square nut



Catalog Number: 21100-359

[Back To Product](#)

- Nut
- Square nut for handle mounting
- Nut is inserted into the handles; the handle is fastened by the bolt through the front panel

Accessories:

Nut

Type:

Individual Components

Accessory type:

Hardware - Screw, Nuts & Washers

Description:

DIN 562, M2.5,St, nickel-plated

Product family:

- RatiopacPRO
- PropacPRO
- EuropacPRO
- CompacPRO
- Inpac
- Frame Type Plug-In Units



Other Views

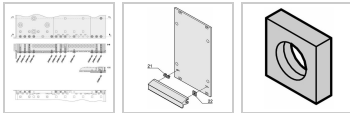

Select product specifications before modifying or adding to project list or requesting a quote.

Type

[Clear Selection](#)

* Country / Region

Quantity

[Add Item to Project List +](#)

Documents

User manual

Links

Native CAD files

Technical Data

Material	St, nickel plated
Dimension [mm]	M2,5
Qty	PU 100 pieces
Material	Nickel-plated steel
Item	22
Description	Square nut
Application	Assembly of handle on front panel

Accessories

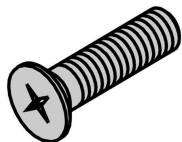

Countersunk screw, cross recess (M2.5x12), steel nickel plated, Pu 100 pcs

21100-507

[Add Item to Project List +](#)

[Services & Capabilities](#)

[News & Events](#)

[Newsletter Subscriptions](#)

[Strategic Partnerships](#)

[Investor Relations](#)

[Find a Sales Office or Distributor](#)

[Global Locations](#)

[Product Compliance & Certifications](#)

[Partner Login](#)

[Reference Projects](#)

[Videos](#)

[Product Configurators](#)

[Warranties and Terms of Sale & Procurement](#)

© 2020 nVent. All rights reserved | [Privacy Policy](#) | [Terms of Use](#) | [Cookie Policy](#) | [Imprint](#) | [Site Map](#)

Connect With Us

