

DELPHI PACKARD ELECTRIC SYSTEMS  
WARREN, OHIO 44486

DWG STATUS				REVISION HISTORY				AUTH		
DATE	STG	REV	CHG	N/P	ZONE	DATE	BY	CHK	APVD	LEG
17JAO2	R	003	-	-						
MATERIAL SPEC WAS PAG						217Z51			LEG RC	

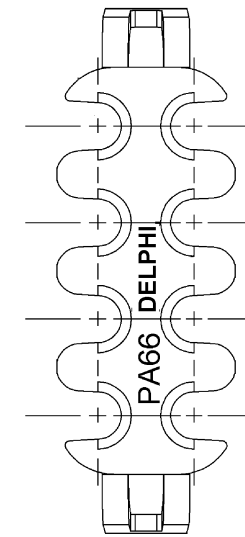
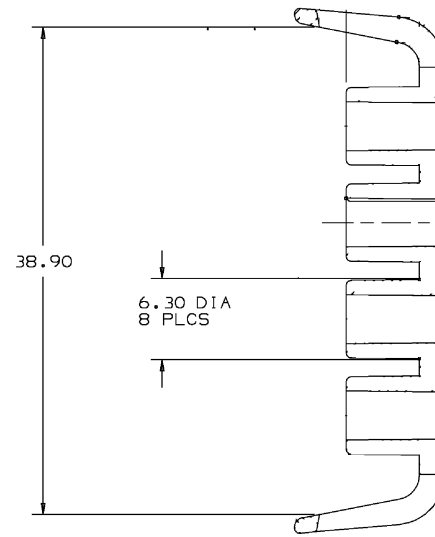
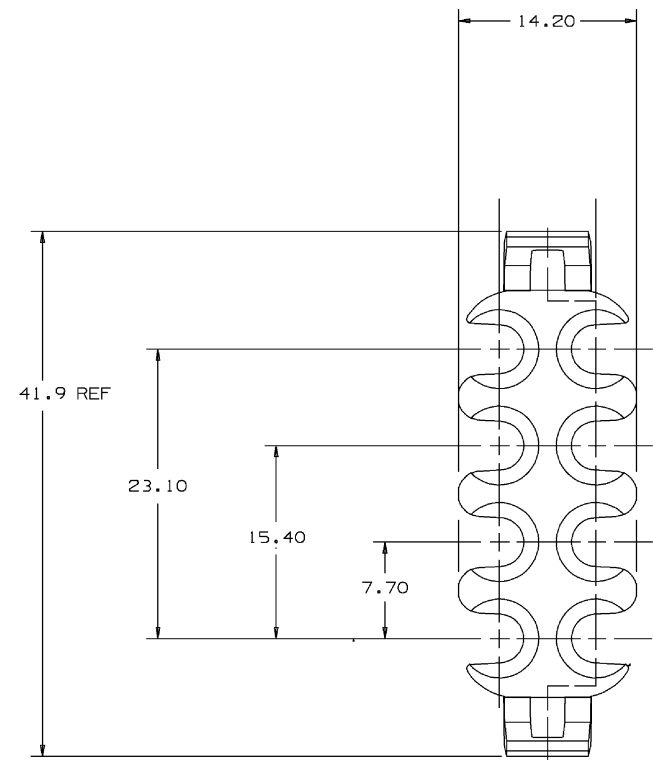
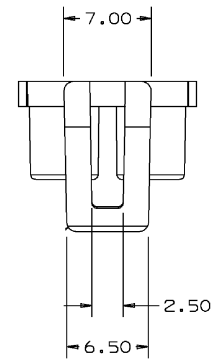

- NOTES**
- ALL RADII 0.40, UNLESS OTHERWISE INDICATED.
  - DIMENSIONS ARE TO FACE OF VIEW SHOWN, UNLESS OTHERWISE INDICATED.
  - 1\* DRAFT ON ALL INSIDE AND OUTSIDE SURFACES, UNLESS OTHERWISE INDICATED.
  - THIS PART IS TO MATE WITH CONNECTOR 12146509.
  - THIS PART IS NOT CONTROLLED FOR AUTOMATIC FEEDING.
  - MATERIAL RECYCLING CODE >PA66< PER SAE J1344. (2.3)X(0.1) RAISED CHARACTERS AS SHOWN TO BE LOCATED ON ANY EXTERIOR SURFACE. OPTIONAL CONSTRUCTION TO BE NO MATERIAL RECYCLING CODE.
  - (2.3)X(0.1) RAISED DELPHI CORPORATE BRAND TO BE LOCATED ON ANY EXTERIOR SURFACE, PREFERABLY VISIBLE AT FINAL ASSEMBLY. OPTIONAL CONSTRUCTION TO BE "PED" OR NO LOGO.

<b>DELPHI</b> Automotive Systems			
MATERIAL SPEC M3592008-PA66 HS IM BLU		TOLERANCE UNLESS OTHERWISE SPECIFIED DIMENSIONS HOLE PLACES 1:3:3 THICKNESS	
SUBSTANCES OF CONCERN AND RECYCLED CONTENT PER DELPHI - A 10949001			
PART DRAWING		DISTR CODE	
CODE NUMBER 6900	DWG DATE 03AP92	SCALE 4:1	
DC SPEC	STYLE		
PART GEOMETRY 2D PLANAR	UNLESS OTHERWISE SPECIFIED: THIS DOCUMENT IS IN ACCORDANCE WITH ASME Y14.5M - 1994 AS AMENDED BY THE 0M GLOBAL DIMENSIONING AND TOLERANCING HANDBOOK - 1997. ALL GEOMETRIC TOLERANCES AND RELATED DATUMS APPLY. RULE #1 (PERFECT FORM AT MMC) DOES NOT APPLY WHEN RELATIONSHIP BETWEEN FEATURES IS ESTABLISHED BY ORIENTATION OR LOCATION TOLERANCES. SEPARATE POSITION CALLOUTS MAY BE GAGED SEPARATELY REGARDLESS OF DATUM REFERENCES.		
CHANGE RESTRICTED NO MANUAL CHANGES	REFERENCE	DR T DIETERLE	DATE
DO NOT SCALE		APVD1 T STEELE	18AP93
		APVD2 T STEELE	18AP93
		APVD3 G PENNYWELL	05MY93
		APVD4	
		APVD5	
METRIC UNLESS OTHERWISE SPECIFIED ALL DIMENSIONS ARE IN MILLIMETERS	DRAWING NAME TPA M/P 280		
SHEET NUMBER 1 OF 1	DRAWING NUMBER 12146443	DWG STATUS R 003	SIZE AO

# Mouser Electronics

Authorized Distributor

Click to View Pricing, Inventory, Delivery & Lifecycle Information:

[Aptiv:](#)

[12146443](#)