

C-170002

PRINT FIRST
DIM : 1:1 DIMENSIONS IN MM, DO NOT SCALE PRINT

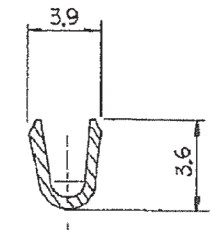

SECT. A-A

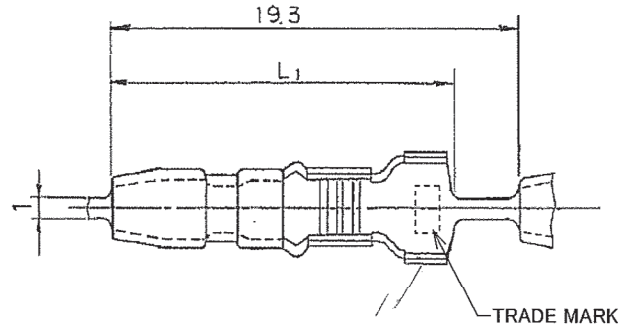
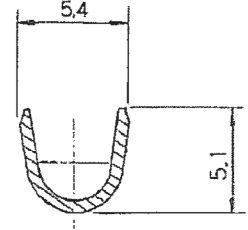

SECT. B-B

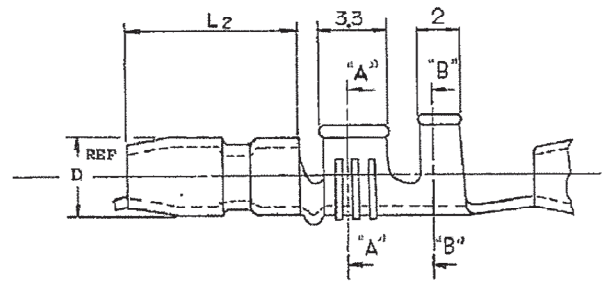

NOTE
 △ THESE ITEMS ARE FOR USE OTHER THAN IN JAPAN.
 △ GENERAL TOLERANCES; ±0.4
 △ OBSOLETE PARTS: OBSOLETE CIS STREAMLINING PER D.RENAUD/D.SINISI

注記
 △ 海外向け製品。
 △ 一般公差; ±0.4

△	OBSOLETE	170002-8	17.0	8.7	4.0	7000	108-5003	BRASS	0.5F	PRE-TIN
	OBSOLETE	3-170002-4	17.0	8.7	4.0	15000	108-5003	PHOS-BZ	0.5F	POST-TIN
	OBSOLETE	3-1-3	17.0	8.7	4.0	15000	-5003			
	OBSOLETE	3-2	15.8	7.3	3.5	15000	-5004			POST-TIN
	OBSOLETE	3-1	15.8	7.3	3.5	15000	-5004	PHOS-BZ	0.5F	
	OBSOLETE	2-5	17.0	8.7	4.0	20000	-5003	BRASS	0.5F	
	△	1-7	15.8	7.3	3.5	25000	-5004			
	OBSOLETE	1-6	17.0	8.7	4.0	25000	-5003			
	OBSOLETE	1-5	17.0	8.7	4.0	25000	-5003			
	OBSOLETE	1-4	17.0	8.7	4.0	20000	-5003			POST-TIN
	△	1-2	15.8	7.3	3.5	20000	-5004			POST-TIN
	△	1-1	15.8	7.3	3.5	20000	-5004			
		7	17.0	8.7	4.0	7000	-5004			
		5	17.0	8.7	4.0	5000	-5003			
		4	17.0	8.7	4.0	7000	-5003			POST-TIN
		170002-2	15.8	7.3	3.5	7000	108-5004	BRASS	0.5F	POST-TIN

PART NO.	LOOSE	PCS NO	L1 DIM	L2 DIM	D DIM	QTY/REEL	PROD SPEC NO.	MATERIAL	FINISH
TE Connectivity									
WIRE RANGE		INSULATION DIA.		NAME					
25-27 AWG		2.5-3.8 mm		シエアプラグ SHUR PLUG					
MATERIAL		FINISH		SIZE LOC # (NO)					
SEE TABLE		SEE TABLE		C J C-170002					
L1		L2		D		REV.		SHEET	
R3		R2		R3		R3		1-1	

R3	REVISED PER ECR-19-012286	PC	TD	20SEP19
R2	REVISED PER ECO-11-005030	RK	HMR	22MAR11
L1	REVISED PER ECO-11-005030	DR	CHK	DATE

Mouser Electronics

Authorized Distributor

Click to View Pricing, Inventory, Delivery & Lifecycle Information:

[TE Connectivity:](#)

[170002-5](#)