

2		1					
LOC	DIST	REVISIONS					
CM	53	P	LTR	DESCRIPTION	DATE	DWN	APVD
			E	REVISED PER EC 063B-0530-02	01-MAY-03	KW	CJ

1 CIRCUIT 1 IDENTIFIER, LOCATED APPROXIMATELY AS SHOWN.

2 LAST CIRCUIT IDENTIFIER, LOCATED APPROXIMATELY AS SHOWN.

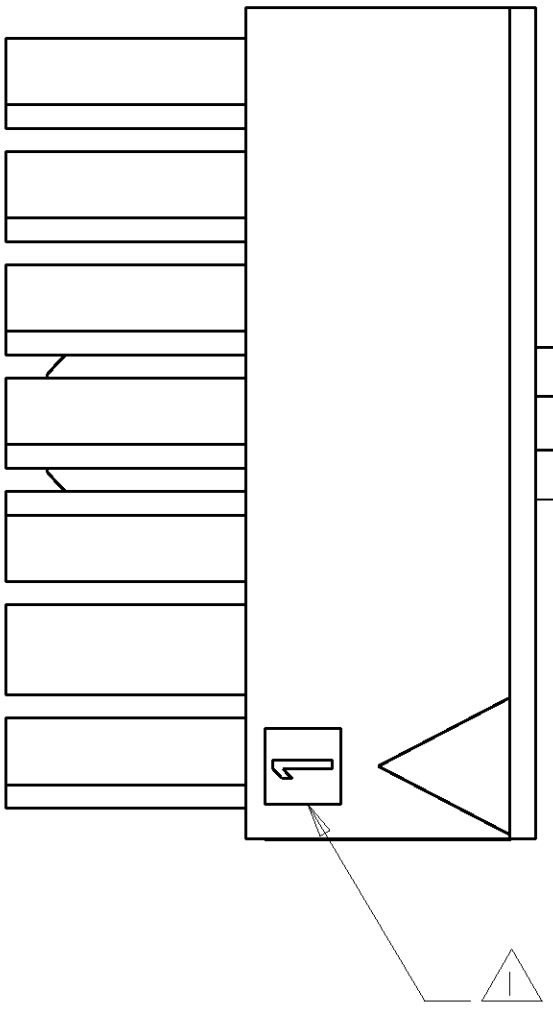
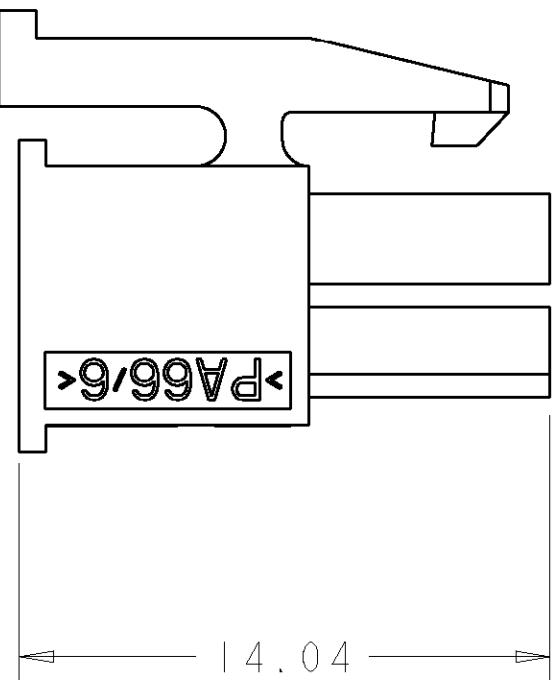
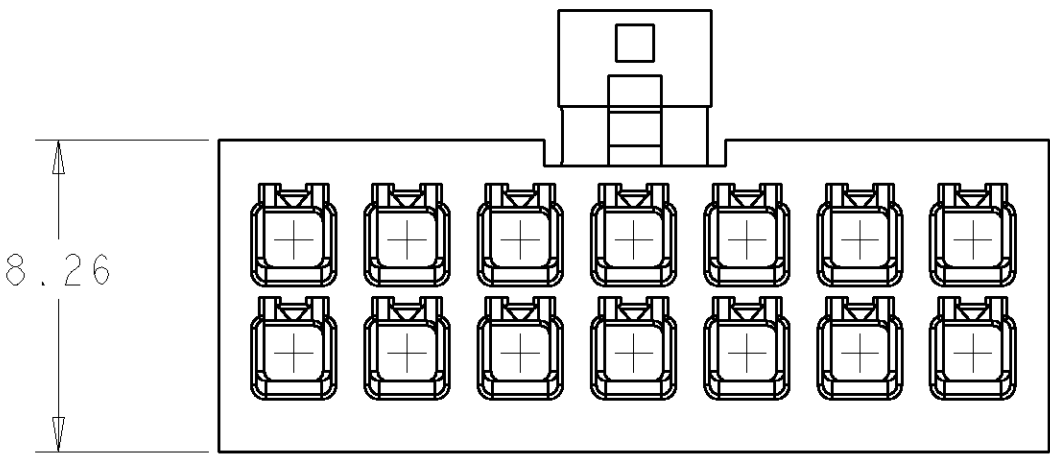
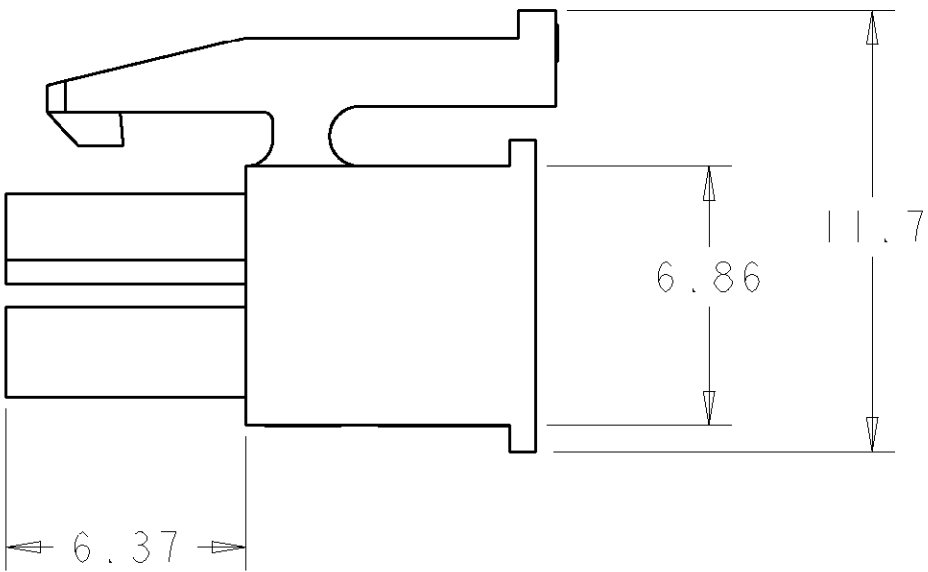
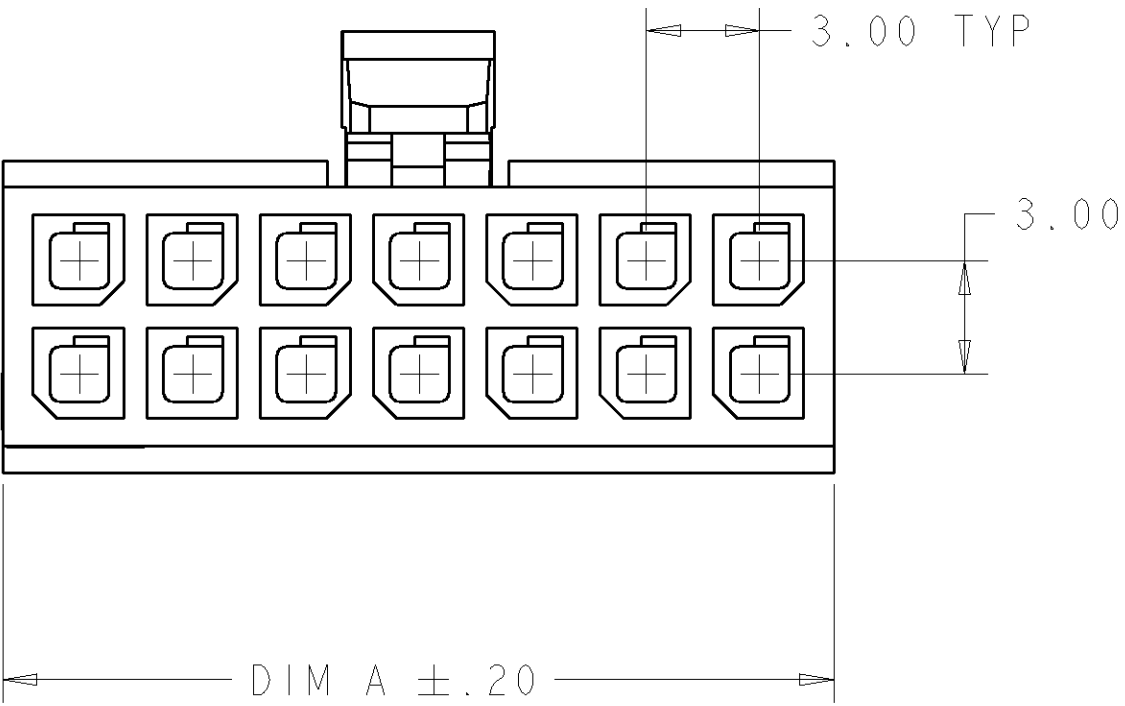

37.00	24	2-794617-4
34.00	22	2-794617-2
31.00	20	2-794617-0
28.00	18	1-794617-8
25.00	16	1-794617-6
22.00	14	1-794617-4
19.00	12	1-794617-2
16.00	10	1-794617-0
13.00	8	794617-8
10.00	6	794617-6
7.00	4	794617-4
4.00	2	794617-2
DIM A	NO. OF POS.	PART NUMBER

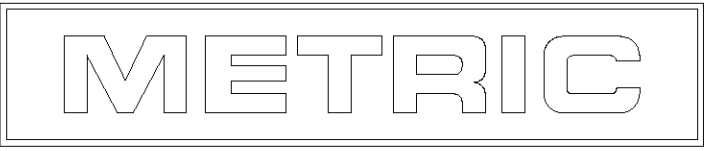

THIS DRAWING IS UNPUBLISHED. IT IS THE PROPERTY OF TYCO ELECTRONICS CORPORATION. IT IS TO BE USED ONLY FOR THE PURPOSES AND IN THE QUANTITIES SPECIFIED IN THE ORDER. ANY OTHER USE OR REPRODUCTION WITHOUT THE WRITTEN PERMISSION OF TYCO ELECTRONICS CORPORATION IS PROHIBITED.		DWN R. WHITAKER 14-OCT-1999	AMP Incorporated Harrisburg, PA 17105-3608	
DIMENSIONS:		CHK K. COBLE 14-OCT-1999	NAME	
mm		APVD K. COBLE 14-OCT-1999	RECEPTACLE HOUSING, 2 TO 24 POSITION,DUAL ROW, MICRO MATE-N-LOK™	
TOLERANCES UNLESS OTHERWISE SPECIFIED:		PRODUCT SPEC	SIZE	
9 PLC ±		APPLICATION SPEC	CAGE CODE	
2 PLC ±0.13		WEIGHT	DRAWING NO	
3 PLC ±		CUSTOMER DRAWING	RESTRICTED TO	
4 PLC ±			SCALE	
ANGLES ±0.30°			SHEET	
FINISH			OF	
MATERIAL NYLON 6, UL94V-0 BLACK			REV	
			E	