

DO NOT SCALE

DIMENSIONS IN mm

METRIC

THIRD ANGLE  
PROJECTION

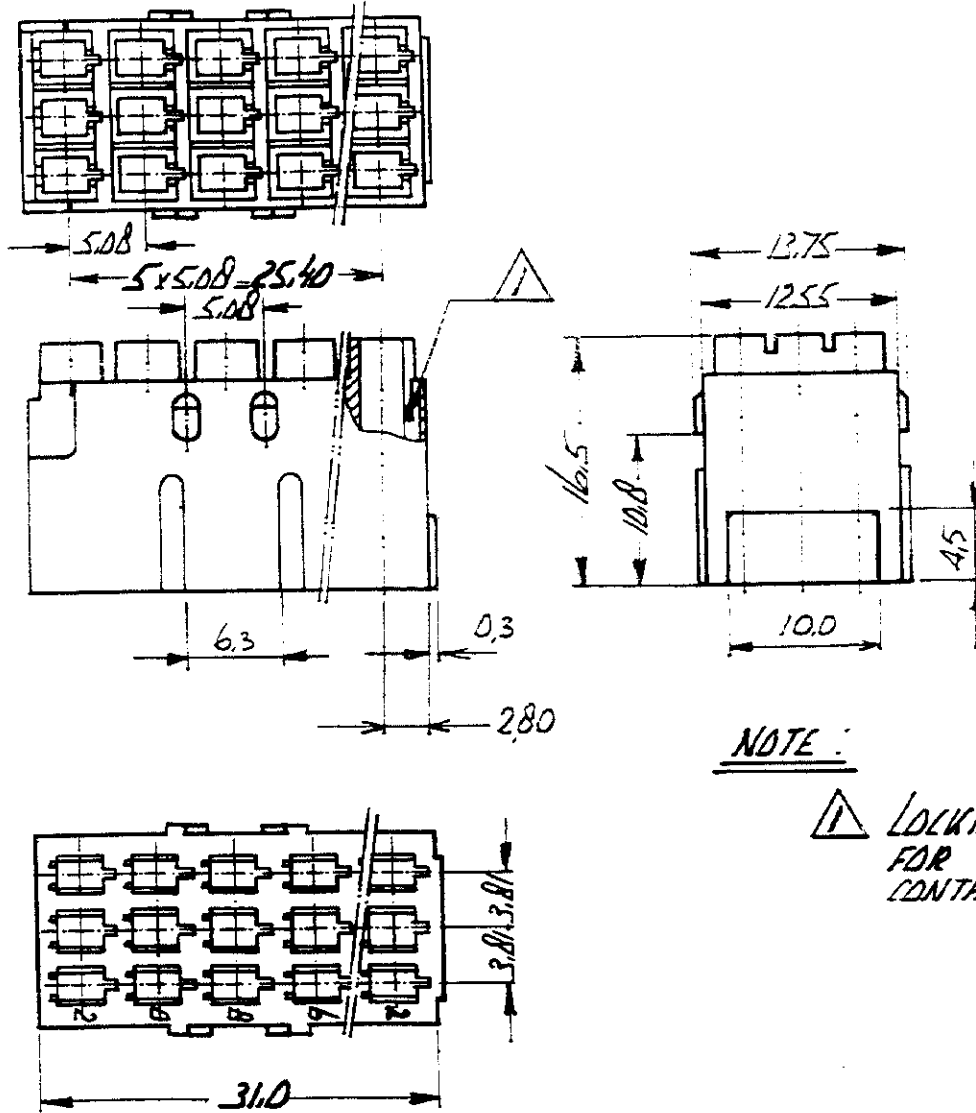
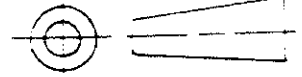

NOTE:

△ LOCKING LANCE AREA  
FOR CRIMP-ON / SNAP-IN  
CONTACT.

THERMOPLASTIC POLYESTER GLASSFILLED COLOUR : GREY	216519-1
--	----------

	FINISH	MATERIAL	PART NUMBER
<b>CUSTOMER DRAWING</b>  FOR REFERENCE ONLY WILL NOT BE UPDATED	<b>AMP</b>		AMP-HOLLAND B.V. 's-Hertogenbosch, The Netherlands
	THIS DRAWING IS UNPUBLISHED		RELEASED FOR PUBLICATION . 19
	© COPYRIGHT 19 BY AMP-HOLLAND B.V. ALL INTERNATIONAL RIGHTS RESERVED. AMP PRODUCTS MAY BE COVERED BY U.S. AND FOREIGN PATENTS AND/OR PATENTS PENDING.		
DWG <i>H. O. BRUNSWEN</i> 18-07-89	WIRE RANGE	NAME 3 x 6 PDS. MODULE FOR TYPE F FEMALE CRIMP-ON/SNAP-IN, B.T.B. CONNECTOR.	REV. DATE D M Y 18 07 89
CHK <i>Bob</i> 18-07-89	INSUL. RANGE		
APP <i>Bob</i> 25 7 89	SIZE A4	SHEET OF	DRAWING NO <b>C-216519</b>  REV. LTR. 0