

Push Button Switch

Q-9141

TYPE: **PBS08-01**

SPECIFICATIONS

Rating: 1,5A 250V AC
Contact R: 30mΩ max
Insulation R: 500V DC 100MΩ min
Dielectric Strength: 1 Minute 500V AC
Operating Temperature: -25°C ~ +70°C
Electrical Life: 10, 000 Cycles

Outline Drawing

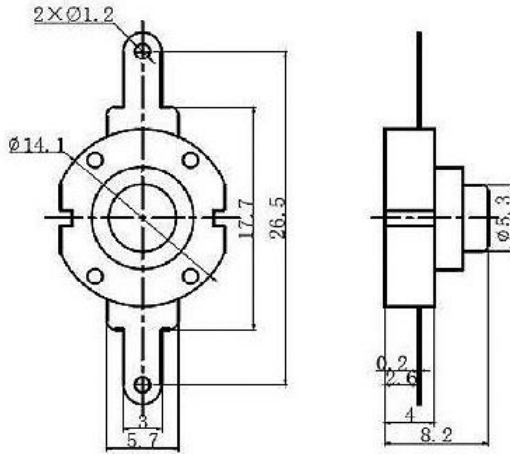

Mounting

Circuitry

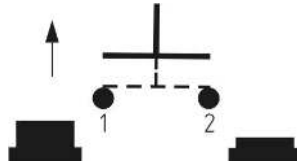

ON - OFF