

DASH NO.	M CODE	MADE FROM
----------	--------	-----------

GSD

KV-59-23

REVISIONS	
ISSUE	CHANGES
6	CN 35975 C REDRAWN ME 01/13/95

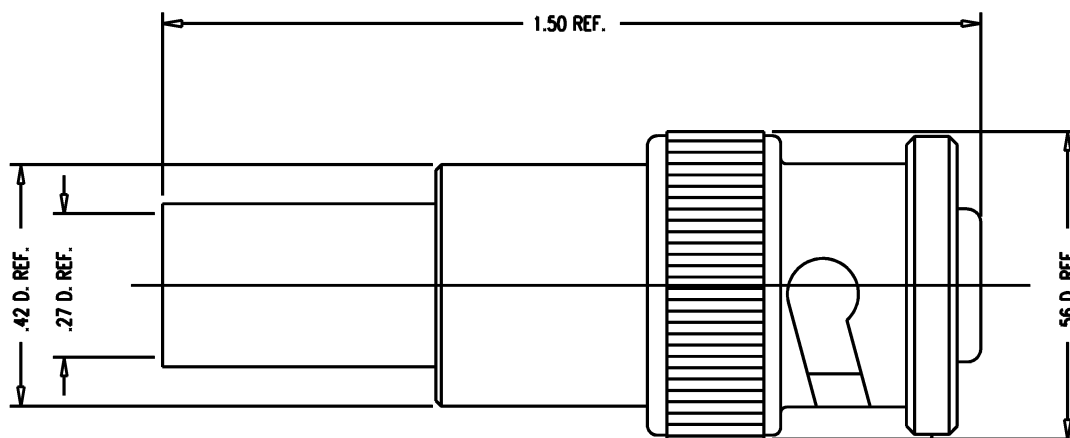

STAMP: KINGS KV-59-23

NOTES:

- FOR USE WITH RG-59, 62, & 210/U CABLE.
- FOR CABLING INSTRUCTIONS SEE CP-417.
- FOR CABLE TRIMMING USE KTJ-70 & KTD-36.
- FOR CRIMPING USE DIE KTH-2002.
- INTERFACE PER MIL-STD-348, FIG. 303-1.
- K-CRIP SLEEVE AND CENTER CONTACT TO BE SUPPLIED UNASSEMBLED.
- MATERIALS:
 INSULATOR: TEFLON, ASTM-D-1457
 GASKET: SIL. RUB., ZZ-R-765
 SPRING WASHER: BER. COP., ASTM-B-196
 ALL OTHER PARTS: BRASS, QQ-B-626
- FINISHES:
 CENTER CONTACT: SILVER PLT. PER QQ-S-365
 ALL OTHER METAL PARTS: KINGS TARNISH RESISTANT FINISH (TR-5)
- ELECTRICAL CHARACTERISTICS:
 VOLTAGE RATING: 3500 VRMS
 INSULATION RESISTANCE: 5000 MEGOHMS

QGS0061

SCALE 4:1

APPROX SURFACE AREA

USED ON

REF:

PLUG, MHV

DRAWN ME 01/13/95

DESIGN LI 01/23/95

APPR. DATE

KINGS
ELECTRONICS CO., INC.
TUCKAHOE, NEW YORK 10707

KV-59-23

GSD

Mouser Electronics

Authorized Distributor

Click to View Pricing, Inventory, Delivery & Lifecycle Information:

[Winchester Interconnect:](#)

[KV-59-23](#)