

SCALA NON IMPEGNATIVA
(DO NOT SCALE)
DIMENSIONI IN
(DIMENSIONS IN) mm

METRIC

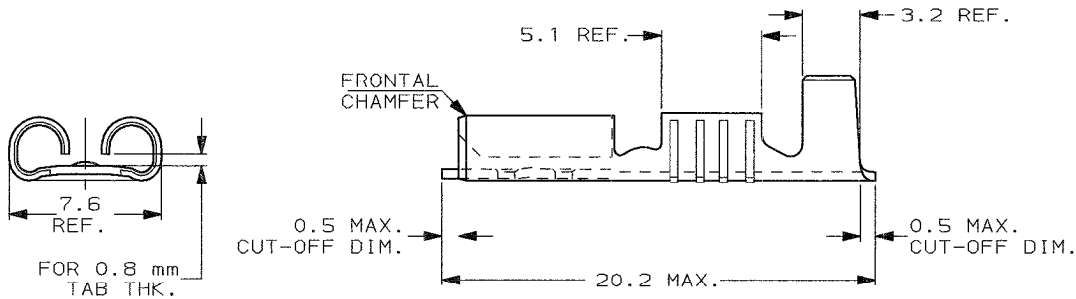
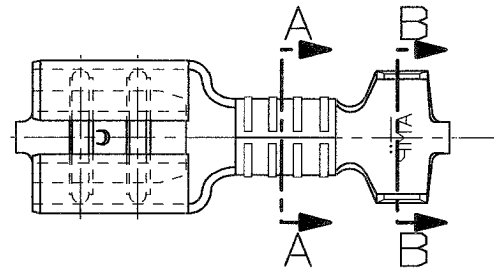

- 1) PER LE VERSIONI IN NASTRO
VEDERE DISEGNO 280001
(FOR STRIP FORM VERSION SEE DRAWING 280001)
- 2) CONFEZIONAMENTO IN ACCORDO
ALLA SPECIFICA AMP 107-20201
(PACKAGED ACCORDING TO TE SPEC. 107-20201).

SEZIONE A-A
SECTION A-A

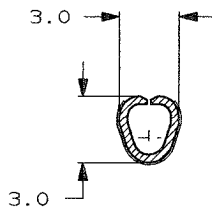

SEZIONE B-B
SECTION B-B

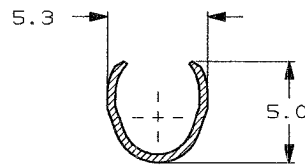

NUOVO (UNPLATED)	OTTONE (BRASS)	0-181903-4	G
STAGNATO (TIN PLATED)	OTTONE (BRASS)	0-181903-1	G
FINITURA / COLORE (FINISH / COLOUR)	MATERIALE (MATERIAL)	NUMERO (PART NUMBER)	REV

CUSTOMER DWG. FOR REFERENCE ONLY DISEGNO PER CLIENTE SOLO PER RIFERIMENTO

THIS DRAWING IS UNPUBLISHED. RELEASE FOR PUBLICATION 19
© COPYRIGHT 19 BY AMP INCORPORATED, HARRISBURG, PA. ALL INTERNATIONAL RIGHT RESERVED. AMP PRODUCTS MAY BE COVERED BY U.S. AND FOREIGN PATENT AND/OR PATENT PENDING.

TOLLERANZE, SE NON DIVERSAMENTE SPECIFICATO (TOLERANCES, UNLESS OTHERWISE SPECIFIED)	DIAM. ISOLANTE (INS. DIA. RANGE)	RANGO FILO (WIRE RANGE)	mm2	SCALA (SCALE)
± 0.3	3.0-4.3	1.0-2.5		4:1

ANGOLI (ANGLES) ± 2°



G1	PN 181903-4 OBSOLETE	PKS	17 JUL 2012	DIS. H. YAALI (DR.) 15 SEP 2000	DESCRIZIONE (DESCRIPTION) FASTON Connector, .250" sr. REC. CONTACT, (LOOSE PIECE VERSION)
G	OBSOLETE PARTS & REDRAWN ET00-0181-01	H.Y.	24 JUL 2000	CONT. C. TARTARI (CHK) 15 SEP 2000	LOC. SIZE NUMERO (APP.) (DWG NO)
REV.	REVISIONI (REVISION RECORD)	DIS. DATA (DR) (DATE)	APP. (APP.)	REV.	FUOGLIO (SHEET)
				I A3	G1 1 D1 (CP) 1

DISTRIBUZIONE
GRANT (0181.3)

Mouser Electronics

Authorized Distributor

Click to View Pricing, Inventory, Delivery & Lifecycle Information:

[TE Connectivity:](#)

[181903-1](#)