

Extractor Tool

**Application Tooling
Specification Sheet**

**Order No. 11-03-0043
Engineering No. HT60923A**

FEATURES

- This tool is designed to extract many different terminal series from various plug and receptacle housings. See Chart below.

SCOPE

Products:

| Terminal Series No. | Description | Housings Series No. | Terminal Order No. | | | | | |
|---------------------|--|-------------------------|--------------------|------------|------------|------------|------------|------------|
| 43030 | Micro-Fit 3.0™ Crimp Terminal 20-24 AWG | 43025 43645 44133 | 43030-0001 | 43030-0002 | 43030-0003 | 43030-0004 | 43030-0005 | 43030-0006 |
| | | | 43030-0007 | 43030-0008 | 43030-0009 | 43030-0010 | 43030-0011 | 43030-0012 |
| | | | 43030-0051 | 43030-0052 | 43030-0053 | 43030-0056 | 43030-0057 | 43030-0058 |
| | | | 43030-0059 | 43030-0080 | 43030-0081 | 43030-1001 | | |
| 43031 | | 43020 43640 44300 | 43031-0001 | 43031-0002 | 43031-0003 | 43031-0004 | 43031-0005 | 43031-0006 |
| | | | 43031-0007 | 43031-0008 | 43031-0009 | 43031-0010 | 43031-0011 | 43031-0012 |
| | | | 43031-0016 | 43031-0017 | 43031-0018 | 43031-0019 | 43031-0051 | 430310052 |
| | | | 430310053 | 43031-0057 | 43031-0059 | 43031-0102 | 43031-0103 | 43031-0106 |
| 44372 | Micro-Fit 3.0™ High Force 20-24 AWG | 43025 43645 44133 | 44372-0002 | | | | | |
| 45773 | Micro-Fit 3.0™ High Force 20-30 AWG | 43640 | 45773-0001 | 4577-0002 | 45773-0003 | 45773-0004 | 45773-0005 | 45773-0006 |
| | | | 4577-00053 | | | | | |
| 46235 | Micro-Fit 3.0™ Crimp Terminal 20-24 AWG | 43025 43645 44133 | 46235-0001 | 46235-0002 | 46235-0003 | 46235-0004 | 46235-5001 | 46235-5002 |
| | | | 46235-5004 | 46235-5003 | | | | |
| 50011 | 2.0mm (.079") Low Profile Receptacle Terminal 24-34 AWG | 51004 51049 | 50011-8000 | 50011-8100 | 39-00-0422 | | | |
| 50031 | | 51004 51049 | 50031-8000 | 50031-8100 | | | | |
| 50058 | 1.25mm (.049") Pitch PicoBlade™ 26-32 AWG | 51021 | 50058-8000 | 50058-8099 | 50058-8100 | 50058-8200 | 50058-8300 | 50058-8400 |
| | | | 50058-8500 | | | | | |
| 50061 | 1.25mm (.049") Pitch Board-In Crimp Terminal 28-32 AWG | 51022 | 50061-8000 | 50061-8018 | 50061-8028 | 50061-8099 | 50061-8100 | 50061-8118 |
| | | | 50061-8128 | | | | | |
| 50079 | 1.25mm (.049") Pitch PicoBlade™ Crimp Terminal 26-28 AWG | 51021 | 50079-8000 | 50079-8053 | 50079-8099 | 50079-8100 | 50079-8153 | |
| | | | 39-00-0413 | 39-00-0414 | | | | |
| 50080 | | 51022 | 50080-8000 | 50080-8100 | | | | |
| 50125 | | 51047 | 50125-8000 | 50125-8100 | | | | |
| 50133 | 1.25mm (.049") Pitch PicoBlade™ 28-32 AWG | 51047 | 50133-8000 | 50133-8100 | | | | |

| Terminal Series No. | Description | Housings Series No. | Terminal Order No. | | | | | |
|---------------------|---|------------------------|--------------------|------------|------------|------------|------------|--|
| | | | | | | | | |
| 50200 | 2.0mm (.079") Low Profile 22-32 AWG | 51004 51049 | 50200-8000 | 50200-8100 | | | | |
| 50212 | Micro-Latch™ 2.00mm (.079") Pitch 24-30 AWG | 5109 51065 51090 | 50212-8000 | 50212-8100 | 50212-8200 | 50212-8300 | 39-00-0424 | |
| 50372 | 2.00mm (.079") Pitch 22-26 AWG | 5109 51065 51090 | 50372-8000 | 50372-8100 | | | | |
| 50420 | 4.00mm (.157") Pitch OBD-II Wire-to-Wire | 51115 51116 | 50420-8000 | 50420-8100 | 50420-8200 | | | |
| 560085 | DuraClik™ Crimp Terminal, Female, 22-26 AWG | 502351 | 560085-0101 | | | | | |

Note: All Individual terminals may be extracted from the housing using this Tool.

OPERATION:

For 43030, 43031, 44372, and 46235 Terminal Series:

1. Insert the tip of the tool on either side of the terminal until it stops. See Figure 1. Rotate tool clockwise then counter-clockwise approximately 25° to 30° in each direction, once or twice.
2. Repeat steps 1 and 2 on the opposite side of terminal.
3. Pull on the wire and remove the terminal from the housing. See Figure 2.

NOTE: When a terminal is removed in this manner the locking tangs are damaged and the terminal is not reusable.

For 50011, 50031, 50058, 50061, 50079, 50080, 50125, 50133, 50200, 50212 and 50372, and 560085 Terminal Series:

1. Hold the housing with the locking tang facing up. Bend the wire down and insert the tip of the tool into the housing under the locking tang. See Figure 3.

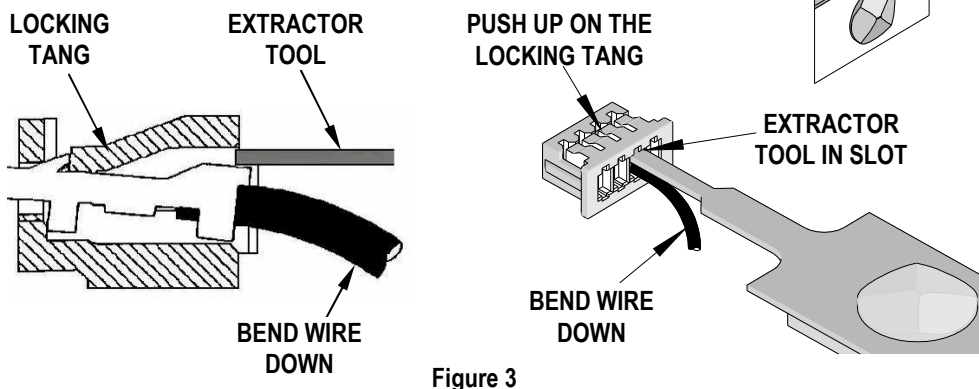
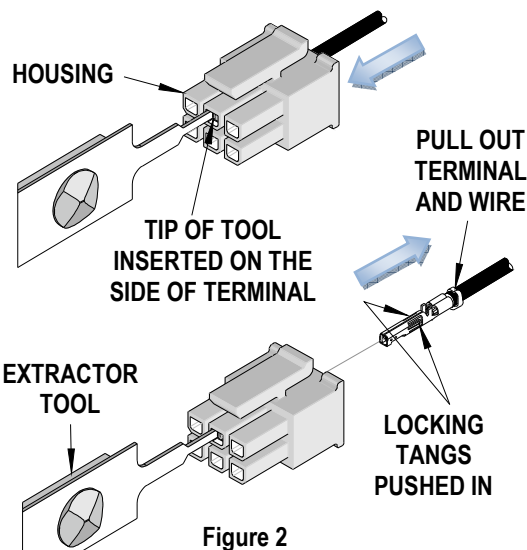
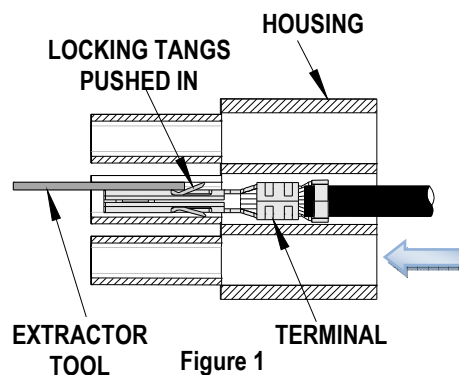

2. Hold the wire against the extractor tool and pull out the wire and the extractor tool at the same time. See Figure 4.

NOTE: When re-using the housing remember to bend back the locking tang when inserting another terminal.

For 50420 Terminal Series:

1. Push the terminal forward in the arrow direction before using the Extractor Tool.
2. Insert the tip of the Extractor Tool on an angle above the terminal into the slot on the top of the connector housing.
3. While rotating the extraction tool down, bend the terminal locking tang down and push the terminal back through the connector slot. Make sure that the terminated wire is pulled out at the same time. See Figure 5.

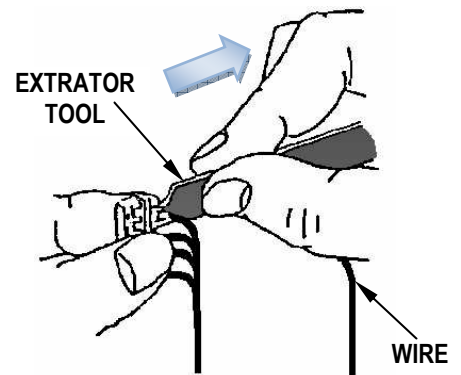

Figure 4

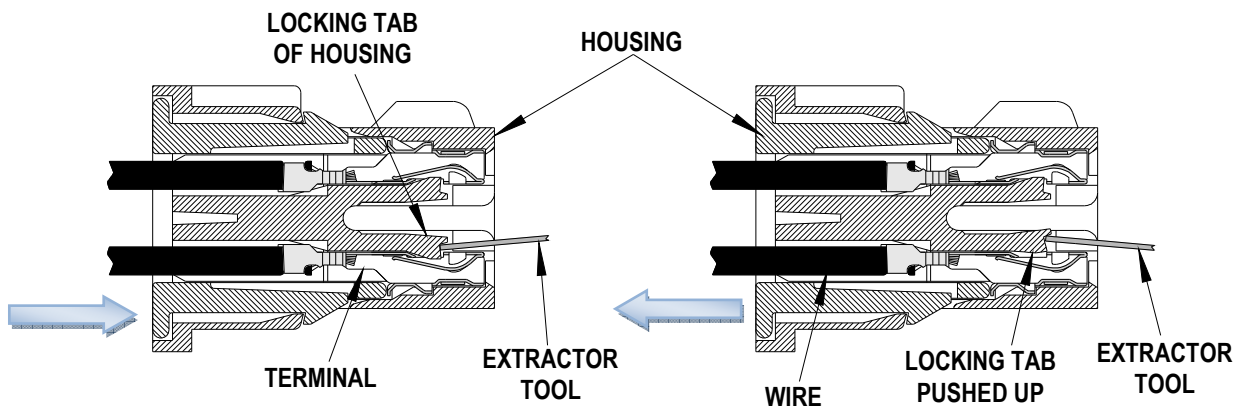

Figure 5

CAUTION: This extractor tool should be used to extract the terminal only. Using it for unintended purposes may cause injury or damage to parts. Be careful not to deform the end of the terminal.

CAUTION: Molex specifications are valid only when used with Molex terminals, applicators and tooling.

Molex does not offer repair parts for Extractor Tools due to the inexpensive nature of these tools.

Contact Information

For more information on Molex application tooling please contact Molex at 1-800-786-6539.

Visit our Web site at <http://www.molex.com>