

PRODUCT NO  
10046971-019LF

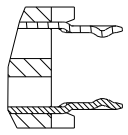
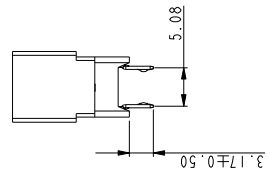
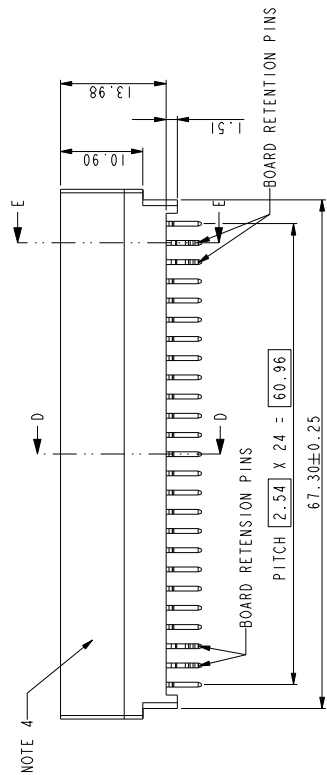
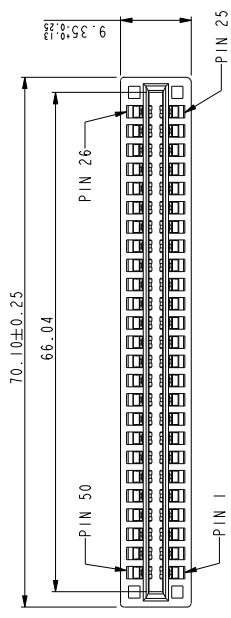
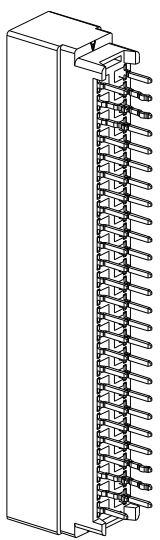

SECTION E-E  
SCALE 2.000  
BOARD RETENTION PINS

SECTION D-D

- NOTE:
- MATERIAL: HOUSING: HIGH TEMPERATURE THERMOPLASTIC, UL 94 V-0 FLAME RETARDANT. TERMINAL: HIGH CONDUCTIVITY COPPER ALLOY. PLATING SPEC AS BELOW:  
Ni 50u" UNDER PLATED.  
Au 30u" OVER CONTACT AREA. (ONE SIDE)  
MATTE TIN 120u" OVER SOLDERING AREA.
  - PACKING SPEC: GS-14-937
  - PRODUCT SPEC: GS-12-338
  - MANUFACTURER'S NAME, P/N AND DATE CODE TO APPEAR ON THIS SURFACE AS PER GS-24-007.
  - PART NUMBER 10046971-019LF MEETS EUROPEAN UNION DIRECTIVE AND OTHER COUNTRY REGULATIONS AS DESCRIBED IN GS-22-008. THE HOUSING WILL WITHSTAND EXPOSURE TO 260°C PEAK TEMPERATURE FOR 10 SECONDS IN A WAVE SOLDER APPLICATION WITH A CIRCUIT BOARD.

www.fciconnect.com		surface	tolerance std	projection	MM
TOLERANCES UNLESS OTHERWISE SPECIFIED					
Dr	JULIA WANG	2009-03-19	ANGULAR	0.X	±0.5
Eng	JULIA WANG	2009-03-19	LINEAR	0.XX	±0.25
Chr	PM ZHENG	2009-03-19	0° ±2°	0.XXX	±0.130
Appr	JOSEPH HSIA	2009-03-19	Product family	Spec ref	*
FCI		POWER EDGE CONNECTOR		ou	gmp
VERTICAL TYPE (25PX2)		catalog no		10046971-019	Rev. A
CUSTOMER COP		sheet 1 of 2			

rev	ecn no	dr	date
A	0610-0289	SM	08/23/10
-	-	-	-
-	-	-	-
-	-	-	-
-	-	-	-



Copyright FCI

PRODUCT NO  
10046971-019LF

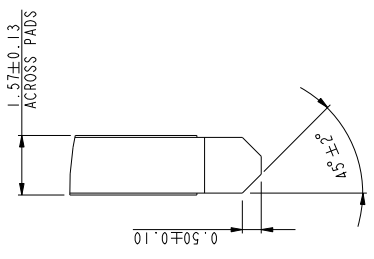
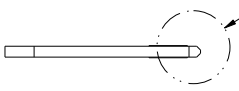
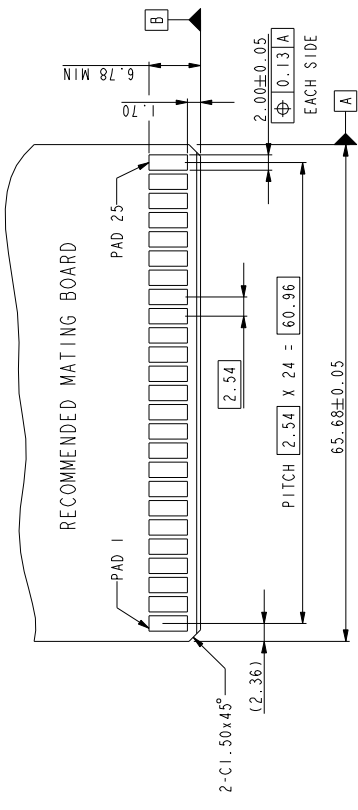

RECOMMENDED PC BOARD LAYOUT  
AND THE THICKNESS IS 2.36mm

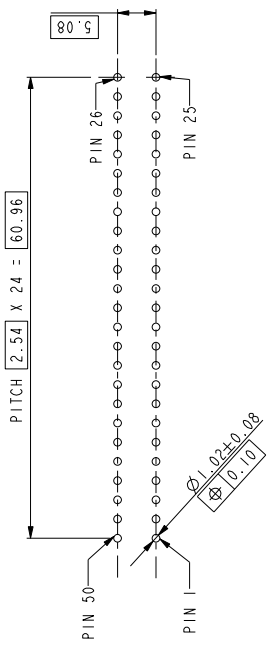

DETAIL A  
SCALE 5.000



Copyright FCI

www.fciconnect.com		surface	tolerance std	projection	MM
TOLERANCES UNLESS OTHERWISE SPECIFIED					
Dr	JULIA WANG	2009-03-19	0.X	±0.50	size
Eng	JULIA WANG	2009-03-19	0.XX	±0.25	A4
Chr	PM ZHENG	2009-03-19	0.XXX	±0.130	ECN
Appr	JOSEPH HSTA	2009-03-19	Product family		
FCI		POWER EDGE CONNECT		Spec ref	
VERTICAL TYPE (25PX2)		0.6mm		10046971-019	
catalog no		*		Rev. A	
		CUSTOMER COP		sheet 2 of 2	