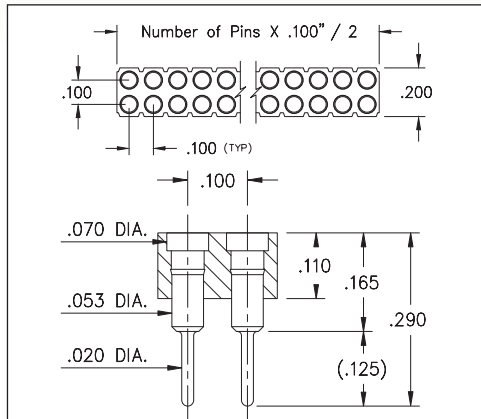
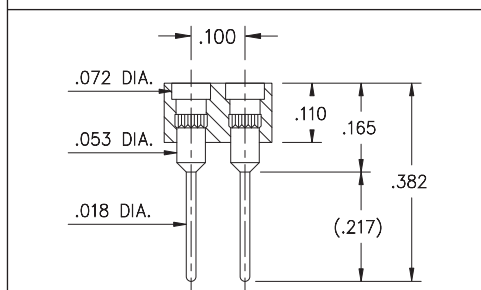


# SPRING-LOADED CONNECTORS

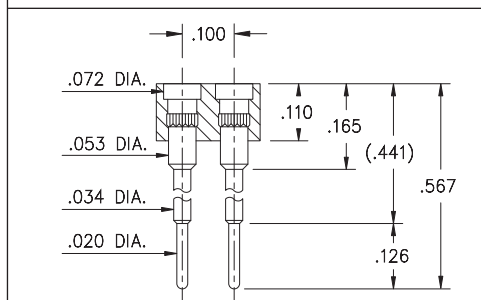
## SERIES 419, 430 • .100" GRID TARGET CONNECTORS FOR SPRING-LOADED ASSEMBLIES • DOUBLE ROW STRIPS



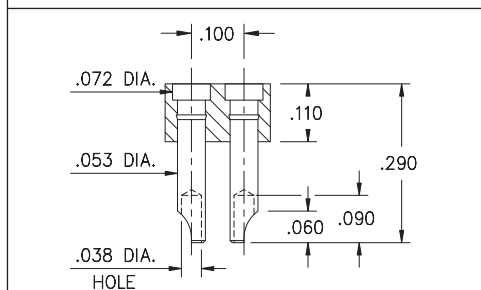
**FIG. 1**



**FIG. 2**

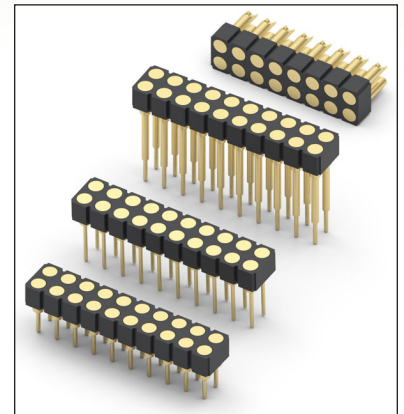


**FIG. 3**



**FIG. 4**

- Series 419 and 430 Spring Target Connectors, supplied in double row strips. Available in through-hole and wire termination configurations
- Target Connectors provide an excellent gold-plated conductive mating surface for spring loaded connectors. These series are offered with a flat face for making contact with our standard .042" dia. spring pin plungers
- Target connectors use MM #1938, #1940, #1942 and #3024 pins. See page 218 for details
- Insulators are high temperature thermoplastic



### ORDERING INFORMATION

	Series 419...001	Standard Solder Tails
<b>FIG. 1</b>	419-10-2	-00-001000
	Specify number of pins	04-64
	Series 419...002	Long Solder Tails
<b>FIG. 2</b>	419-10-2	-00-002000
	Specify number of pins	04-64
	Series 419...005	Elevated with Solder Tails
<b>FIG. 3</b>	419-10-2	-00-005000
	Specify number of pins	04-64
	Series 430...240	Solder Cups
<b>FIG. 4</b>	430-10-2	-00-240000
	Specify number of pins	04-64



XX=Plating Code  
See Below

For  
Electrical, Mechanical  
& Environmental Data,  
See page 264

SPECIFY PLATING CODE XX=	10			
Pin Plating 	10 μ" Au			



# Mouser Electronics

Authorized Distributor

Click to View Pricing, Inventory, Delivery & Lifecycle Information:

## Mill-Max:

[419-10-232-00-001000](#) [419-10-208-00-005000](#) [419-10-226-00-002000](#) [419-10-230-00-001000](#) [419-10-244-00-001000](#) [419-10-248-00-002000](#) [419-10-240-00-001000](#) [419-10-248-00-001000](#) [419-10-210-00-001000](#) [419-10-216-00-002000](#) [430-10-210-00-240000](#) [430-10-228-00-240000](#) [430-10-232-00-240000](#) [430-10-214-00-240000](#) [430-10-216-00-240000](#) [430-10-230-00-240000](#) [430-10-240-00-240000](#) [430-10-242-00-240000](#) [430-10-246-00-240000](#) [430-10-254-00-240000](#) [430-10-226-00-240000](#) [430-10-238-00-240000](#) [430-10-250-00-240000](#) [430-10-262-00-240000](#)