

panel cutting

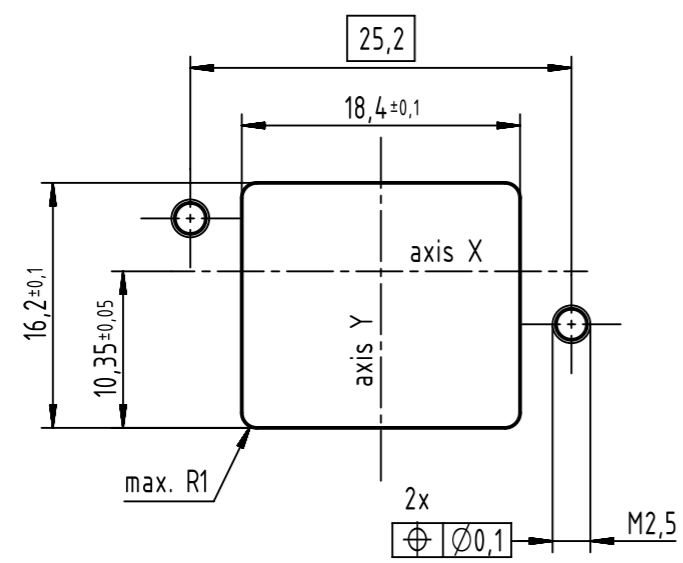

connector pitch on panel:  
axis X = 27mm and axis Y = 21mm

panel thickness = max. 3.5mm  
no limit with pre-assembled  
RJ45 Adapter

1 2x M2,5; screws acc. to ISO 4762;  
please order separately; bolting torque 0.3Nm - 0.5Nm

further information see: DS 09456101000

	All Dimensions in mm Original Size DIN A3		Scale 2:1	Free size tol.		Ref.	
	All rights reserved Department EC PD - DE		Created by HASELOH	Inspected by LUECKEMEIERM	Standardisation HOFFMANN	Date 2017-04-04	State Final Release
HARTING Electronics GmbH D-32339 Espelkamp		Title HARTING PushPull V4 Compact Housing with RJ45			Doc-Key / ECM-Nr. 100671787/UGD/000/B 500000117442		Rev. B
		Type TB	Number 09452451561		Page 1/1		

# Mouser Electronics

Authorized Distributor

Click to View Pricing, Inventory, Delivery & Lifecycle Information:

[HARTING:](#)

[09452451561](#)