

REV A	0460-247-16**	REVISIONS		
SYM	DESCRIPTION	DATE	APPROVED	
NC	NEW RELEASE PER E.O. A8012	8/28/88	JA	
A	REVISED PER E.O. P15979	3-22-99	KDR	

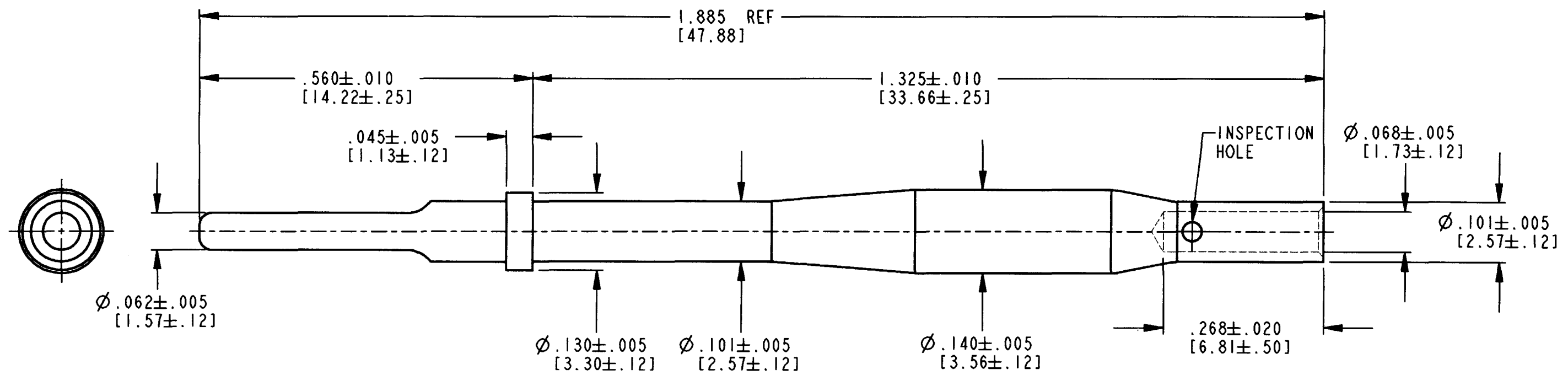

3. FOR CRIMPING INFORMATION SEE DRAWING 0425-205-0000.
2. WHEN ** = 31: CONTACT PLATING IS GOLD.
WHEN ** = 141: CONTACT PLATING IS NICKEL.
1. DIMENSIONS ARE IN INCHES [mm].
- NOTES:

SIGNATURE & DATE		PIN CONTACT SIZE 16 EXTENDED 16-18 AWG WIRE	CP	MATL. CODE
DR	D. MEYER 03/17/99		The Deutsch Company DEUTSCH I.P.D. 3850 INDUSTRIAL AVE. HEMET, CALIF. 92545	
CHK	<i>[Signature]</i> 3-22-99		B 0460-247-16**	
PE	D. Meyer 3/17/99			
APPD	<i>[Signature]</i> 3-22-99	ENVELOPE	DWG SIZE	CODE 11139
SCALE	NONE WT		SHEET	OF

Mouser Electronics

Authorized Distributor

Click to View Pricing, Inventory, Delivery & Lifecycle Information:

[TE Connectivity:](#)

[0460-247-16141](#)