

# 1592 OPEN

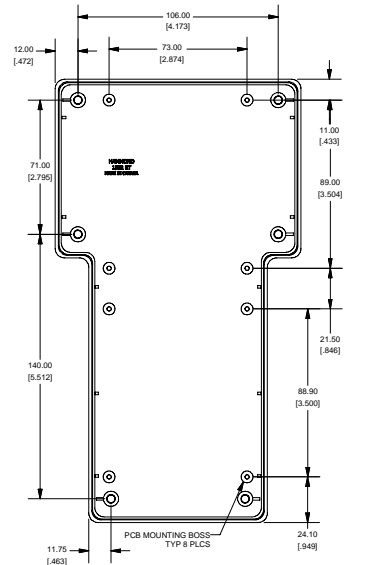

**FRONT VIEW OF BOX**

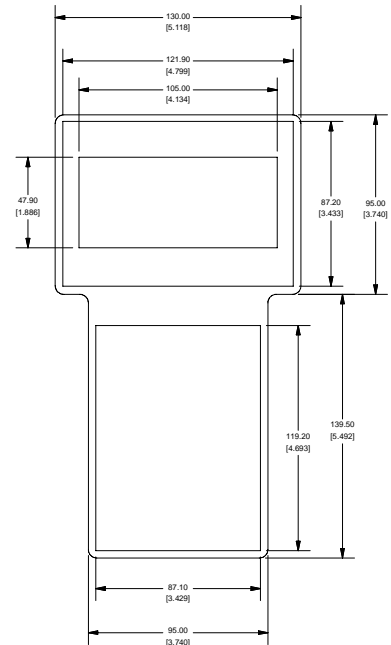
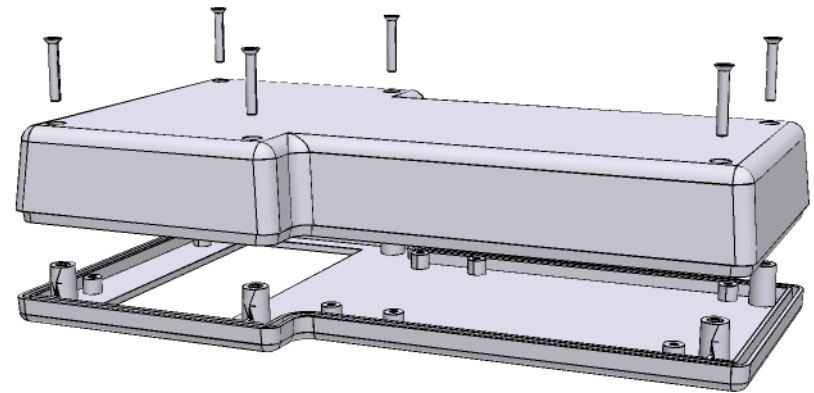
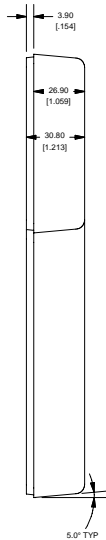

**FRONT VIEW OF LID**

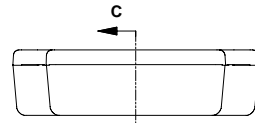
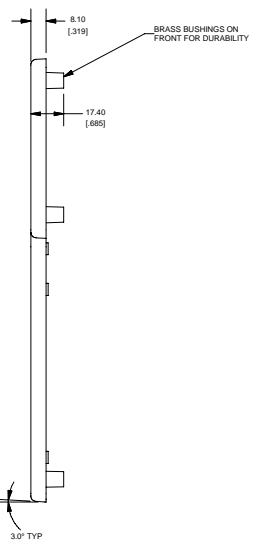

**END VIEW OF ASSEMBLY**

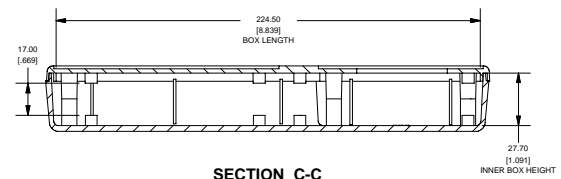

**SECTION C-C SCALE 1 / 2**

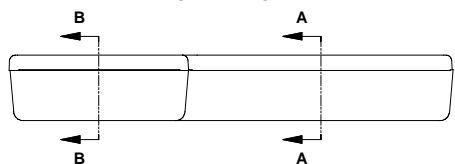

**SIDE VIEW OF ASSEMBLY**

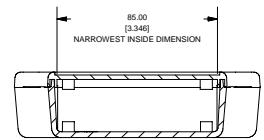

**SECTION A-A SCALE 1 / 2**

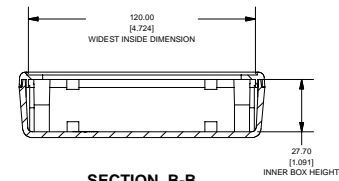

**SECTION B-B SCALE 1 / 2**



PART NUMBERS	
<b>1592 Enclosure</b>	
Grey case with open display insert and clear polycarbonate lens kit	1592ETCDGY
Black case with open display insert and clear polycarbonate lens kit	1592ETCDBK
<b>Accessories</b>	
Gasket kit with 76 cm (30") of gasket (for one unit)	1592ETG
Rubber Feet (package of 6)	1592ETRF
Magnetic Strip 7.62 cm (3") square	1592ETM
Velcro Mounting Tab	1592ETV
M3 - 0.5 x 20mm countersunk flat head replacement screws	1594MS100