

# MPT 1,5/S - Mini feed-through terminal block



3248100

<https://www.phoenixcontact.com/in/products/3248100>

Please be informed that the data shown in this PDF document is generated from our Online Catalog. Please find the complete data in the user documentation. Our General Terms of Use for Downloads are valid.

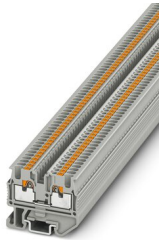

Mini feed-through terminal block, nom. voltage: 500 V, nominal current: 17.5 A, connection method: Push-in connection, 1 level, Rated cross section: 1.5 mm<sup>2</sup>, cross section: 0.14 mm<sup>2</sup> - 1.5 mm<sup>2</sup>, mounting type: NS 15, color: gray

## Your advantages

- Space saving thanks to compact design and mounting option on a 15 mm DIN rail
- Clear arrangement thanks to marking of all terminal points
- Tested for railway applications

## Commercial Data

Item number	3248100
Packing unit	50 pc
Minimum order quantity	50 pc
Sales Key	BE2
Product Key	BE2261
Catalog Page	Page 45 (C-1-2019)
GTIN	4046356768719
Weight per Piece (including packing)	2.939 g
Weight per Piece (excluding packing)	2.913 g
Customs tariff number	85369010
Country of origin	PL

# MPT 1,5/S - Mini feed-through terminal block



3248100

<https://www.phoenixcontact.com/in/products/3248100>

## Technical Data

### Product properties

Product type	Miniature terminal block
Area of application	Railway industry
	Machine building
	Plant engineering
Number of connections	2
Number of rows	1
Potentials	1

### Insulation characteristics

Overvoltage category	III
Degree of pollution	3

### Electrical properties

Rated surge voltage	6 kV
Maximum power dissipation for nominal condition	0.56 W

### Connection data

Number of connections per level	2
Nominal cross section	1.5 mm <sup>2</sup>

#### 1 level

Stripping length	8 mm ... 10 mm
Internal cylindrical gage	A1 / B1
Connection in acc. with standard	IEC 60947-7-1
Conductor cross section rigid	0.14 mm <sup>2</sup> ... 1.5 mm <sup>2</sup>
Cross section AWG	26 ... 14 (converted acc. to IEC)
Conductor cross section flexible	0.14 mm <sup>2</sup> ... 1.5 mm <sup>2</sup>
Conductor cross section, flexible [AWG]	26 ... 14 (converted acc. to IEC)
Conductor cross-section flexible (ferrule without plastic sleeve)	0.14 mm <sup>2</sup> ... 1.5 mm <sup>2</sup>
Flexible conductor cross section (ferrule with plastic sleeve)	0.14 mm <sup>2</sup> ... 1 mm <sup>2</sup>
Nominal current	17.5 A
Maximum load current	17.5 A
Nominal voltage	500 V
Nominal cross section	1.5 mm <sup>2</sup>

#### 1 level Connection cross sections directly pluggable

Conductor cross section rigid	0.25 mm <sup>2</sup> ... 1.5 mm <sup>2</sup>
Conductor cross-section flexible (ferrule without plastic sleeve)	0.34 mm <sup>2</sup> ... 1.5 mm <sup>2</sup>
Flexible conductor cross section (ferrule with plastic sleeve)	0.34 mm <sup>2</sup> ... 1 mm <sup>2</sup>

### Ex data

# MPT 1,5/S - Mini feed-through terminal block



3248100

<https://www.phoenixcontact.com/in/products/3248100>

## Rated data (ATEX/IECEX)

Identification	□ II 2 GD Ex eb IIC Gb
Operating temperature range	-60 °C ... 110 °C
Ex-certified accessories	3248120 D-MPT 1,5/S 1204504 SZF 0-0,4X2,5 3022263 CLIPFIX 15
List of bridges	Plug-in bridge / FBS 2-3,5 / 3213014 Plug-in bridge / FBS 3-3,5 / 3213027 Plug-in bridge / FBS 4-3,5 / 3213030 Plug-in bridge / FBS 5-3,5 / 3213043 Plug-in bridge / FBS 10-3,5 / 3213056 Plug-in bridge / FBS 20-3,5 / 3213069
Bridge data	14.5 A / 1.5 mm <sup>2</sup>
Ex temperature increase	40 K (14.5 A / 1.5 mm <sup>2</sup> )
Rated voltage	352 V
for bridging with bridge	352 V
- At bridging between non-adjacent terminal blocks	220 V
- At cut-to-length bridging	166 V
- At cut-to-length bridging with cover	352 V
Rated insulation voltage	320 V
output	(Permanent)

## Ex level General

Rated current	14.5 A
Maximum load current	14.5 A
Contact resistance	1.6 mΩ

## Ex connection data General

Nominal cross section	1.5 mm <sup>2</sup>
Rated cross section AWG	16
Connection capacity rigid	0.14 mm <sup>2</sup> ... 1.5 mm <sup>2</sup>
Connection capacity AWG	26 ... 16
Connection capacity flexible	0.14 mm <sup>2</sup> ... 1.5 mm <sup>2</sup>
Connection capacity AWG	26 ... 16

## Dimensions

Width	3.5 mm
End cover width	2.2 mm
Height NS 15	28.1 mm
Length	33.55 mm

## Material specifications

Color	gray
Flammability rating according to UL 94	V0
Insulating material group	I

# MPT 1,5/S - Mini feed-through terminal block



3248100

<https://www.phoenixcontact.com/in/products/3248100>

Insulating material	PA
Static insulating material application in cold	-60 °C
Temperature index of insulation material (DIN EN 60216-1 (VDE 0304-21))	130 °C
Relative insulation material temperature index (Elec., UL 746 B)	130 °C
Fire protection for rail vehicles (DIN EN 45545-2) R22	HL 1 - HL 3
Fire protection for rail vehicles (DIN EN 45545-2) R23	HL 1 - HL 3
Fire protection for rail vehicles (DIN EN 45545-2) R24	HL 1 - HL 3
Fire protection for rail vehicles (DIN EN 45545-2) R26	HL 1 - HL 3
Calorimetric heat release NFPA 130 (ASTM E 1354)	28 MJ/kg
Surface flammability NFPA 130 (ASTM E 162)	passed
Specific optical density of smoke NFPA 130 (ASTM E 662)	passed
Smoke gas toxicity NFPA 130 (SMP 800C)	passed

## Electrical tests

### Surge voltage test

Test voltage setpoint	7.3 kV
Result	Test passed

### Temperature-rise test

Requirement temperature-rise test	Increase in temperature $\leq$ 45 K
Result	Test passed
Short-time withstand current 1.5 mm <sup>2</sup>	0.18 kA
Result	Test passed

### Power-frequency withstand voltage

Test voltage setpoint	1.89 kV
Result	Test passed

## Mechanical properties

### Mechanical data

Open side panel	Yes
-----------------	-----

## Mechanical tests

### Mechanical strength

Result	Test passed
--------	-------------

### Attachment on the carrier

DIN rail/fixing support	NS 15
Test force setpoint	1 N
Result	Test passed

### Test for conductor damage and slackening

Conductor cross section/weight	0.14 mm <sup>2</sup> / 0.2 kg
	1.5 mm <sup>2</sup> / 0.4 kg

# MPT 1,5/S - Mini feed-through terminal block



3248100

<https://www.phoenixcontact.com/in/products/3248100>

Result	Test passed
--------	-------------

## Environmental and real-life conditions

### Aging

Temperature cycles	192
Result	Test passed

### Needle-flame test

Time of exposure	30 s
Result	Test passed

### Oscillation/broadband noise

Specification	DIN EN 50155 (VDE 0115-200):2008-03
Spectrum	Service life test category 2, bogie-mounted
Frequency	$f_1 = 5 \text{ Hz}$ to $f_2 = 250 \text{ Hz}$
ASD level	$6.12 \text{ (m/s}^2\text{)}^2\text{/Hz}$
Acceleration	3.12g
Test duration per axis	5 h
Test directions	X-, Y- and Z-axis
Result	Test passed

### Shocks

Specification	DIN EN 50155 (VDE 0115-200):2008-03
Pulse shape	Half-sine
Acceleration	30g
Shock duration	18 ms
Number of shocks per direction	3
Test directions	X-, Y- and Z-axis (pos. and neg.)
Result	Test passed

### Ambient conditions

Ambient temperature (operation)	-60 °C ... 105 °C (max. short-term operating temperature RTI Elec.)
Ambient temperature (storage/transport)	-25 °C ... 60 °C (for a short time, not exceeding 24 h, -60 °C to +70 °C)
Ambient temperature (assembly)	-5 °C ... 70 °C
Ambient temperature (actuation)	-5 °C ... 70 °C
Permissible humidity (storage/transport)	30 % ... 70 %

## Standards and regulations

Connection in acc. with standard	IEC 60947-7-1
----------------------------------	---------------

## Mounting

Mounting type	NS 15
---------------	-------

# MPT 1,5/S - Mini feed-through terminal block

3248100

<https://www.phoenixcontact.com/in/products/3248100>



## Drawings

### Circuit diagram



# MPT 1,5/S - Mini feed-through terminal block





3248100

<https://www.phoenixcontact.com/in/products/3248100>

## Approvals

 <b>CSA</b> Approval ID: 13631				
	Nominal Voltage $U_N$	Nominal Current $I_N$	Cross Section AWG	Cross Section $\text{mm}^2$
Use group B	300 V	15 A	26 - 14	-
Use group C	300 V	15 A	26 - 14	-
Use group D	600 V	5 A	26 - 14	-

 <b>IECEE CB Scheme</b> Approval ID: DE1-62773				
	Nominal Voltage $U_N$	Nominal Current $I_N$	Cross Section AWG	Cross Section $\text{mm}^2$
	500 V	17.5 A	-	- 1.5

 <b>EAC</b> Approval ID: RU C-DE.BL08.B.00644				
---	--	--	--	--

 <b>cULus Recognized</b> Approval ID: E60425				
	Nominal Voltage $U_N$	Nominal Current $I_N$	Cross Section AWG	Cross Section $\text{mm}^2$
Use group B	300 V	15 A	26 - 14	-
Use group C	300 V	15 A	26 - 14	-
Use group D	600 V	5 A	26 - 14	-

 <b>LR</b> Approval ID: LR2004293TA				
---	--	--	--	--

 <b>BV</b> Approval ID: 38194/B0 BV				
---	--	--	--	--

 <b>VDE Zeichengenehmigung</b> Approval ID: 40040312				
	Nominal Voltage $U_N$	Nominal Current $I_N$	Cross Section AWG	Cross Section $\text{mm}^2$
	500 V	17.5 A	-	0.14 - 1.5

# MPT 1,5/S - Mini feed-through terminal block



3248100

<https://www.phoenixcontact.com/in/products/3248100>



## IECEX

Approval ID: IECEX SEV14.0010U

	Nominal Voltage $U_N$	Nominal Current $I_N$	Cross Section AWG	Cross Section $\text{mm}^2$
	352 V	14.5 A	-	0.14 - 1.5



## ATEX

Approval ID: SEV14ATEX0140U

	Nominal Voltage $U_N$	Nominal Current $I_N$	Cross Section AWG	Cross Section $\text{mm}^2$
	352 V	14.5 A	-	0.14 - 1.5



## CCC

Approval ID: 2020322313000629



## NEPSI

Approval ID: GYJ20.1196U



## UKCA-EX

Approval ID: CML 22UKEX1228U



# MPT 1,5/S - Mini feed-through terminal block



3248100

<https://www.phoenixcontact.com/in/products/3248100>

## Classifications

### ECLASS

ECLASS-11.0

27141120

### ETIM

ETIM 8.0

EC000897

### UNSPSC

UNSPSC 21.0

39121400

# MPT 1,5/S - Mini feed-through terminal block



3248100

<https://www.phoenixcontact.com/in/products/3248100>

## Environmental Product Compliance

China RoHS	Environmentally friendly use period: unlimited = EFUP-e
	No hazardous substances above threshold values

# MPT 1,5/S - Mini feed-through terminal block

3248100

<https://www.phoenixcontact.com/in/products/3248100>

## Accessories

 Note: Applying some accessories below might limit this product.

### FBS 2-3,5 - Plug-in bridge

3213014

<https://www.phoenixcontact.com/in/products/3213014>



Plug-in bridge, pitch: 3.5 mm, number of positions: 2, color: red

 Max. current carrying capacity: 17.5 A

---

### FBS 3-3,5 - Plug-in bridge

3213027

<https://www.phoenixcontact.com/in/products/3213027>



Plug-in bridge, pitch: 3.5 mm, number of positions: 3, color: red

 Max. current carrying capacity: 17.5 A

# MPT 1,5/S - Mini feed-through terminal block

3248100

<https://www.phoenixcontact.com/in/products/3248100>



## FBS 4-3,5 - Plug-in bridge

3213030

<https://www.phoenixcontact.com/in/products/3213030>



Plug-in bridge, pitch: 3.5 mm, number of positions: 4, color: red

 Max. current carrying capacity: 17.5 A

---

## FBS 5-3,5 - Plug-in bridge

3213043

<https://www.phoenixcontact.com/in/products/3213043>



Plug-in bridge, pitch: 3.5 mm, number of positions: 5, color: red

 Max. current carrying capacity: 17.5 A

# MPT 1,5/S - Mini feed-through terminal block

3248100

<https://www.phoenixcontact.com/in/products/3248100>



## FBS 10-3,5 - Plug-in bridge

3213056

<https://www.phoenixcontact.com/in/products/3213056>



Plug-in bridge, pitch: 3.5 mm, number of positions: 10, color: red

 Max. current carrying capacity: 17.5 A

---

## FBS 20-3,5 - Plug-in bridge

3213069

<https://www.phoenixcontact.com/in/products/3213069>



Plug-in bridge, pitch: 3.5 mm, number of positions: 20, color: red

 Max. current carrying capacity: 17.5 A

# MPT 1,5/S - Mini feed-through terminal block

3248100

<https://www.phoenixcontact.com/in/products/3248100>



## FBS 2-3,5 BU - Plug-in bridge

3213086

<https://www.phoenixcontact.com/in/products/3213086>



Plug-in bridge, pitch: 3.5 mm, number of positions: 2, color: blue

 Max. current carrying capacity: 17.5 A

---

## FBS 3-3,5 BU - Plug-in bridge

3213099

<https://www.phoenixcontact.com/in/products/3213099>



Plug-in bridge, pitch: 3.5 mm, number of positions: 3, color: blue

 Max. current carrying capacity: 17.5 A

# MPT 1,5/S - Mini feed-through terminal block

3248100

<https://www.phoenixcontact.com/in/products/3248100>



## FBS 4-3,5 BU - Plug-in bridge

3213109

<https://www.phoenixcontact.com/in/products/3213109>



Plug-in bridge, pitch: 3.5 mm, number of positions: 4, color: blue

 Max. current carrying capacity: 17.5 A

---

## FBS 5-3,5 BU - Plug-in bridge

3213112

<https://www.phoenixcontact.com/in/products/3213112>



Plug-in bridge, pitch: 3.5 mm, number of positions: 5, color: blue

 Max. current carrying capacity: 17.5 A

# MPT 1,5/S - Mini feed-through terminal block

3248100

<https://www.phoenixcontact.com/in/products/3248100>



## FBS 10-3,5 BU - Plug-in bridge

3213125

<https://www.phoenixcontact.com/in/products/3213125>



Plug-in bridge, pitch: 3.5 mm, number of positions: 10, color: blue

 Max. current carrying capacity: 17.5 A

---

## FBS 20-3,5 BU - Plug-in bridge

3213138

<https://www.phoenixcontact.com/in/products/3213138>



Plug-in bridge, pitch: 3.5 mm, number of positions: 20, color: blue

 Max. current carrying capacity: 17.5 A



# MPT 1,5/S - Mini feed-through terminal block

3248100

<https://www.phoenixcontact.com/in/products/3248100>



## FBS 2-3,5 GY - Plug-in bridge

3213153

<https://www.phoenixcontact.com/in/products/3213153>



Plug-in bridge, pitch: 3.5 mm, number of positions: 2, color: gray

 Max. current carrying capacity: 17.5 A

---

## FBS 3-3,5 GY - Plug-in bridge

3213167

<https://www.phoenixcontact.com/in/products/3213167>



Plug-in bridge, pitch: 3.5 mm, number of positions: 3, color: gray

 Max. current carrying capacity: 17.5 A

# MPT 1,5/S - Mini feed-through terminal block

3248100

<https://www.phoenixcontact.com/in/products/3248100>



## FBS 4-3,5 GY - Plug-in bridge

3213180

<https://www.phoenixcontact.com/in/products/3213180>



Plug-in bridge, pitch: 3.5 mm, number of positions: 4, color: gray

 Max. current carrying capacity: 17.5 A

---

## FBS 5-3,5 GY - Plug-in bridge

3213183

<https://www.phoenixcontact.com/in/products/3213183>



Plug-in bridge, pitch: 3.5 mm, number of positions: 5, color: gray

 Max. current carrying capacity: 17.5 A

# MPT 1,5/S - Mini feed-through terminal block

3248100

<https://www.phoenixcontact.com/in/products/3248100>



## FBS 10-3,5 GY - Plug-in bridge

3213196

<https://www.phoenixcontact.com/in/products/3213196>



Plug-in bridge, pitch: 3.5 mm, number of positions: 10, color: gray

 Max. current carrying capacity: 17.5 A

---

## FBS 20-3,5 GY - Plug-in bridge

3213206

<https://www.phoenixcontact.com/in/products/3213206>



Plug-in bridge, pitch: 3.5 mm, number of positions: 20, color: gray

 Max. current carrying capacity: 17.5 A

# MPT 1,5/S - Mini feed-through terminal block



3248100

<https://www.phoenixcontact.com/in/products/3248100>

## D-MPT 1,5/S - End cover

3248120

<https://www.phoenixcontact.com/in/products/3248120>

End cover, length: 33.6 mm, width: 2.2 mm, height: 22.3 mm, color: gray



---

## SZF 0-0,4X2,5 - Screwdriver

1204504

<https://www.phoenixcontact.com/in/products/1204504>

Actuation tool, for ST terminal blocks, also suitable for use as a bladed screwdriver, size: 0.4 x 2.5 x 75 mm, 2-component grip, with non-slip grip



# MPT 1,5/S - Mini feed-through terminal block

3248100

<https://www.phoenixcontact.com/in/products/3248100>



## ST-BW 0 - Actuation tool

1200135

<https://www.phoenixcontact.com/in/products/1200135>

Actuation tool, for all 1.5 mm<sup>2</sup> spring cages from PT 1,5/S and FT 1,5/S



---

## MPS-MT 1-S4-B RD - Accessories

1982800

<https://www.phoenixcontact.com/in/products/1982800>

Test plug terminal block, Accessories



# MPT 1,5/S - Mini feed-through terminal block



3248100

<https://www.phoenixcontact.com/in/products/3248100>

## AI-S 1 - 8 TQ - Ferrule

1200293

<https://www.phoenixcontact.com/in/products/1200293>



Ferrule, S-Slimline, sleeve length: 8 mm, length: 14.5 mm, color: turquoise

---

## NS 15 UNPERF 2000MM VPE 10 - DIN rail, unperforated

1401695

<https://www.phoenixcontact.com/in/products/1401695>



DIN rail, unperforated, acc. to EN 60715, material: Steel, galvanized, passivated with a thick layer, Standard profile, color: silver, Pack of 10 (20 m)

# MPT 1,5/S - Mini feed-through terminal block

3248100

<https://www.phoenixcontact.com/in/products/3248100>



## NS 15 PERF 2000MM VPE 10 - DIN rail perforated

1401682

<https://www.phoenixcontact.com/in/products/1401682>



DIN rail perforated, acc. to EN 60715, material: Steel, galvanized, passivated with a thick layer, Standard profile, color: silver, Pack of 10 (20 m)

---

## NS 15 AL PERF 2000MM VPE 10 - DIN rail perforated

1401763

<https://www.phoenixcontact.com/in/products/1401763>



DIN rail perforated, acc. to EN 60715, material: Aluminum, uncoated, Standard profile, color: silver, Pack of 10 (20 m)

# MPT 1,5/S - Mini feed-through terminal block

3248100

<https://www.phoenixcontact.com/in/products/3248100>



## NS 15 WH PERF 2000MM-VPE 10 - DIN rail perforated

1204096

<https://www.phoenixcontact.com/in/products/1204096>



DIN rail perforated, acc. to EN 60715, material: Steel, Galvanized, white passivated, Standard profile, color: silver, Pack of 10 (20 m)

---

## CLIPFIX 15 - End clamp

3022263

<https://www.phoenixcontact.com/in/products/3022263>



Snap-on end bracket, to be snapped onto NS 15 DIN rail



# MPT 1,5/S - Mini feed-through terminal block

3248100

<https://www.phoenixcontact.com/in/products/3248100>



## ZBF 3,5:UNBEDRUCKT - Zack Marker strip, flat

0829392

<https://www.phoenixcontact.com/in/products/0829392>

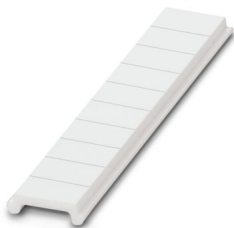

Zack Marker strip, flat, Strip, white, unlabeled, can be labeled with: PLOTMARK, CMS-P1-PLOTTER, mounting type: snapped, for terminal block width: 3.5 mm, lettering field size: 3.5 x 5.2 mm, Number of individual labels: 10

---

## ZBF 3,5 CUS - Zack Marker strip, flat

0829394

<https://www.phoenixcontact.com/in/products/0829394>

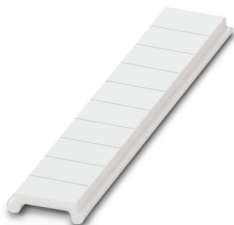

Zack Marker strip, flat, can be ordered: Strip, white, labeled according to customer specifications, mounting type: snap into flat marker groove, for terminal block width: 3.5 mm, lettering field size: 3.5 x 5.2 mm, Number of individual labels: 10

# MPT 1,5/S - Mini feed-through terminal block

3248100

<https://www.phoenixcontact.com/in/products/3248100>

## ZBF 3,5,LGS:FORTL.ZAHLEN - Zack Marker strip, flat

0801406

<https://www.phoenixcontact.com/in/products/0801406>



Zack Marker strip, flat, Strip, white, labeled, printed horizontally: consecutive numbers 1 ... 10, 11 ... 20, etc. up to 91 ... 100, mounting type: snapped, for terminal block width: 3.5 mm, lettering field size: 5.15 x 3.5 mm, Number of individual labels: 10

---

## ZBF 3,5,QR:FORTL.ZAHLEN - Zack Marker strip, flat

0801407

<https://www.phoenixcontact.com/in/products/0801407>

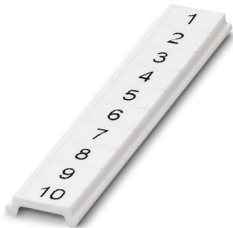

Zack Marker strip, flat, Strip, white, labeled, Printed vertically: consecutive numbers 1 ... 10, 11 ... 20, etc. up to 91 ... 100, mounting type: snapped, for terminal block width: 3.5 mm, lettering field size: 5.15 x 3.5 mm, Number of individual labels: 10

# MPT 1,5/S - Mini feed-through terminal block

3248100

<https://www.phoenixcontact.com/in/products/3248100>



## UCT-TMF 3,5 - Marker for terminal blocks

0829486

<https://www.phoenixcontact.com/in/products/0829486>



Marker for terminal blocks, Sheet, white, unlabeled, can be labeled with: TOPMARK NEO, TOPMARK LASER, BLUEMARK ID COLOR, BLUEMARK ID, BLUEMARK CLED, THERMOMARK PRIME, THERMOMARK CARD 2.0, THERMOMARK CARD, mounting type: snapped, for terminal block width: 3.5 mm, lettering field size: 2.7 x 4.7 mm, Number of individual labels: 108

---

## UCT-TMF 3,5 CUS - Marker for terminal blocks

0829644

<https://www.phoenixcontact.com/in/products/0829644>



Marker for terminal blocks, can be ordered: by sheet, white, labeled according to customer specifications, mounting type: snap into flat marker groove, for terminal block width: 3.5 mm, lettering field size: 2.7 x 4.7 mm, Number of individual labels: 108

# MPT 1,5/S - Mini feed-through terminal block

3248100

<https://www.phoenixcontact.com/in/products/3248100>



## MPS-MT - Test plugs

0201744

<https://www.phoenixcontact.com/in/products/0201744>



Test plugs, with solder connection up to 1 mm<sup>2</sup> conductor cross section, color: gray

---

## MPS-IH WH - Insulating sleeve

0201663

<https://www.phoenixcontact.com/in/products/0201663>

Insulating sleeve, color: white



# MPT 1,5/S - Mini feed-through terminal block

3248100

<https://www.phoenixcontact.com/in/products/3248100>



## MPS-IH RD - Insulating sleeve

0201676

<https://www.phoenixcontact.com/in/products/0201676>

Insulating sleeve, color: red



---

## MPS-IH BU - Insulating sleeve

0201689

<https://www.phoenixcontact.com/in/products/0201689>

Insulating sleeve, color: blue

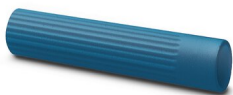

# MPT 1,5/S - Mini feed-through terminal block

3248100

<https://www.phoenixcontact.com/in/products/3248100>



## MPS-IH YE - Insulating sleeve

0201692

<https://www.phoenixcontact.com/in/products/0201692>

Insulating sleeve, color: yellow



---

## MPS-IH GN - Insulating sleeve

0201702

<https://www.phoenixcontact.com/in/products/0201702>

Insulating sleeve, color: green



# MPT 1,5/S - Mini feed-through terminal block

3248100

<https://www.phoenixcontact.com/in/products/3248100>



## MPS-IH GY - Insulating sleeve

0201728

<https://www.phoenixcontact.com/in/products/0201728>

Insulating sleeve, color: gray



---

## MPS-IH BK - Insulating sleeve

0201731

<https://www.phoenixcontact.com/in/products/0201731>

Insulating sleeve, color: black



# MPT 1,5/S - Mini feed-through terminal block



3248100

<https://www.phoenixcontact.com/in/products/3248100>

## PROJECT COMPLETE - Software

1050453

<https://www.phoenixcontact.com/in/products/1050453>

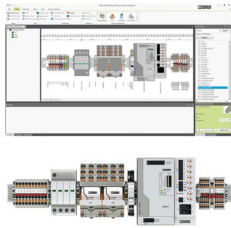

Intuitive planning and marking software for configuring terminal strips and for professional marking of marking materials for terminal blocks, conductors, cables, devices, and systems. The software is available for download

---

## PS-3,5 - Test plugs

3031010

<https://www.phoenixcontact.com/in/products/3031010>



Test plugs, Modular test plug, color: red



# MPT 1,5/S - Mini feed-through terminal block

3248100

<https://www.phoenixcontact.com/in/products/3248100>



## DP PS-3,5 - Spacer plate

3031011

<https://www.phoenixcontact.com/in/products/3031011>



Spacer plate, length: 15.9 mm, width: 3.5 mm, height: 33.5 mm, number of positions: 1, color: red

---

## PS-3,5/E - Test plugs

3031012

<https://www.phoenixcontact.com/in/products/3031012>



Test plugs, Individual test plug, color: red

---

Phoenix Contact 2023 © - all rights reserved  
<https://www.phoenixcontact.com>

PHOENIX CONTACT (I) Pvt. Ltd.  
A-58/2, Okhla Industrial Area, Phase - II, New Delhi-110 020

+91.1275.71420  
[info@phoenixcontact.co.in](mailto:info@phoenixcontact.co.in)