

REV.	DATE	DESCRIPTION
NC	06/05/03	INITIAL RELEASE

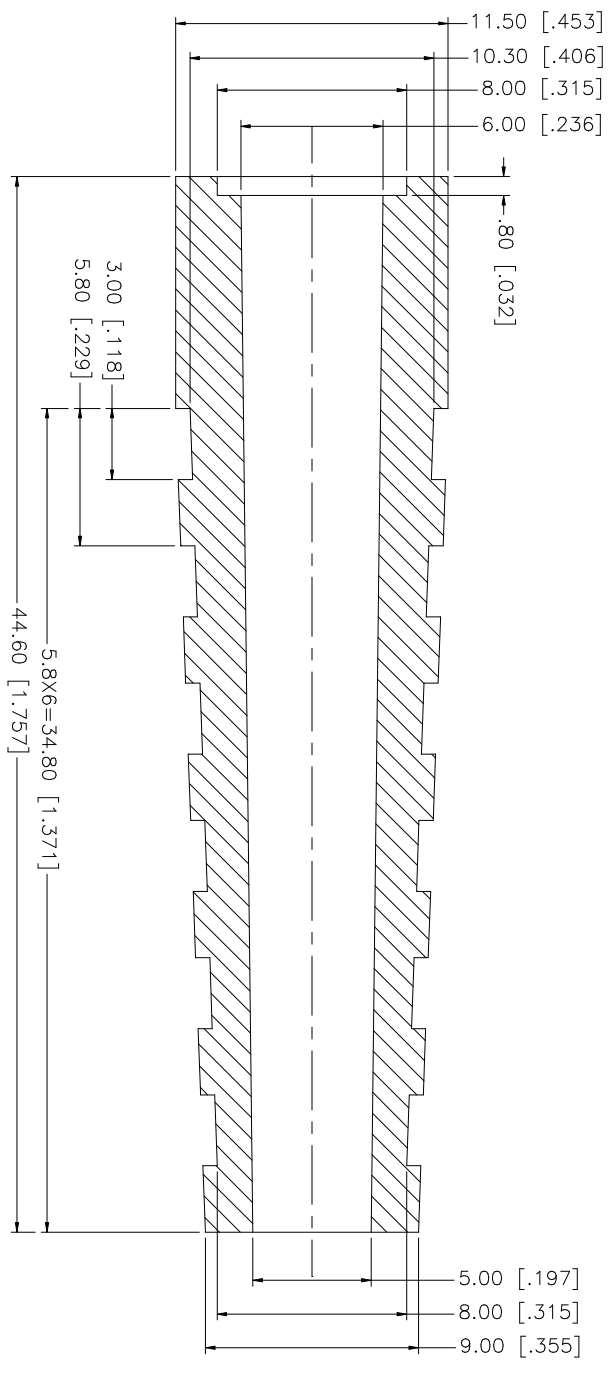

8																				
7																				
6																				
5																				
4																				
3																				
2																				
1																				
	DESCRIPTION	MATERIAL	FINISH	QTY																
	STRAIN RELIEF	PVC	OPTIONAL	1																

UNLESS OTHERWISE SPECIFIED, DIMENSIONS ARE IN MILLIMETERS. DIMENSIONS IN [] ARE IN INCHES AND FOR CUSTOMER REFERENCE ONLY.		APPROVALS	DATE
UNLESS OTHERWISE SPECIFIED, TOLERANCES FOR ALL DIMENSIONS ARE:		DRAWN	G.R.S.
0.5 - 8mm ± 0.20mm		CHECKED	06/05/03
8 - 30mm ± 0.40mm		ISSUED	
30 - 120mm ± 0.50mm		SHEET	1 OF 1
UNLESS OTHERWISE SPECIFIED, TOLERANCES FOR ANGLES ARE:		PART DESCRIPTION	
.020 - .315 = ± 0.007°		STRAIN RELIEF BOOT -58U	
.315 - 1.180 = ± 0.015°		PART NO.	
1.180 - 4.724 = ± 0.020°		60015-000	
DO NOT SCALE DRAWING		CAD FILE	DWG. NO.
		C:/MISC/60015-000.DWG	60015-000.DWG
		REV.	NC
		SIZE	A
		SCALE	NA

Amphenol Connex

STRAIN RELIEF BOOT -58U

60015-000