

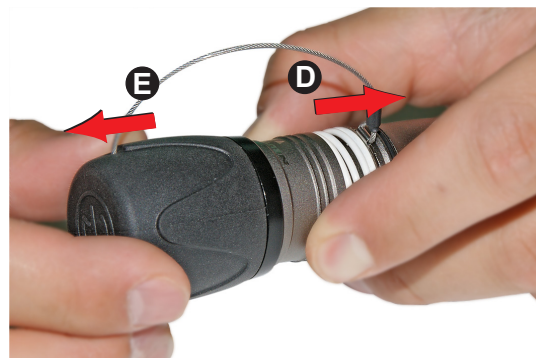

HANDLING INSTRUCTION

SCNO*X-R & SCNO-FDW-R | opticalCON protection covers

SCNO*X-R | opticalCON - cable connector cover

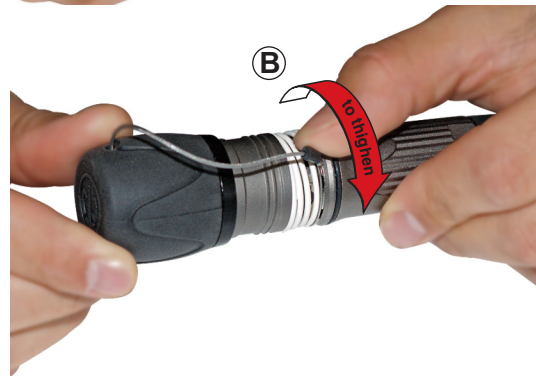
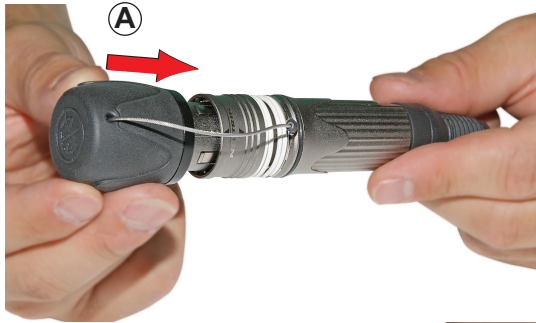

Mate protection cover

- Ⓐ Push the cover onto the connector front shell until it locks.
- Ⓑ Rotate the safety ring to tighten the steel cord around the connector body to protect the steel cord from damage.

FINISH

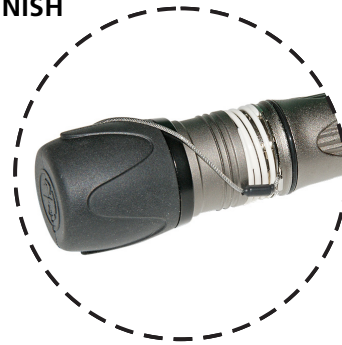

Protection cover removal

- Ⓒ Rotate the safety ring to lose the steel cord.
- Ⓓ Release the connector locking device.
- Ⓔ Remove protection cover.

FINISH





SCNO-FDW-R | opticalCON - chassis connector cover

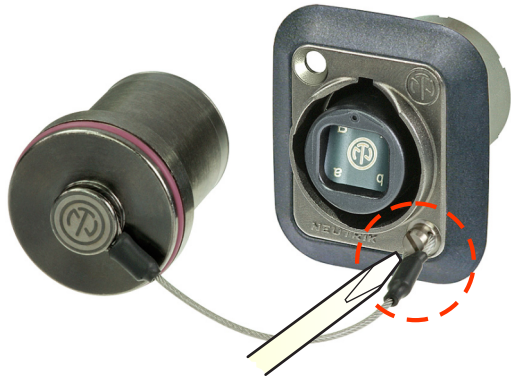

Dust cover assembly

- (A)** Mount steel cord onto the opticalCON chassis connector.

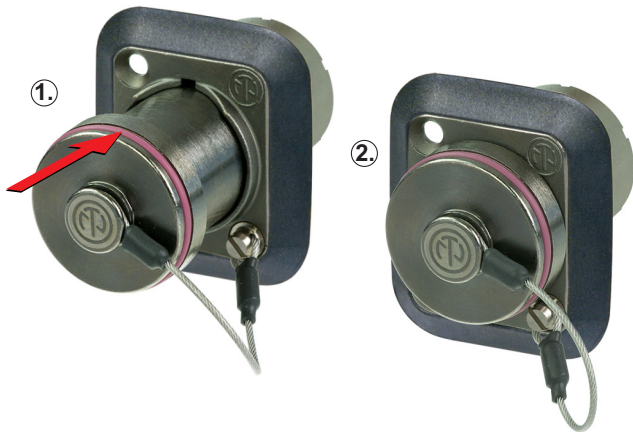

Dust cover handling

- (B)** Push the cover completely into the chassis until you feel a locking snap.

Applications example:



Cover application of chassis and cable connector (SCNO*X-R & SCNO-FDW-R).

- (B)** Mate cable connector and chassis connector cover to avoid contamination as long the connector is plugged.