



Interchangeable Line+Dot Optic 100° Fan Angle

1. Product Overview.

The Interchangeable line lens consists of a glass rod lens element fitted with in an 11mm diameter lens holder with an M9 thread section for mounting. The lens produces a line with a centre dot with a typical full fan angle of 100 degree with a 5mm by 1.5 mm input beam and the intensity distribution is gaussian in the width and gaussian in the line.

An M9 threaded section allows the lens assembly to simply screw into any laser module with a M9 thread for lens assembly and a suitable focal length collimator.

2. Specification.

Lens Material	Glass
Lens Type	Rod Lens
Exit Aperture	5mm
A/R Coated	No
Typical Input Beam Size	5 by 1.5mm
Typical Fan Angle	100°
Trpical Transmission Loss (650nm)	≤25%

3. Diagram.

Interchangeable Line + Dot Lens (100° Fan Angle)

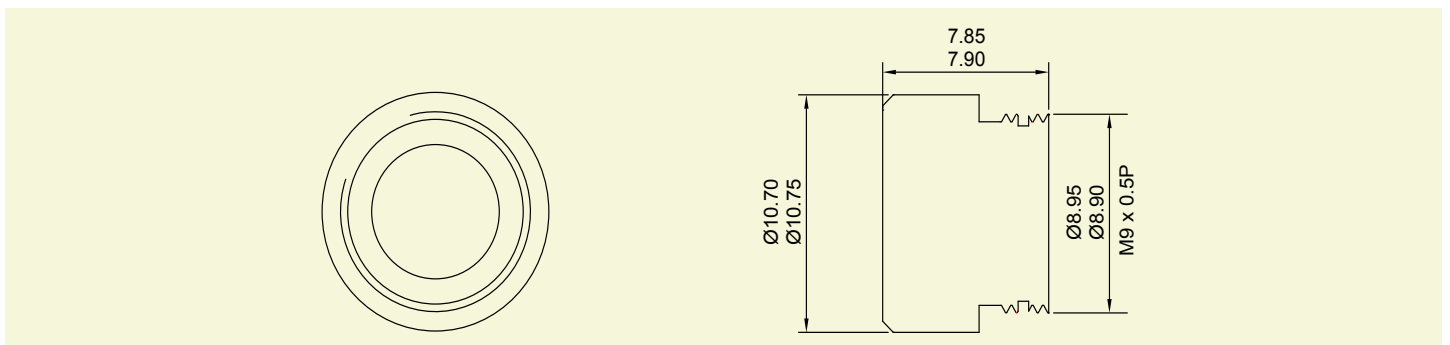

9090-02-041 Rev 1



Please Note: Global Laser reserve the right to change descriptions and specifications without notice.

T: +44 (0)1495 212213
F: +44 (0)1495 214004
E: sales@globalasertech.com
www.globalasertech.com

Global Laser Ltd, Cwmtillery Industrial Estate
Abertillery, Gwent NP13 1LZ UK