

Distance sleeves and spacers

distance sleeves with internal thread

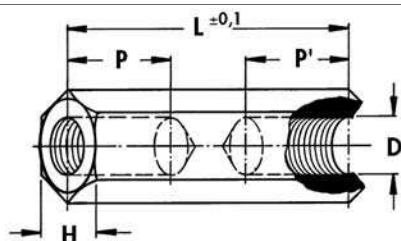

art. no.	dim. [mm]				
	P'	P	L	D/D'	H
ABM 2550 ...	–	=L	5/ 8/ 10/ 12/ 15	M 2.5	5
ABM 2550 ...	8	8	18	M 2.5	5
ABM 2550 ...	10	10	20/ 25/ 30/ 35/ 40/ 45/ 50	M 2.5	5
ABM 3050 ...	–	=L	5/ 8/ 9/ 10/ 12/ 13/ 15	M 3	5
ABM 3050 ...	8	8	16/ 18/ 19	M 3	5
ABM 3050 ...	10	10	20/ 25/ 29/ 30/ 35/ 40/ 45/ 50	M 3	5
ABM 4070 ...	–	=L	5/ 8/ 10/ 12/ 15	M 4	7
ABM 4070 ...	9	9	18	M 4	7
ABM 4070 ...	10	10	20/ 25/ 30/ 35/ 40/ 45/ 50	M 4	7
ABM 5080 ...	9	9	18	M 5	8
ABM 5080 ...	–	=L	5/ 8/ 10/ 12/ 15	M 5	8
ABM 5080 ...	10	10	20/ 25/ 30/ 35/ 40/ 45/ 50	M 5	8

... Please indicate length "L"
other lengths and threads on request

material	brass
surface treatment	6 µm nickel-plated, solderable

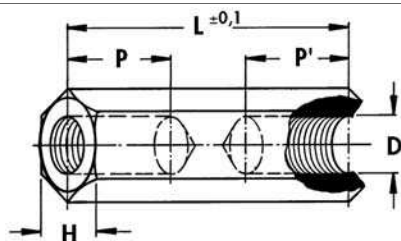

art. no.	dim. [mm]				
	P'	P	L	D/D'	H
ABP 2550 ...	–	=L	10	M 2.5	5
ABP 2550 ...	6	6	15/ 20/ 25/ 30	M 2.5	5
ABP 3060 ...	–	=L	10/ 12/ 15	M 3	6
ABP 3060 ...	8	8	20	M 3	6
ABP 3060 ...	10	10	25/ 30	M 3	6
ABP 4080 ...	–	=L	10/ 15/ 20	M 4	8
ABP 4080 ...	10	10	20	M 4	8

... Please indicate length "L"
other lengths and threads on request

material	polyamide, GF reinforced
temper. range	-30 °C ... +110 °C
colour	black

Distance sleeves for PCB's in HP grid → E 29
Spacers → E 30 – 31
Snap rivet → E 35
Mounting parts for heatsinks → E 40 – 41

Vibration dampers → E 32
Insulating distance sleeves → E 24 – 26
Insulating clamping parts → E 36
Mounting material for semiconduct. → E 35 – 39