

SECTION A-A
SCALE 1 : 2

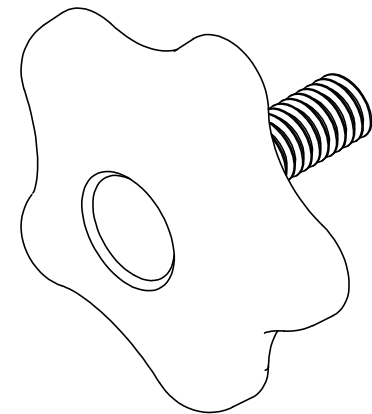

Actual Size

FOR CUSTOMER APPROVAL ONLY				REV	BY	DATE	COMMENT	DIMENSIONS ARE IN INCHES TOLERANCES FRACTIONAL ± TWO PLACE DECIMAL ± 0.03 THREE PLACE DECIMAL ± 0.010 UNLESS OTHERWISE NOTED	DRAWN	VRR	
NAME:	0	MTO	05/15/06				RELEASE DATE	APPROVED	LQR		
	1	VRR	05/19/14				Changed to Solidworks format	DATE	05/19/2014		2.25" Star Knob, 3/8-16 X 1.00" Steel Zinc Stud.
TITLE:								COMMENTS			
DATE:								Material Usage:			
								0.02370611 pounds			
SIGNATURE:	PROPRIETARY AND CONFIDENTIAL THE INFORMATION CONTAINED IN THIS DRAWING IS THE SOLE PROPERTY OF INNOVATIVE COMPONENTS. ANY REPRODUCTION IN PART OR AS A WHOLE WITHOUT THE WRITTEN PERMISSION OF INNOVATIVE COMPONENTS IS PROHIBITED.							KNOB MATERIAL	Polypropylene, Black	INSERT MATERIAL	Steel
								KNOB FINISH	Textured	INSERT FINISH	Zinc
								INSERT PART NUMBER	BT6C1250HU---21		
								PART NUMBER	KN6C10005S4--21	DRAWING NUMBER	05-01-14 R1
								SCALE 1:1		SHEET 1 OF 1	

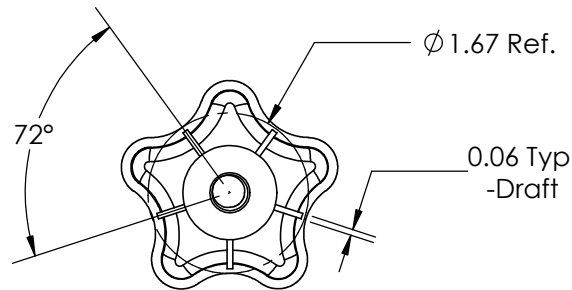
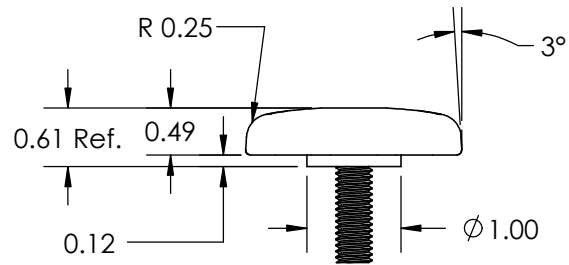
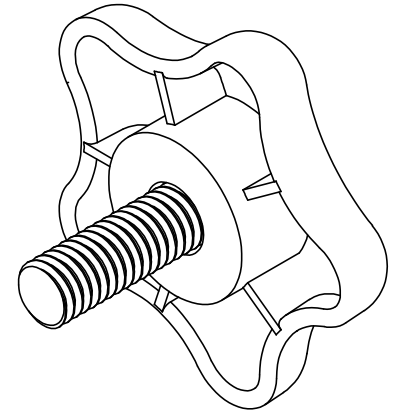