



# TECHNICAL MANUAL

Mounting base  
for thermal overload  
relay RTE EKF

## 1 DESCRIPTION

Mounting base for thermal overload relay RTE EKF is designed for thermal relay installation onto a mounting plate or DIN-rail apart from the contactor.

Thermal overload relay RTE and mounting base compatibility is specified in Table 1.

Mounting base for thermal overload relay RTE 1304-1322 EKF	mb-1304-1322 0,4-25A	rel-1304-0.4-0.63	RTE-1304 0,4-0,63A EKF
		rel-1305-0.63-1	RTE-1305 0,63-1A EKF
		rel-1306-1-1.6	RTE-1306 1-1,6A EKF
		rel-1307-1.6-2.5	RTE-1307 1,6-2,5A EKF
		rel-1308-2.5-4	RTE-1308 2,5-4A EKF
		rel-1310-4-6	RTE-1310 4-6A EKF
		rel-1312-5.5-8	RTE-1312 5,5-8A EKF
		rel-1314-7-10	RTE-1314 7-10A EKF
		rel-1316-9-13	RTE-1316 9-13A EKF
		rel-1321-12-18	RTE-1321 12-18A EKF
		rel-1322-17-25	RTE-1322 17-25A EKF
Mounting base for thermal overload relay RTE 2353-2355 EKF	mb-2353-2355 23-40A	rel-2353-23-32	RTE-2353 23-32A EKF
		rel-2355-30-40	RTE-2355 30-40A EKF
Mounting base for thermal overload relay RTE 3353-3365 EKF	mb-3353-3365 23-93A	rel-3353-23-32	RTE-3353 23-32A EKF
		rel-3355-30-40	RTE-3355 30-40A EKF
		rel-3357-37-50	RTE-3357 37-50A EKF
		rel-3359-48-65	RTE-3359 48-65A EKF
		rel-3361-55-70	RTE-3361 55-70A EKF
		rel-3363-63-80	RTE-3363 63-80A EKF
		rel-3365-80-93	RTE-3365 80-93A EKF

Mounting base for thermal overload relay RTE complies with IEC 60947-4-1:2018.

## 2 TECHNICAL DATA

Main technical data are listed in Tables 1 and 2.

Table 2

Parameter	Value		
	Mounting base for thermal overload relay RTE 1304-1322 EKF	Mounting base for thermal overload relay RTE 2353-2355 EKF	Mounting base for thermal overload relay RTE 3353-3365 EKF
Weight, g	53	70	203
Operating temperature, °C	From -25 to +50		
Type of connection	Screw terminals		
Cross-section of connected wires, mm <sup>2</sup>	1,5-10	2,5-10	16-35
Tightening torque, N•m	2,5	2,5	4,0
Abnormal heat and fire resistance	Self-extinguishing material		

### 3 OVERALL DIMENSIONS

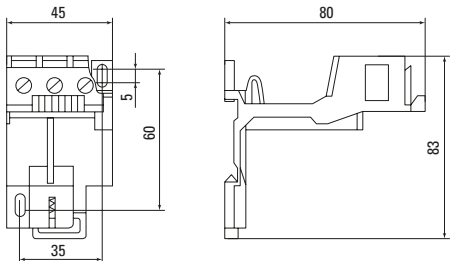

Fig. 1 - Overall dimensions of mounting base for thermal overload relay RTE 1304-1322 EKF

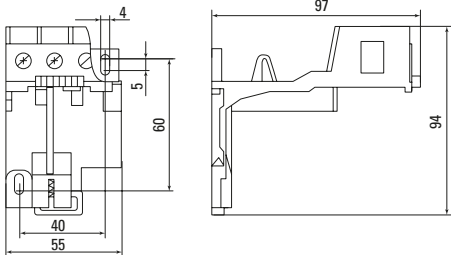

Fig. 2 - Overall dimensions of mounting base for thermal overload relay RTE 2353-2355 EKF

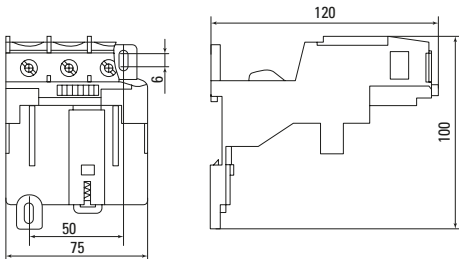

Fig. 3 – Overall dimensions of mounting base for thermal overload relay RTE 3353-3365 EKF

#### 4 INSTALLATION AND OPERATION

Mounting bases for thermal overload relay shall be mounted and connected by qualified electrical personnel.

Position in space — vertical on a vertical plane.

Operating temperature: from  $-25\text{ }^{\circ}\text{C}$  to  $+50\text{ }^{\circ}\text{C}$ .

Operating environment: non-explosive and non-corrosive.

Rated operating mode — continuous.

#### 5 DELIVERY SCOPE

Mounting base for thermal overload relay RTE — 1 pc.

For all available documentation, scan the QR-code on the insert or on the inside of the package.

#### 6 SAFETY REQUIREMENTS

**WARNING!** Make sure the power is off before installation, connection and commissioning!

Do not operate mounting bases with visual mechanical damage.

#### 7 MAINTENANCE

7.1 For maintenance, follow national safety rules for operation of electrical Installations.

7.2 Under normal operating conditions, visually inspect mounting bases for thermal overload relay, and tighten screw terminals every 6 months.

## 8 TRANSPORTATION AND STORAGE

8.1 Mounting bases for thermal overload relay can be transported by any means of enclosed transport that ensures protection of packed products from mechanical impacts and weather exposure.

8.2 Mounting bases for thermal overload relays shall be stored in the original package indoors at the ambient temperature from  $-40\text{ }^{\circ}\text{C}$  to  $+70\text{ }^{\circ}\text{C}$  and relative humidity of max. 98% at  $+25\text{ }^{\circ}\text{C}$ .

## 9 DISPOSAL

Life-expired and failed products shall be disposed of in compliance with the national and local laws and regulations in force.

To dispose of the product, send it to an authorized company for recycling in compliance with the national and local laws and regulations in force.

## 10 MANUFACTURER'S WARRANTY

The manufacturer guarantees that mounting bases for thermal overload relay RTE EKF comply with the requirements of IEC 60947-4-1:2018, provided that consumers follow the operation, transportation and storage conditions.

**Warranty period:** 7 years from the date of sale specified in the sales receipt.

**Shelf life:** 7 years from the date of manufacture specified on the product package or housing.

**Service life:** 10 years.

**Manufacturer:** for information, refer to the product package.

**Importer and EKF trademark service representative:** EKF ELECTRICAL SOLUTION – FZCO, Dubai Silicon Oasis, DDP, Building A2, Dubai, United Arab Emirates.

**Importer and EKF trademark service representative on the territory of the Russian Federation:** OOO «Electroresheniya», Otradnaya st., 2b bld. 9, 5th floor, 127273, Moscow, Russia. Tel.: +7 (495) 788-88-15.

**Importer and EKF trademark service representative on the territory of the Republic of Kazakhstan:** TOO «Energoresheniya Kazakhstan», Kazakhstan, Almaty, Bostandyk district, Turgut Ozal st., 247, apt 4.

## 11 CERTIFICATE OF ACCEPTANCE

Mounting bases for thermal overload relays RTE EKF comply with IEC 60947-4-1:2018 and have been approved for operation.

Date of manufacture: for information, refer to the product package.

Technical control stamp



**EAC**



v3

[ekfgroup.com](http://ekfgroup.com)

**W  
K  
E**