

REV.	ECN NO.	REVISIONS	DRN.	CKD.	APP.	DATE
A		NEW RELEASE		TWC		

OPERATING CHARACTERISTICS AT $T_A = 25^\circ\text{C}$	
LED CHARACTERISTICS	TEST CONDITIONS
LUMINOUS INTENSITY	$I_F = 2 \text{ mA}$
PEAK WAVELENGTH	$I_F = 7 \text{ mA}$
DOMINANT WAVELENGTH	
FORWARD VOLTAGE	$I_F = 2 \text{ mA}$
VIEWING ANGLE (2θ)	

ASSEMBLY NUMBER	LENS COLOR	DIM. "A"
550-1107F	RED DIFFUSED	.197
550-1207F	YELLOW DIFFUSED	.197
550-1307F	GREEN DIFFUSED	.197

LED CHARACTERISTICS	RED			YELLOW			GREEN			UNITS	TEST CONDITIONS
	MIN.	TYP.	MAX.	MIN.	TYP.	MAX.	MIN.	TYP.	MAX.		
LUMINOUS INTENSITY	1.5	1.2	1.2	1.2	1.2	1.2	1.2	1.2	1.2	mcd	$I_F = 2 \text{ mA}$
PEAK WAVELENGTH	635	583	565	583	565	565	565	565	565	nm	$I_F = 7 \text{ mA}$
DOMINANT WAVELENGTH	620										
FORWARD VOLTAGE	626									V	$I_F = 2 \text{ mA}$
VIEWING ANGLE (2θ)	633									DEG	

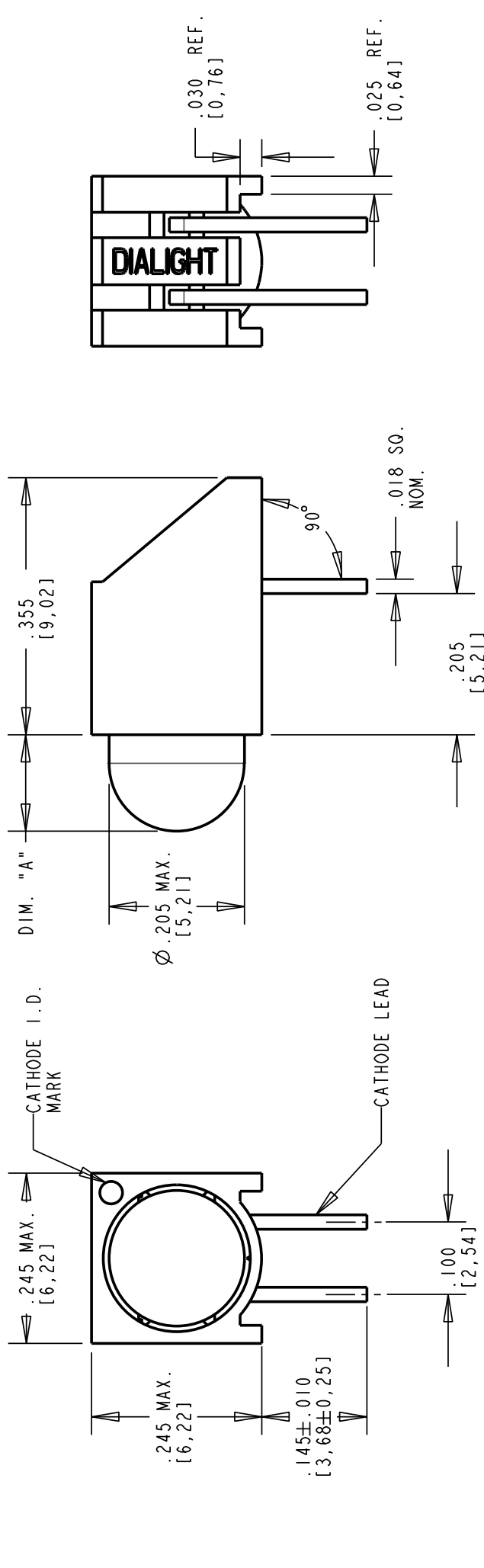
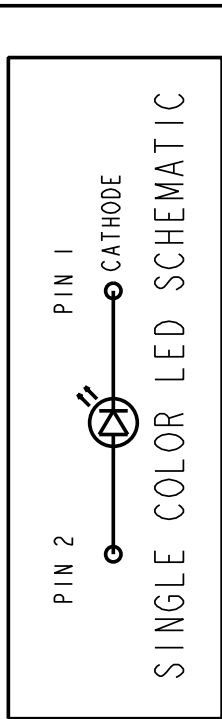

NOTES:

- LAMP MUST BE SEATED ALL THE WAY DOWN INTO HOUSING. BENDS MUST BE TIGHT, NO LONGITUDINAL TRAVEL ALONG AXIS ALLOWED.
- LEADS TO BE FREE OF DEFORMATION AFTER BENDING AND CUTTING.
- LED LEAD DIMENSIONS SHOWN ARE MEASURED AT HOUSING EXIT.
- THIS ASSEMBLY CONTAINS ELECTROSTATIC DISCHARGE SENSITIVE DEVICES (ESDS). MAINTAIN ALL PRECAUTIONARY MEASURES DURING ASSEMBLY, HANDLING AND STORAGE IN ACCORDANCE WITH IPC-A-610.
- DIALIGHT PART NUMBER: 550-1107F, -1207F, -1307F

RoHS Compliant 550-1X07F Thru hole CBI

Part Numbers with the "F" suffix ending are RoHS Compliant.
 Example: 550-1107F
 The bag packaging is marked with "RoHS Compliant" label or equivalent markings.
 Parts can be wave soldered, dip soldered or hand soldered using typical lead-free soldering process with max 260°C temp. for 5 sec.

RECOMMENDED PC BOARD HOLE PATTERN

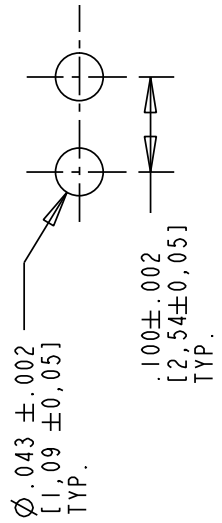

ABSOLUTE MAXIMUM RATINGS AT $T_A = 25^\circ\text{C}$

PARAMETER	LED COLOR			UNITS
	RED	YELLOW	GREEN	
POWER DISSIPATION	24	36	24	mW
DC AND PEAK FORWARD CURRENT	7	7	7	mA
TRANSIENT FORWARD CURRENT (10 mSEC PULSE)	500	500	500	mA
DERATING LINEARLY FROM 92°C	1.0	1.0	1.0	mA/°C
REVERSE VOLTAGE ($I_r = 50\mu\text{A}$)	5			V
SOLDERING TEMPERATURE (.063 IN. FROM BODY)	260°C FOR 5 SEC.			°C
OPERATING TEMPERATURE	-55 TO +100			°C
STORAGE TEMPERATURE	-55 TO +100			°C



THIS DRAWING AND THE CONTENTS HEREIN ARE CONFIDENTIAL AND THE SOLE PROPERTY OF DIALIGHT. REPRODUCTION OF THIS DRAWING OR CONSTRUCTION OF ANY PARTS WITHIN THIS DRAWING ARE FORBIDDEN WITHOUT THE WRITTEN CONSENT OF DIALIGHT.	
SCALE: 5.000	DRAWING NUMBER
ALL DIM'S IN: INCHES (MM)	C-17400
TOLERANCES: UNLESS OTHERWISE SPECIFIED	REV
FRACTIONS: $\pm 1/64$	A
DECIMALS (.XX): $\pm .01$	TITLE
DECIMALS (.XXX): $\pm .005$	5mm LED SLOPED BACK
DECIMALS (.XXXX): $\pm .0005$	RoHS COMPLIANT
ANGLES: $\pm 1^\circ$	MATERIAL
FINISH:	
FSCM 83330	SHEET 1 OF 1
	FAMILY TABLE:
	1501 ROUTE 34 SOUTH
	FARMINGDALE, NJ 07727

