

TYPE	CIRCUIT CHARACTERISTIC																
	CODE	POSITION ● ON															
		0	1	2	3	4	5	6	7	8	9	A	B	C	D	E	F
DRR 3016	1		●		●		●		●		●		●		●		●
	2			●	●			●	●			●	●			●	●
	4					●	●	●	●					●	●	●	●
	8									●	●	●	●	●	●	●	●

P.C.B. LAYOUT

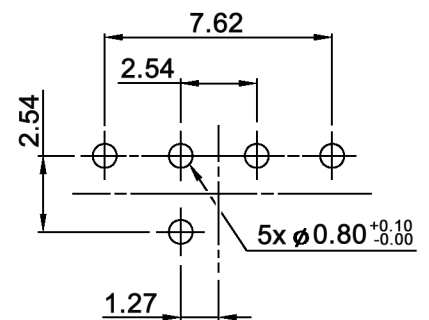

Compliance: RohS II (2011/65/EU)

Tolerances: ±0.20mm max.	Date	Name
	12/07	dr
Specifications	02/09	dr
Dimensions	02/09	dr
Operating temperature	04/08	dr
Modifications	Date	Name

DRR 3016

30 13 14

Page

1/2

knitter-switch

