

Visual Signals LIGHT EMITTING DIODE BEACONS

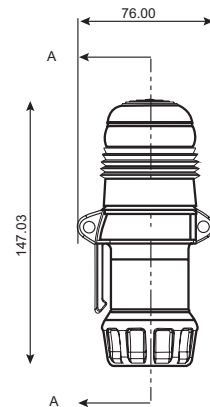

E-Flare - 350 LED Portable Beacon Series >

Product overview

Suitable for a wide range of applications the E-Flare beacon has been designed with versatility in mind. The unit provides a highly visible warning zone, day or night. These beacons are single colour only and incorporate a failsafe activation switch to prevent

accidental turn on or off. The units are powered by four 'AA' Cell Alkaline batteries (not supplied) that will provide at least 30 hours of peak brightness operation. See below for the range of accessories for the E-Flare portable beacon. The units are supplied with a lanyard (as standard) for hanging/wearing the unit.

Features

- LED long life
- Shock resistant
- Ultra quick installation
- Versatile accessory options
- 30 hours life
- 360° visibility
- IP66

Material

- UV Stable Polycarbonate Lens
- UV Stable ABS Body

Code No: Voltage: Light Source:

LED-P-EF350-01	3v Dc ---	4 LEDs
LED-P-EF350-02	3v Dc ---	4 LEDs



50170 Standard Base 50171 Aviation Base

Accessories



50172 Magnetic Clip 50173 Cone Clip 50174 Magnetic Base 50176 Suction Cup 50177 Daylight Hood 50178 Carry Bag



Kg 0.16 Beacon

°C -20+50

IP 66

FPM 160

INDUSTRIAL

AUTOMOTIVE

APPROVED AND CONFORMITIES



ADD THE FOLLOWING LENS CODES TO THE PRODUCT WHEN ORDERING

01 02

MARINE