

This document is the property of Amphenol Corporation and is delivered on the express condition that it is not to be disclosed, reproduced or used, in whole or in part, for manufacture or sale by anyone other than Amphenol Corporation without its prior consent, & that no right is granted to disclose or to use any information in this document.

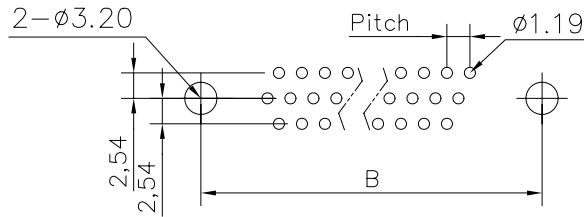
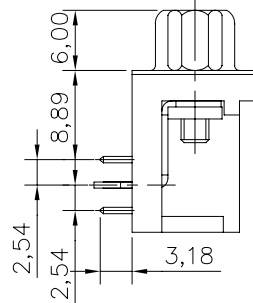
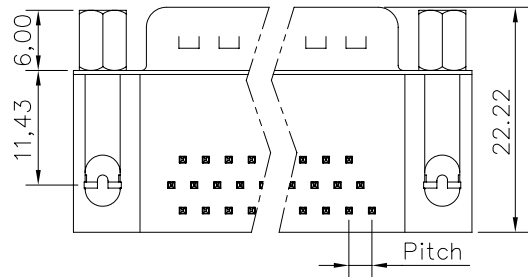
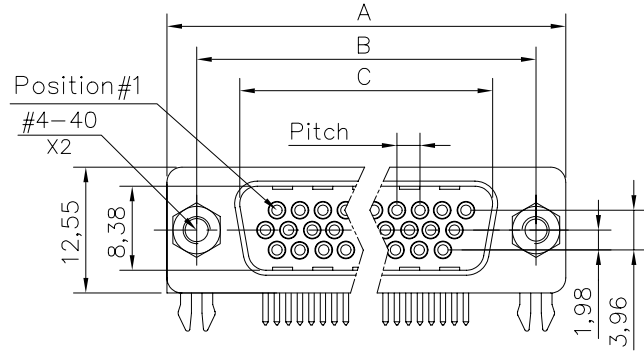

RECOMMENDED P.C.B LAYOUT
(TOLERANCE +/-0.03)

Customer drawing

DIM.S	SHELL	A	B	C	Pitch
15		30.84	24.99	16.92	2.29
26		39.24	33.32	24.70	2.29
44		53.04	47.04	38.96	2.29
62		69.34	63.50	55.42	2.41

REVISIONS				
SYM	ECN	DESCRIPTION	DATE	APPROVED
1			04/14/08	

D-SUB TECHNICAL DATA

SHELL : Steel, 100u" min tin over 50u" min nickel
 BODY : Glass filled thermoplastic.
 CONTACTS : Brass
 Gold flash over 1.25um (50u") min nickel on mating area.
 100u" min tin over 50" min nickel on solder area
 BOARDLOCK : Brass, 50u" min nickel
 SCREWLOCK : Brass, 50u" min nickel
 ELECTRICAL : Voltage rating 600 V Rms to 50 Hz
 Current rating 3A
 Withstanding Voltage >1000 V Rms to 50 Hz for one minute
 Insulation resistance >5000 M Ohms
 Contact resistance 20 mOhms max.
 CLIMATIC : Temperature range -55 °C up to 125°C
 MARKING : Amphenol...(Series NO.)
 Commercial reference
 Manufacturing date

PRODUCT CODE

L 717HD X XX P D1 CH 4F

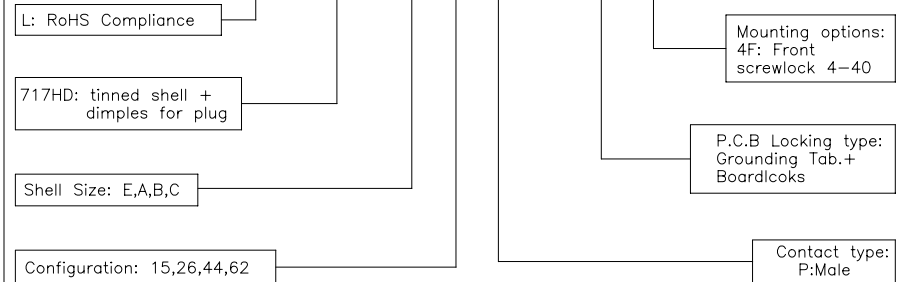

UNLESS OTHERWISE SPECIFIED TOLERANCES		APPROVAL	DATE
.X	+/-	DRAWN	Christine.cui 04/14/08
.XX	+/-	CHECKED	Lik.wang 04/14/08
.XXX	+/-	CHECKED	
FRACTIONS	+/-		
ANGLES	+/-		
FOR MATERIALS AND FINISHES SEE NOTES		DRAWING FILE :	
REMOVE SHARP EDGES		ANGLE OF PROJECTION	
DIMENSIONS			
U.S.	INCHES		
METRIC	MM		

Amphenol®		
TITLE		
Stamped contact, HD series		
SIZE	DRAWING NO	REV.
A4	C L717HDXXXPD1CH4F	1
SCALE	N/A	SHEET 1 OF 1