

MMCX7-J-P-GF-RA-TH1



MMCX7-J-P-GF-ST-TH1



MMCX7-P-P-GF-ST-TH1

MMCX7 SERIES

75 Ω MICRO-MINI SYSTEMS

SPECIFICATIONS

For complete specifications and recommended PCB layouts see www.samtec.com?MMCX7-TH

- Shell Material:** Brass
- Insulator Material:** PTFE
- Contact Material:** BeCu
- Pin Material:** Brass
- Operating Temp Range:** -65 °C to +125 °C
- Impedance:** 75 Ω
- Dielectric Withstanding Voltage:** 500 Vrms, 50 Hz
- Dielectric Working Voltage:** 170 Vrms, 50 Hz
- Frequency Range:** 0-6 GHz
- RoHS Compliant:** Yes

PROCESSING

Lead-Free Solderable: Yes

MMCX7

GENDER

TYPE

PLATING

ORIENTATION

TERMINATION

Mates with:
MMCX7-P, RF179,
GRF7H-C

-J
= Jack

-P
= PCB Mount

-GF
= 10 μ" (0.25 μm) Gold center contact,
3 μ" (0.08 μm) Gold outer contact

-RA
= Right-angle

-ST
= Straight

-TH1
= Through-hole

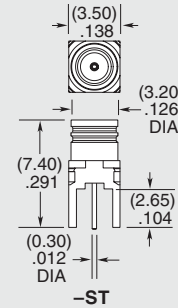
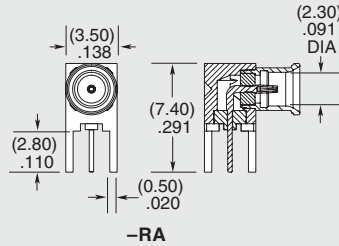

OTHER SOLUTIONS

- 75 Ω Cable Components available
- Contact Samtec.

MMCX7

GENDER

TYPE

PLATING

ST

TH1

Mates with:
MMCX7-J, RF179,
GRF7H-C

-P
= Plug

-P
= PCB Mount

-GF
= 10 μ" (0.25 μm) Gold center contact,
3 μ" (0.08 μm) Gold outer contact

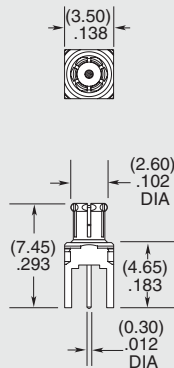

Due to technical progress, all designs, specifications and components are subject to change without notice.

Mouser Electronics

Authorized Distributor

Click to View Pricing, Inventory, Delivery & Lifecycle Information:

[Samtec:](#)

[MMCX7-P-C-GF-RA-CA3](#) [MMCX7-P-C-GF-ST-CA3](#) [MMCX7-J-P-GF-ST-TH1](#) [MMCX7-J-P-GF-RA-TH1](#) [MMCX7-J-C-GF-ST-CA3](#) [MMCX7-P-P-GF-ST-TH1](#) [MMCX7-P-C-HF-RA-CA3](#) [MMCX7-P-C-HF-ST-CA3](#) [MMCX7-J-P-HF-ST-TH1](#)