

7000 Push Button Switches 16A 250Vac



- ▶ Round and rectangular push button switches
- ▶ Ratings up to 16A, 250V ac
- ▶ Latching and momentary
- ▶ Illuminated & non-illuminated
- ▶ Matching indicators
- ▶ Low profile version
- ▶ Panel cut outs:
25.0 dia
27.2 x 22.3



16(4)A 250Vac T125
8(8)A 250Vac T85



UL CSA 16A Non Ind, 250Vac 1hp, 125Vac 1/2hp
UL 65°C, file no. E45221, CSA file no. LR10990



RoHS compliant

3mm contact gap.
Technical data on pages 4 & 5 (switches), 6 (indicators).

NON-LIT		LIT	
B BLACK	B BLACK	A AMBER	2 125V NEON
R RED	R RED	C CLEAR	3 250V NEON
W WHITE	W WHITE	G GREEN	7 12V INCANDESCENT
		R RED	

C 7053 A F W R 2 -----

ORDER FORMAT

TERMINAL CODE FUNCTION CODE ACTUATOR CODE BODY CODE BODY COLOR ACTUATOR COLOR LAMP VOLTAGE IF REQUIRED LEGEND & OPTIONS

TERMINAL	FUNCTION			ACTUATOR
C 6.3 x 0.8 9.1	7000		Single pole ON - OFF	A Round actuator shown in F body
	7001		Single pole ON - OFF (momentary ON)	A Round actuator shown in G body
	7003		Single pole ON - OFF with light	B Round actuator - medium shown in F body
	7004		Single pole ON - OFF (momentary ON) with light	C Round actuator - long shown in F body
	7050		Double pole ON - OFF	D Round actuator - sub panel mount
	7051		Double pole ON - OFF (momentary ON)	S Rectangular actuator Shown in "A" body N/A for 7030
	7053		Double pole ON - OFF with light	
H 4.8 x 0.8 9.1	7054		Double pole ON - OFF (momentary ON) with light	
	7030		Indicator 	



C7000AF ---



C7003AF ---



C7053CF ---



C7053BF ---

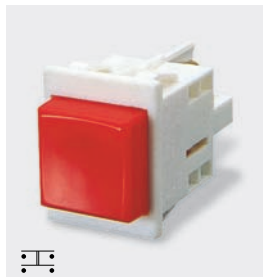

C7050SA ---



C7053AG ---



C7053DF ---



C7030AH ---

push switches

BODY

Panel cut-outs

F H G Body types fit either cut-out

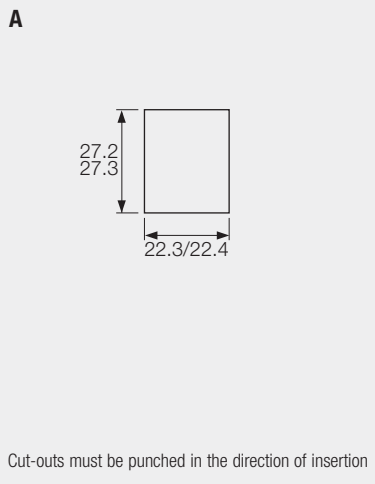
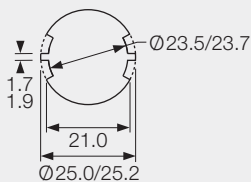
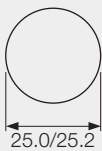

OPTIONS

Finish
 Matt finish is standard on bodies
 Gloss finish is standard on actuators

Color
 Call factory for custom colors
 A full range is available for large orders

Legend printing
 A wide range is available or call the factory for custom legends

Lamp voltage
 Call factory for details of other available voltages

Weatherproof housing (E)
 Additional housing which fits round body switches with an oversize housing with a clear silicone cover designed to IP65. Mounting hole dia: 38.0mm

DIMENSIONS (mm)

Panel thickness:
A 0.8 - 2.5mm
F, G, H 0.8 - 5.0mm

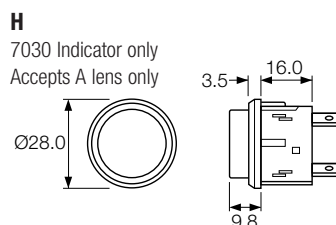
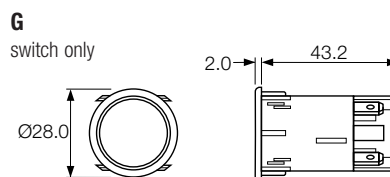
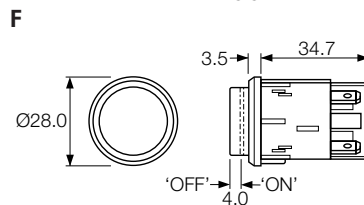
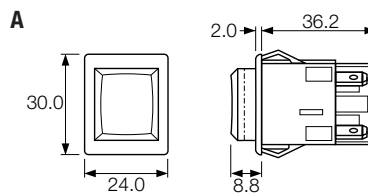

Mouser Electronics

Authorized Distributor

Click to View Pricing, Inventory, Delivery & Lifecycle Information:

[Bulgin:](#)

[C7053AFNAB](#) [C7053AFNAA](#) [C7053AFNAC](#)