

DRAWING MADE IN TRIED AND TRUE PRODUCTION
 THIS DRAWING IS UNPUBLISHED.
 © AMP CORP. 1982

REV	DATE	BY	CHK	APP	DESCRIPTION
1	1-92	AT			REDRAWN & REVISED, EGN B05681
2					REVISED PER EGN B05685

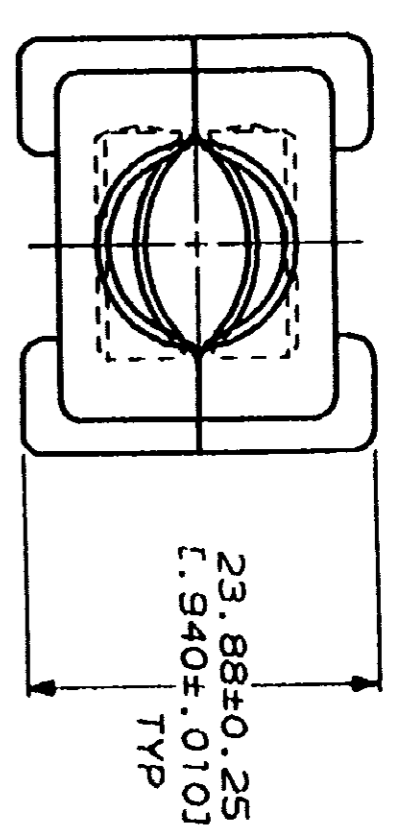

13.46 MAX DIA CABLE
 L.530J

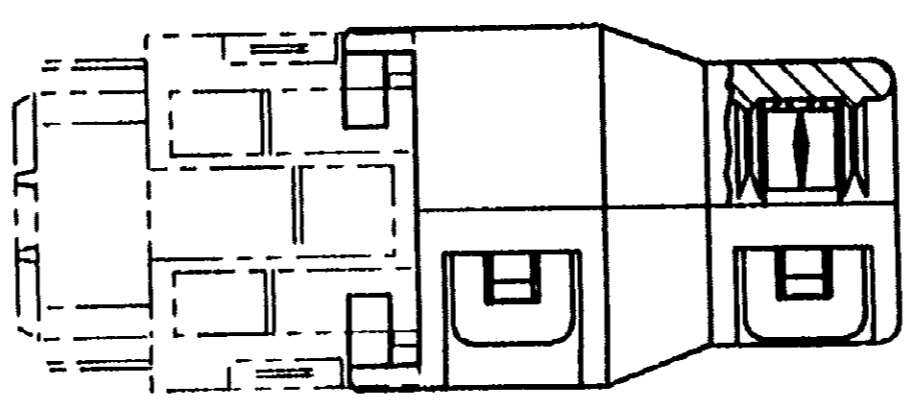

ASSEMBLED VIEW

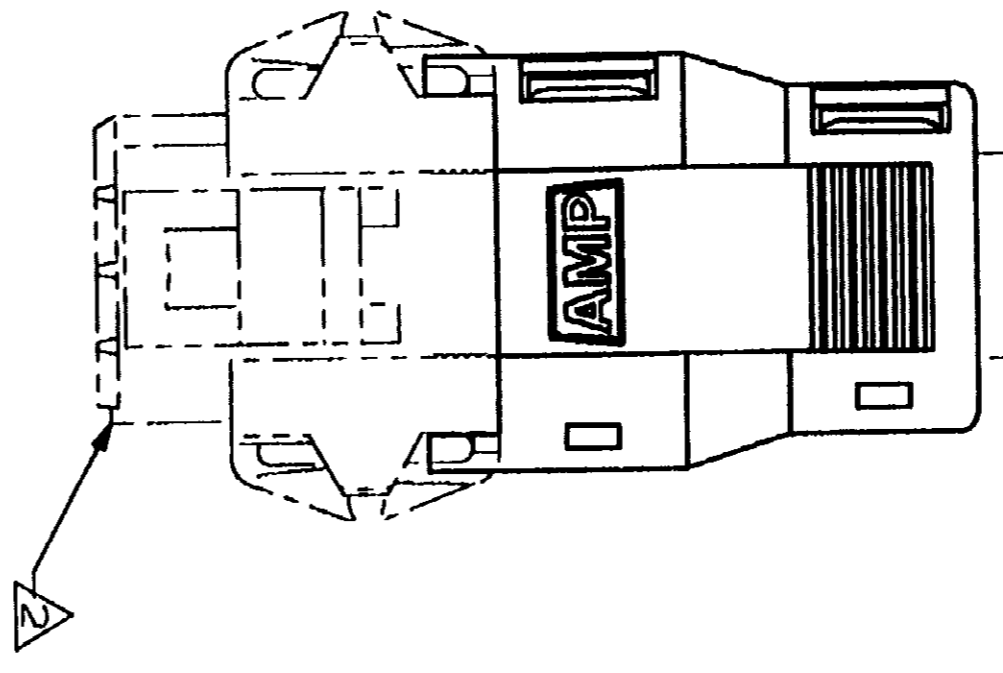

- 1 A VARIETY OF CABLE GATES ARE PROVIDED TO ACCOMMODATE A VARIETY OF CUSTOMER CABLE SIZES.
- 2 PLUG SHOWN FOR REFERENCE ONLY, STRAIN RELIEF CAN BE USED ON EITHER PLUG OR RECEPTACLE.

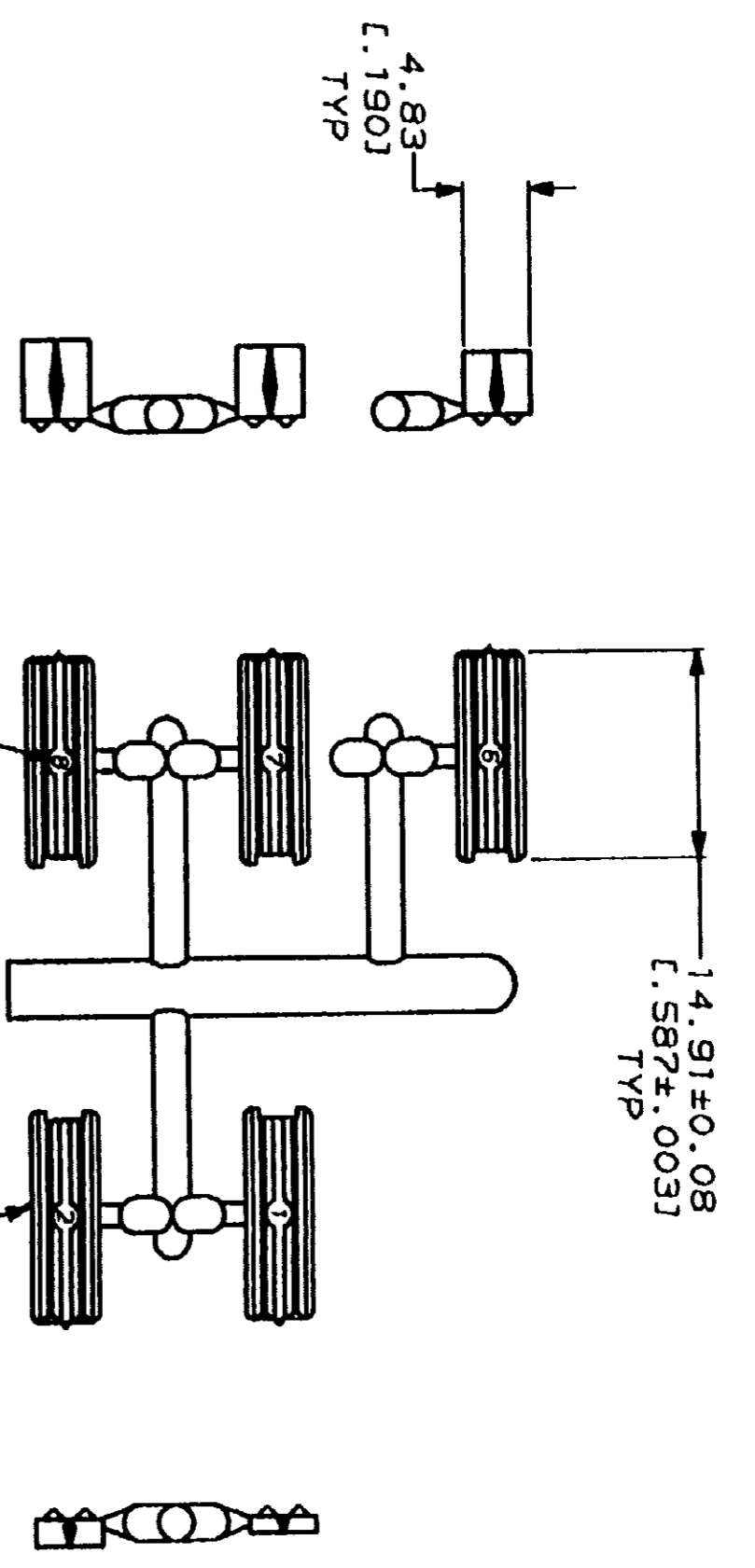

CABLE GATE NO. 8 PLC
 CABLE GATE, SUPPLIED ON CLUSTER AS SHOWN,
 2 EA

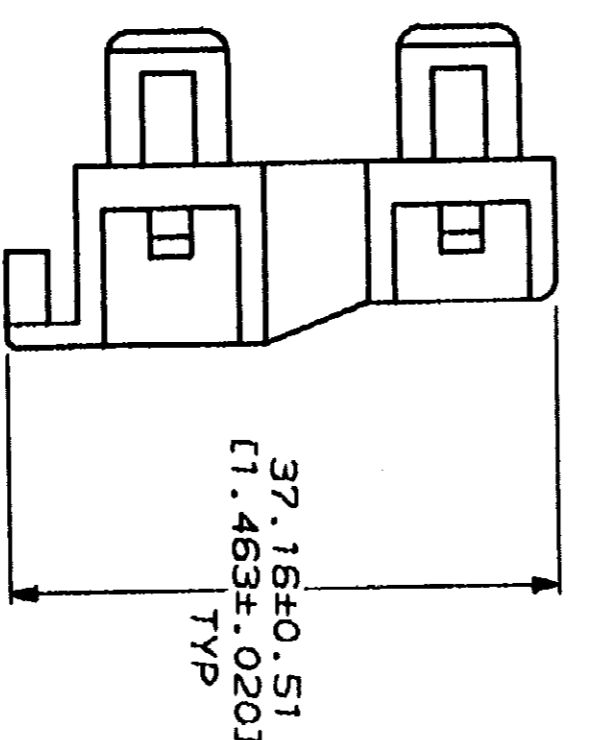

32.38±0.38
 L.275±.015J

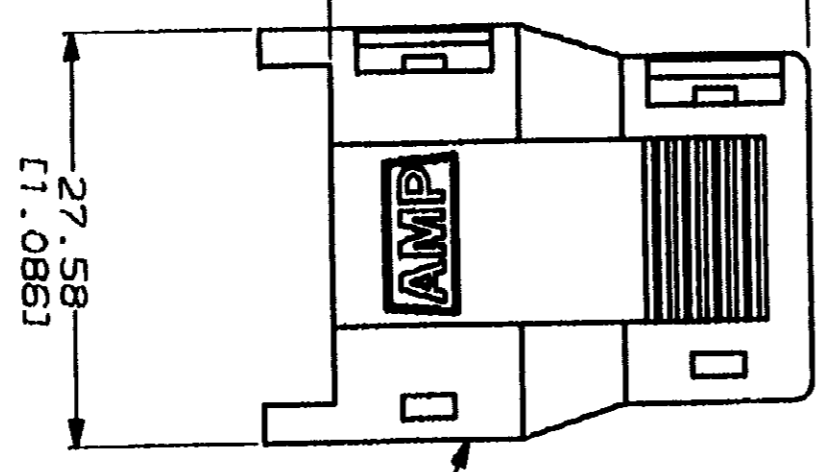

HOUSING, STRAIN RELIEF
 2 EA

DO NOT SCALE PRINT. UNLESS SPECIFIED (DIMENSIONS) TOLERANCES IN MILLIMETERS 3 P.L.C. DEC ± 0.131(0.005) ANGLES PATTERNS		DR 1-28-83 1 INCHES CHK 1-28-83 R 3106 APPD 1-31-82 1-31-82 PRODUCT SPEC 108-10003	NAME AMP AMP Incorporated Northampton, PA 17105-3608
FINISH NYLON, NATURAL RED	APPLICATION SPEC 108-10003	SIZE D 00779	DRAWING NO 207602
SCALE 2:1		SHEET 1 OF 1	

PART NO
207602-1

CUSTOMER DRAWING