

**MICRO SWITCH**

MADE IN ILLINOIS U.S.A.  
A DIVISION OF HONEYWELL  
FED. MFG. CODE 91929

**SWITCH-TOGGLE**

CATALOG LISTING  
**11TW1 SERIES**  
CHART 1 ★

MILITARY PART NUMBER

CATALOG LISTING

CIRCUIT MADE WITH TOGGLE LEVER IN

KEYWAY SIDE (1-2)	CENTER (1-2)	OPPOSITE KEYWAY (2-3)
-------------------	--------------	-----------------------

ELECTRICAL DATA

CODE L117 5A-125 VAC



CODE L117 5A-125 VAC



MS 27718-21-1	11TW1-1	ON	OFF	ON
MS 27718-22-1	11TW1-2	OFF	NONE	ON
MS 27718-23-1	11TW1-3	ON	NONE	ON
	11TW1-21	NONE	OFF	ON
	11TW1-31	NONE	ON	ON
	11TW1-4	MOM OFF	NONE	ON
MS 27718-31-1	11TW1-5	MOM ON	OFF	ON
	11TW1-6	MOM ON	NONE	OFF
MS 27718-27-1	11TW1-7	MOM ON	OFF	MOM ON
MS 27718-26-1	11TW1-8	MOM ON	NONE	ON
	11TW1-41	NONE	MOM OFF	ON
	11TW1-51	NONE	ON	MOM ON
	11TW1-61	MOM ON	OFF	NONE

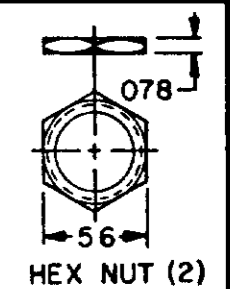
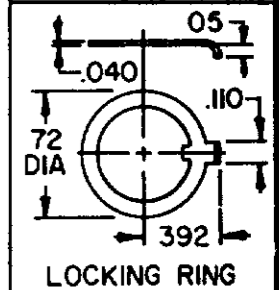
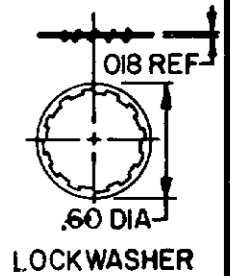
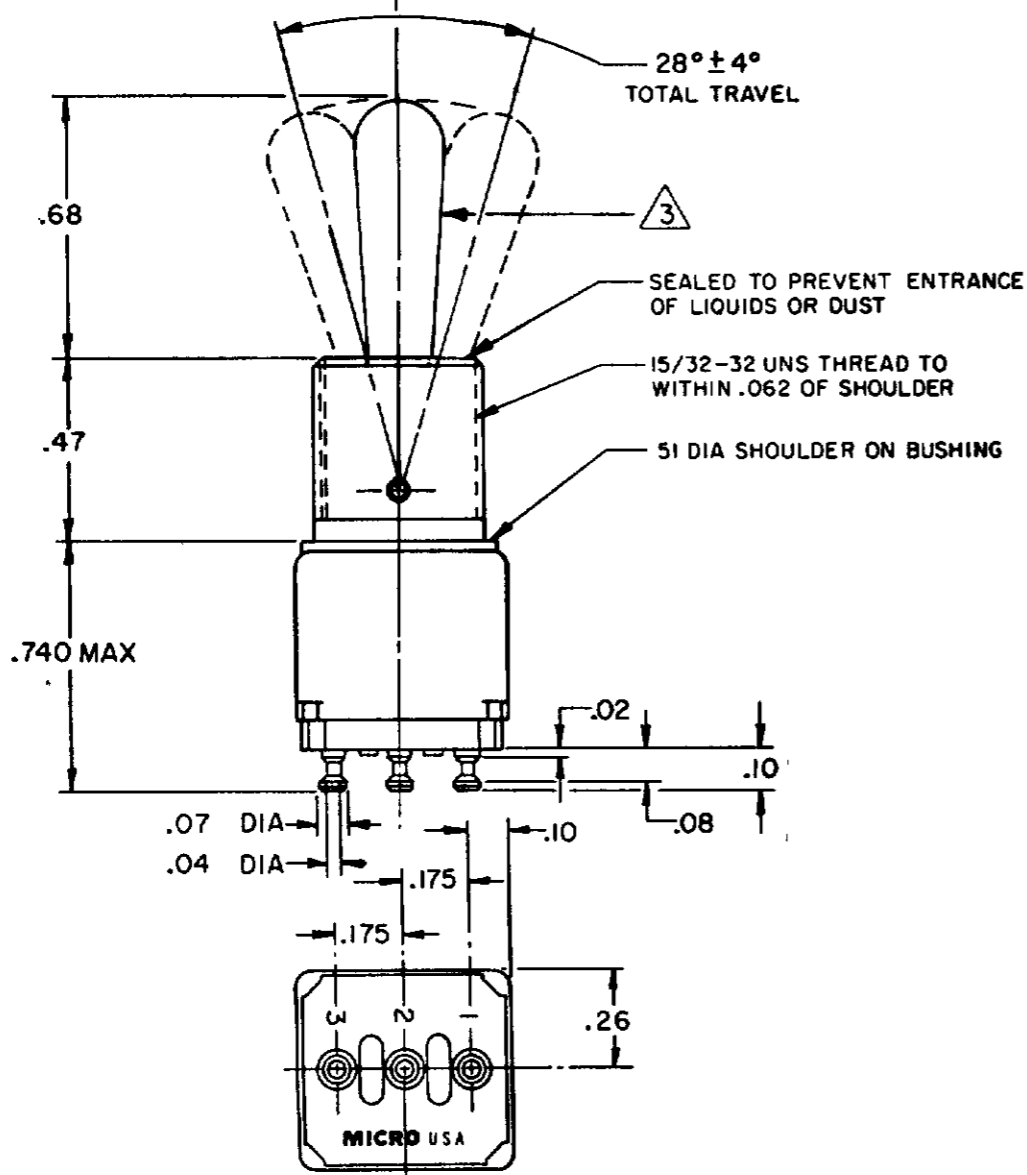
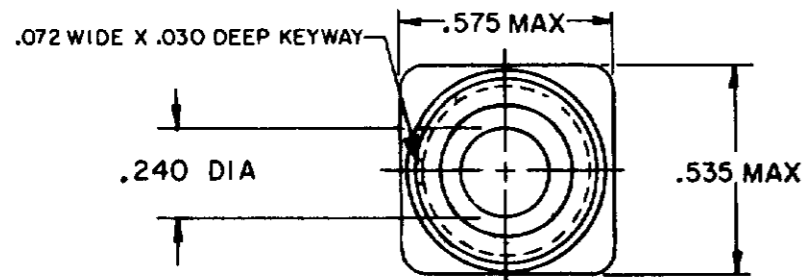

NOTES

- ① - FURNISHED UNASSEMBLED
- ② - TERMINALS ARE PLATED FOR SOLDERING
- ③ - MATTE FINISH

11TW1 SERIES CHART 1 ★  
 DRAWING NUMBER M 16 181921  
 ISSUE 181921  
 RELEASE NO SR-13102  
 CHECK  
 REVISIONS  
 A CO 4567  
 14 MAR 79  
 B CO 50668  
 12 DEC 81  
 C CO 56672  
 1 FEB 85  
 D CO 58138  
 27 SEP 85  
 E CO 61252  
 12 MAR 87  
 F CO 62938  
 24 FEB 88  
 G CO 69634  
 14 MAY 91  
 DRAWN S J B 14 MAR 79  
 CHECK C E B  
 FO-92851

SCALE 2:1  
DO NOT SCALE PRINT  
UNLESS OTHERWISE NOTED  
DIMENSIONS ARE IN INCHES  
TOLERANCES ARE  
ONE PLACE (.01) HIGH .030  
TWO PLACE (.001) HIGH .015  
THREE PLACE (.0001) HIGH .005  
ANGLES  
WEIGHT .025 LB MAX

# Mouser Electronics

Authorized Distributor

Click to View Pricing, Inventory, Delivery & Lifecycle Information:

[Honeywell:](#)

[11TW1-1](#) [11TW1-2](#) [11TW1-3](#) [11TW1-5](#) [11TW1-7](#) [11TW1-8](#)