

DETAIL "A"  
CHAMFER  
SCALE=10:1

RoHS

NOTES: UNLESS OTHERWISE SPECIFIED  
1. COSMETIC SPECIFICATION REFER TO WI-QA-038.

IMPEDANCE ( Z )			
Frequency	25 MHz	100 MHz	300 MHz
Nominal (REF)	57 Ω	125 Ω	245 Ω
Minimum	- Ω	100 Ω	- Ω

Z vs. FREQUENCY  
(REF. ONLY)

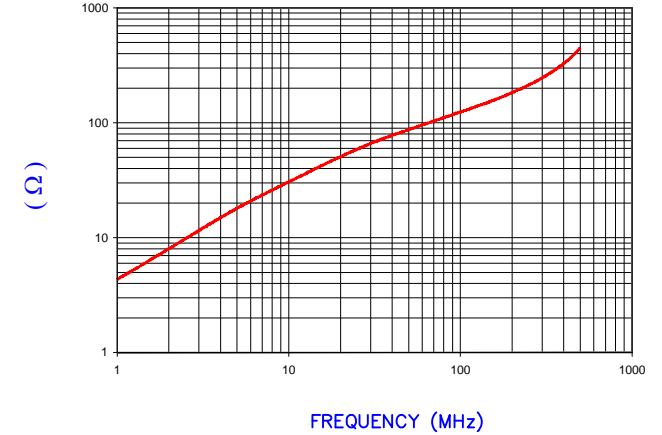

AGILENT E4991A Impedance/Material Analyzer  
HP 16092A Test Fixture

BARE DIMENSIONS

A	9.53 [.375]	±	0.20 [.008]
B	5.08 [.200]	±	0.15 [.006]
C	10.41 [.410]	±	0.25 [.010]

WEIGHT/1000    2.55 kgs.    5.62 lbs.

SCALE DRAWING 1:1

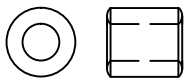

28B0375-000

DIMENSIONS ARE IN MM [INCHES].				This print is the property of Laird Tech. and is loaned in confidence subject to return upon request and with the understanding that no copies shall be made without the written consent of Laird Tech. All rights to design or invention are reserved.							
REV	DESCRIPTION	DATE	INT								
F	UPDATED COMPANY LOGO, ADD NOTE	08/29/14	QIU	PROJECT/PART NUMBER: <b>28B0375-000</b>		REV	F	PART TYPE:	CNZ CORE	DRAWN BY:	DJB
E	REV CHAMFER AND DETAIL A UPDATE LOGO	11/06/08	JRK			DATE:	11/24/92	SCALE:	4 : 1	MATERIAL:	Ferrite
D	UPDATE FORMAT & Z SPECS, ADD CURVE	05/09/03	JRK			CAD #	28B0375-000-F	TOOL #	B0375		
C	UPDATE PRINT FORMAT ADD DETAIL A	12/21/01	JRK								
B	UPDATED Z SPEC.	11/17/95	JBE								
A	ORIGINAL DRAFT	11/24/92	DJB								
REV	DESCRIPTION	DATE	INT								