

NOTES:

1.0 ELECTRICAL SPECIFICATIONS:

- 1.1 FREQUENCY RANGE: DC to 18.0 GHz
- 1.2 MAXIMUM INPUT POWER: 0.5 WATTS @ +25°C
DERATED LINEARLY TO 0 WATTS @ +125°C
- 1.3 OPERATING TEMP. RANGE: -55°C to +125°C
- 1.4 IMPEDANCE: 50 OHMS
- 1.5 VSWR: 1.10+0.01f(GHz)

2.0 MATERIALS:

- 2.1 HOUSING AND COUPLING NUT:
STAINLESS STEEL NON-MAGNETIC PER
ASTM-A582, TYPE 303.
- 2.2 CENTER CONTACT: BERYLLIUM COPPER ROD
ALLOY C172 TEMPER H, PER ASTM-B196.
- 2.3 DIELECTRIC: PTFE FLOUROCARBON PER
ASTM-D1457.

3.0 FINISHES:

- 3.1 HOUSING AND COUPLING NUT:
PASSIVATED PER MIL-F-14072 AND QQ-P-35C, TYPE IV
- 3.2 CENTER CONTACT: GOLD PER MIL-G-45204,
TYPE II, CLASS 1.

4.0 MARKING: MARK UNIT AS SHOWN
(REF.: INK-09035-27-10)

5.0 DIMENSIONS IN PARENTHESIS ARE IN
MILLIMETERS.

SSMA PLUG
PER MIL-PRF-39012

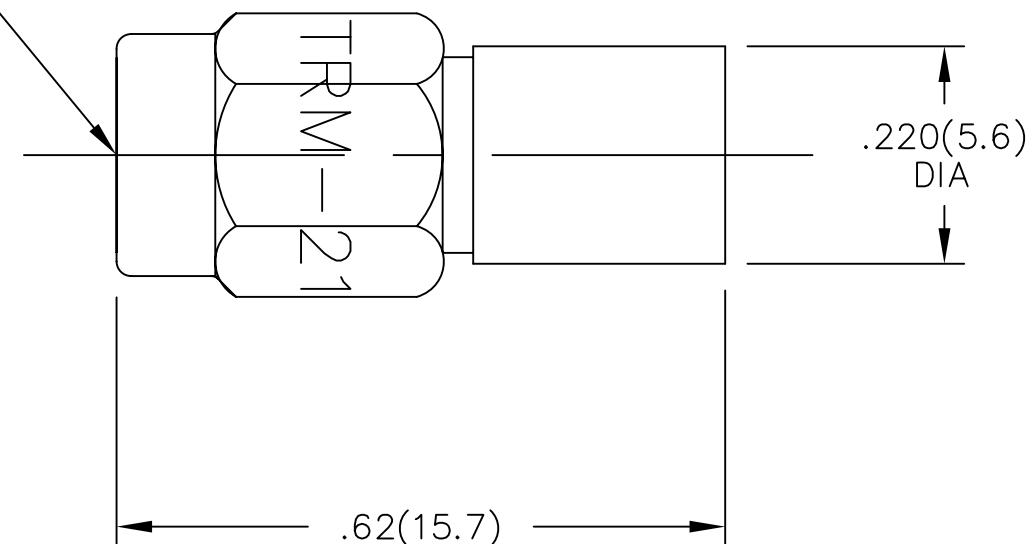

MODEL NUMBER	TRM-2180-MO-SSM-02
REV.	B

REV.	DESCRIPTION	DATE
-	RELEASED	12/2/94
A	ECN 14280	2/10/95
B	ECN 18498	4/26/02

UNLESS OTHERWISE NOTED DIMENSIONS ARE IN INCHES AND TOLERANCES ARE: 3 PLACE DECIMALS ±.005 2 PLACE DECIMALS ±.02 FRACTIONS ±1/64 PARALLELITY: T.I.R. _____ FLATNESS: T.I.R. _____ CONCENTRICITY: T.I.R. _____ ANGLES AND PERPENDICULARITY: ±1'	FSCM NO. 34078	MIDWEST MICROWAVE	
	NOTICE: The information contained in this drawing is proprietary and must not be used without the permission of Midwest Microwave	TITLE TERMINATION - SSMA PLUG	
		DRAWING NUMBER TRM-2180-MO-SSM-02	
	CHECKED/DATE A.BEATTY 12/2/94	APPROVED/DATE C.RIGGE 4/26/02	SCALE: 5=1

Mouser Electronics

Authorized Distributor

Click to View Pricing, Inventory, Delivery & Lifecycle Information:

[Cinch Connectivity Solutions:](#)

[TRM-2180-M0-SSM-02](#)