

ISS.	AMEND	DATE
1	1st DRAWN	08/12/15
2	ADD M3 VARIANT	29/05/18

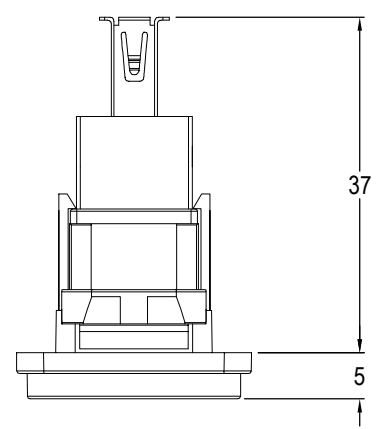
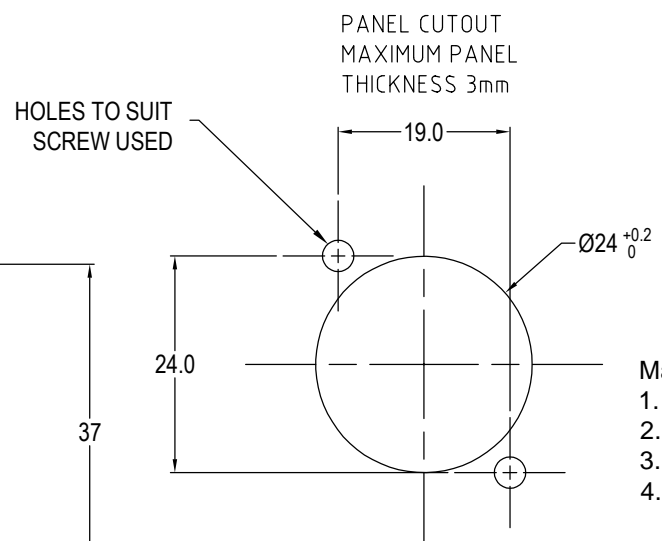

- Material:**
1. Insert: ABS
 2. Frame: Black Nickel plated zinc diecast
 3. Shell: Nickel plated steel
 4. Contacts: Gold Plated

- Notes:**
1. Voltage rating: 30V AC
 2. Current rating: 1.5 A max
 3. Contact resistance: 50mΩ max
 4. Insulation resistance: 20MΩ min
 5. Dielectric withstanding voltage: 500V AC
 6. Operating Temperature: -20°C to 50°C

VARIANTS	
PART No.	HOLE DETAILS
CP30208NMB	HOLE Ø3.50 x CSK 82° x Ø5.85
CP30208NM3B	M3 HOLES

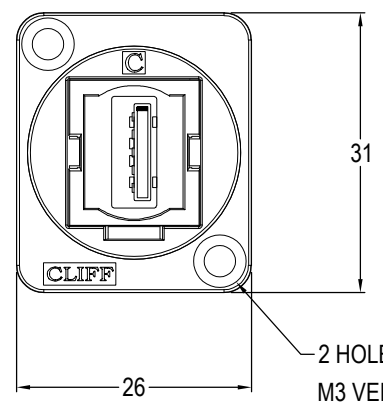

2 HOLES: Ø3.5mm CSK 82° x Ø5.85
M3 VERSION HAS M3 THREAD HOLES.

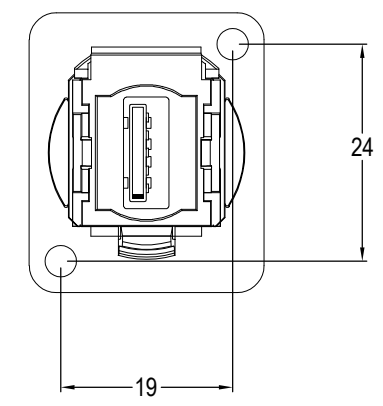
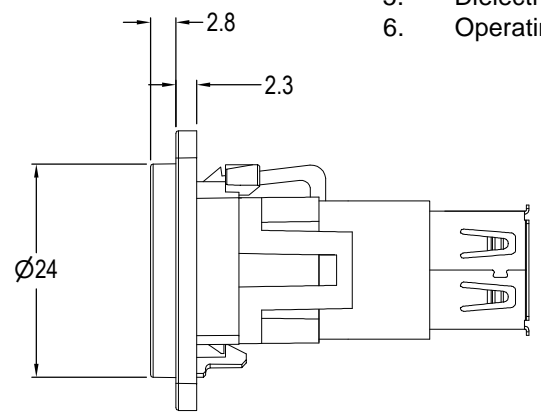

RoHS COMPLIANT
TOLERANCE
NO DEC. PLACE ±
1 DEC. PLACE ±
2 DEC. PLACE ±
HOLE Ø ±
ANGLES ±
UNLESS OTHERWISE STATED