

SunBrite™

Modular LED Lightbars



Cost-Effective, High Performance Modular LED Lightbars!

The SunBrite family of Modular LED Lightbar technologies combine high-performance, ease-of-installation, flexibility and cost savings. Unlike many alternative lighting technologies, the SunBrite LED Lightbar can be installed with ease without the need to hire an electrician to open walls and install new wiring. Lumex's SunBrite™ LEDs are ideal for undercabinet, kitchen, bookshelf, cupboard, showcase, and accent and cove lighting applications.

Features:

- Available in lengths of 6, 12 and 24 inches for extendable design solutions
- Compatible connector cables available in 10", 20" or 40" lengths to connect Lightbars to desired length
- Mounting clips are available in standard format, 45° Angle format and Swivel format.
- A specially designed transformer is available to allow for simplified installation and immediate wall plug-in.
- For brightness control, a dimmer switch is available and effective on an entire line of connected light switches
- Ultra thin heat sink
- CE, UL, IP60, and RoHS compliant
- Warm, neutral and cool white colors are available in standard formats. Custom RGB technologies can also be created in any color.



Member of the **ITW Photonics Group**

SunBrite™ Modular LED Lightbars

by **LUMEX**
Creating LED and LCD Solutions Together™

Recommended Applications

- Cabinet Lighting
- Undercabinet Lighting
- Kitchen Lighting
- Garage Lighting
- Bookshelf Illumination
- Cupboard Lighting
- Showcase Displays
- Cove Lighting

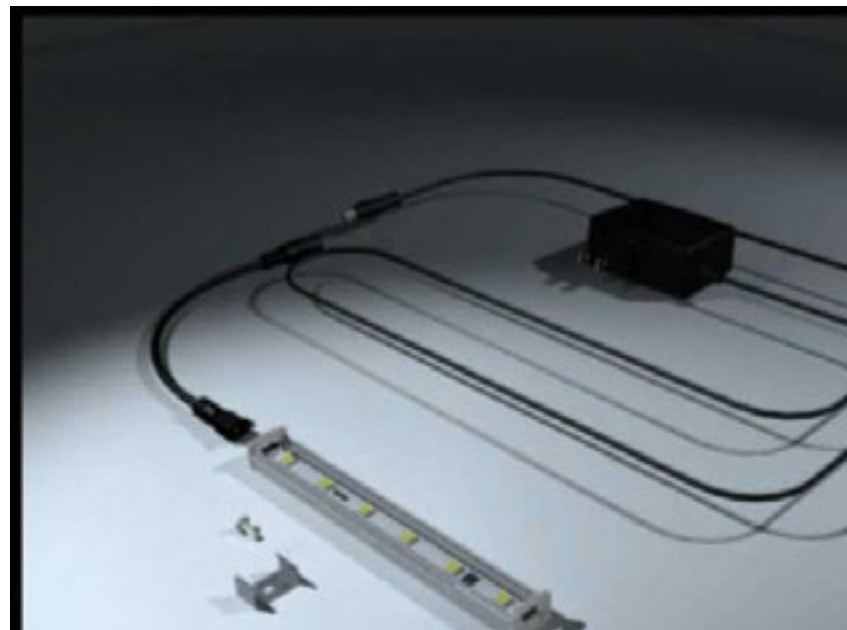

SunBrite™ Modular LED Lightbars

by **LUMEX**
Creating LED and LCD Solutions Together™

6" LED Lightbars: SSP-LB06 series

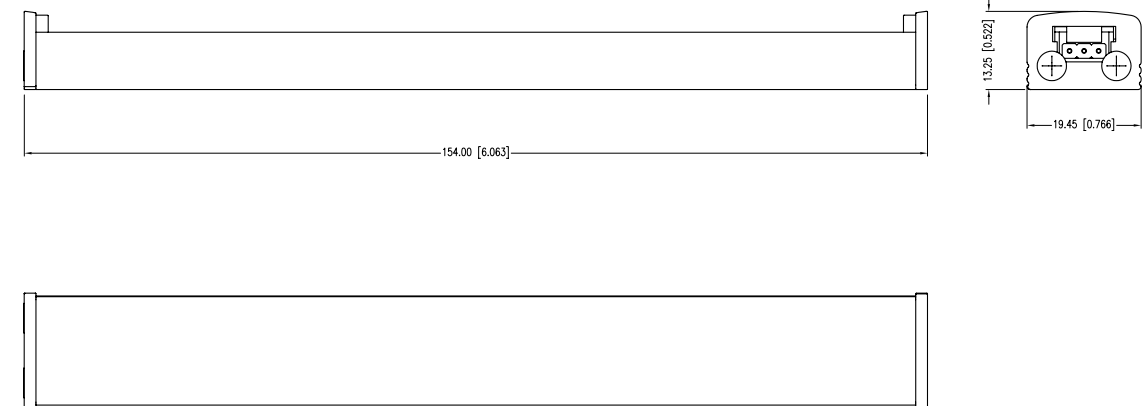
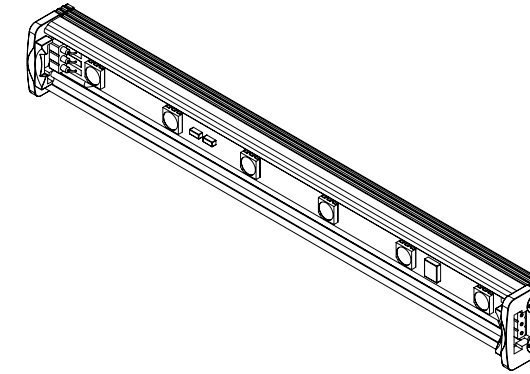

SunBrite™ Modular LED Lightbars								
PN	Emitted Color	# of LEDs	CCT (K)	Watts	Lumens	Length	Voltage	Angle
SSP-LB06MW024K03	Warm White	6	2600 ~ 3000	2.5	150	6"	24VDC	120



SunBrite™ Modular LED Lightbars

by **LUMEX**
Creating LED and LCD Solutions Together™

12" LED Lightbars: SSP-LB12 series

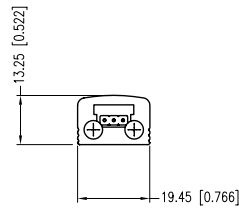
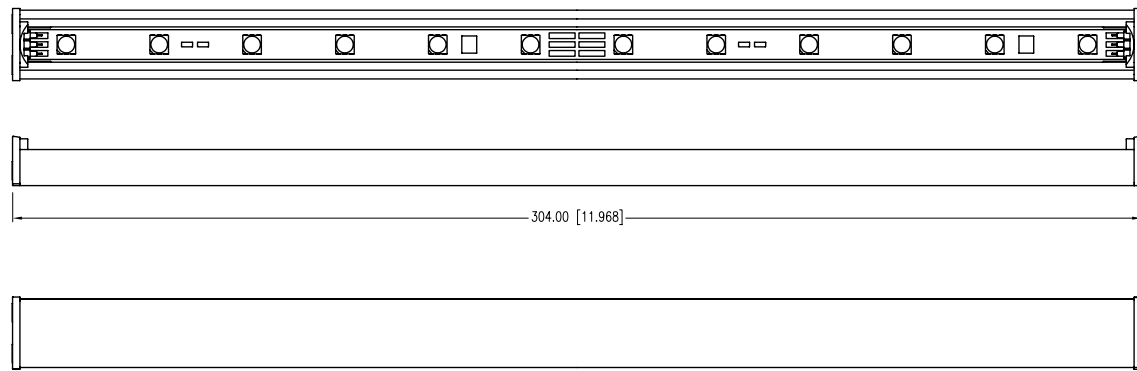
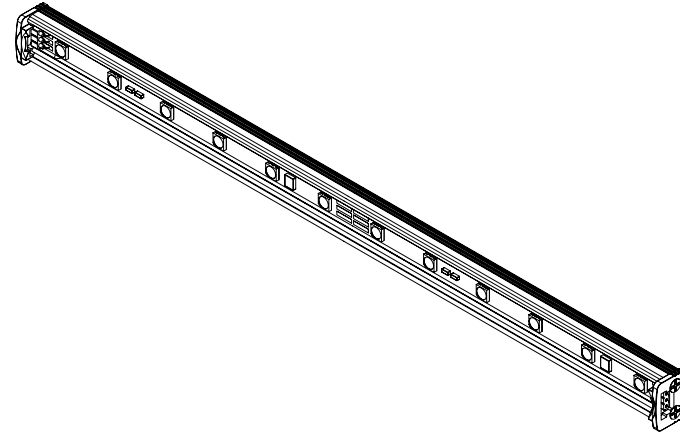

SunBrite™ Modular LED Lightbars								
PN	Emitted Color	# of LEDs	CCT (K)	Watts	Lumens	Length	Voltage	Angle
SSP-LB12UW024K05	Cool White	12	5000 ~ 6300	5	360	12"	24 VDC	120
SSP-LB12UW024K03	Cool White	12	5000 ~ 6300	3.3	220	12"	24 VDC	120
SSP-LB12NW024K05	Neutral White	12	3700 ~ 4300	5	300	12"	24 VDC	120
SSP-LB12NW024K03	Neutral White	12	3700 ~ 4300	3.3	220	12"	24 VDC	120
SSP-LB12MW024K05	Warm White	12	2600 ~ 3000	5	300	12"	24 VDC	120
SSP-LB12MW024K03	Warm White	12	2600 ~ 3000	3.3	190	12"	24 VDC	120



SunBrite™ Modular LED Lightbars

by **LUMEX**
Creating LED and LCD Solutions Together™

24" LED Lightbars: SSP-LB24 series

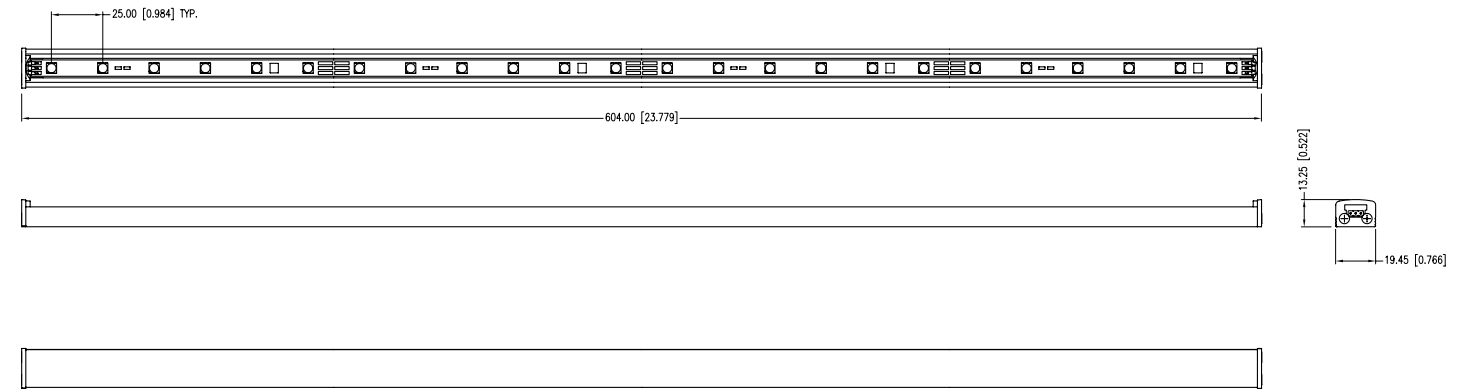
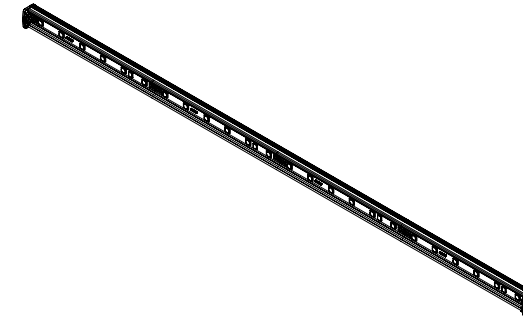

SunBrite™ Modular LED Lightbars								
PN	Emitted Color	# of LEDs	CCT (K)	Watts	Lumens	Length	Voltage	Angle
SSP-LB24MW024K10	Warm White	24	2600 ~ 3000	10	600	24"	24 VDC	120
SSP-LB24UW024K07	Cool White	24	5000 ~ 6300	6.6	440	24"	24 VDC	120



SunBrite™ Modular LED Lightbars



Illumination Charts

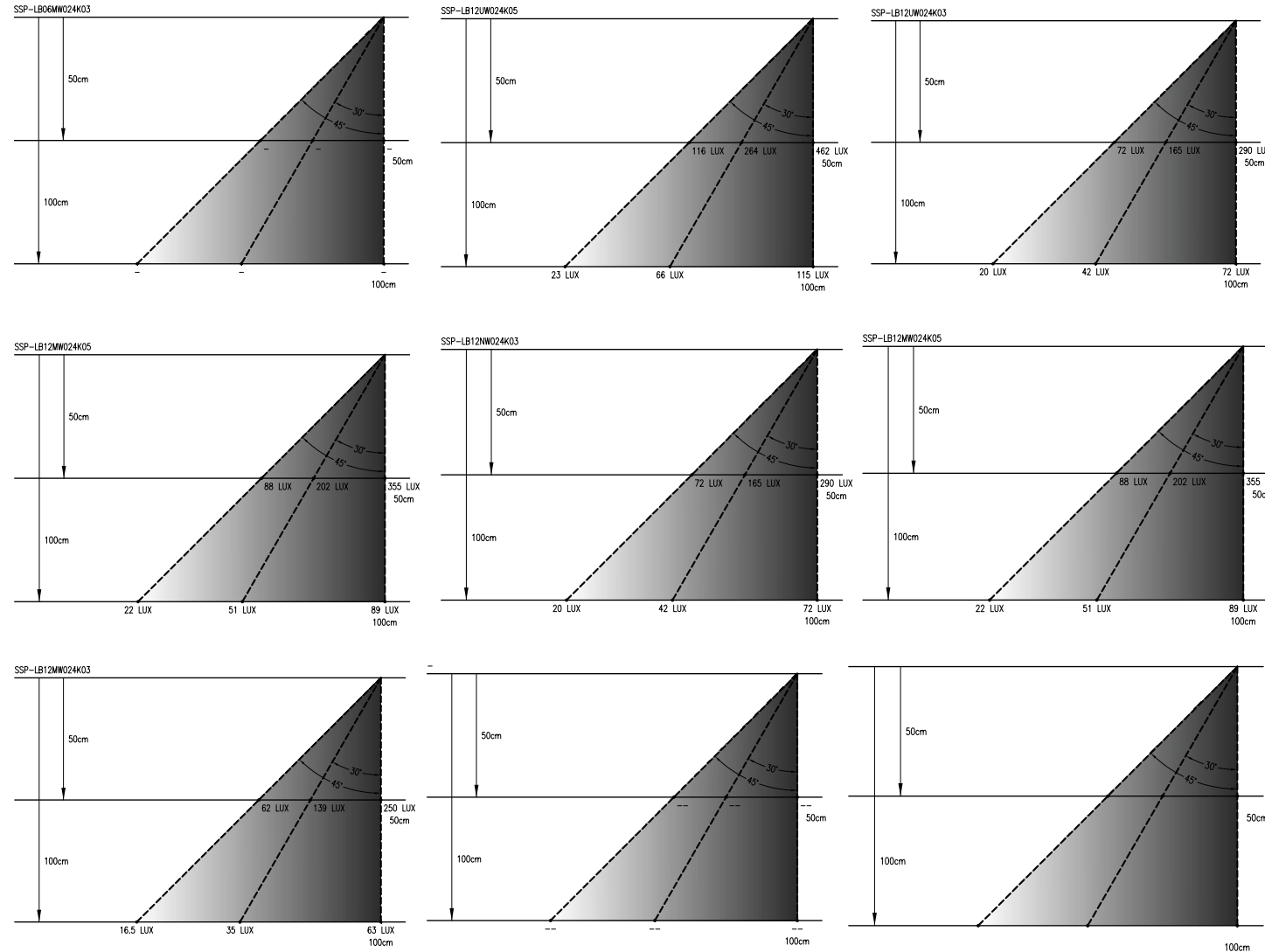

SunBrite™ Modular LED Lightbars



Recommended Accessories for SunBrite™ Modular LED Lightbars

SunBrite P/N	Description
SSP-PW024	24 Watt Adapter Input 100~240 volt AC, output 24 volt DC / 1.0A
SSP-CA12	12" Power Line Connection Cable
SSP-CN10	10" Connection Cable Between Lightbars
SSP-CN0	Lightbar to Lightbar Connector
SSP-CNU2	U-Shape Jumper Between Lightbars
SSP-CN2CN	Cable to Cable Extension Joint
SSP-CNM0	Multiple Cable to Cable Extension Joint
SSP-MTCF1	Mounting Clip for Lightbar (standard format)
SSP-MTCF2	Mounting Clip for Lightbar (45° Angle format)
SSP-MTCV1	Mounting Clip for Lightbar (Swivel format)
SSP-DM0	Set of Mini Touch Dimmer Switches
SSP-CADM12	12" Power Line Connection Cable for Dimmer Switch



SunBrite™ Modular LED Lightbars



Installation Instructions

Layout and Designing Requirements:

Sunbrite™ Modular LED Lightbars are available in 3 different lengths, 6", 12" and 24" with power usage either 3.3 W./ft. or 5W./ft. The lightbars can be easily chained to create desired length. Customer should start the design by defining the following factors:

- length for each location
- brightness output
- power usage
- color temperature

Once these factors are defined, you can then begin to design how you want to chain the light bars together. Please keep in mind that total power usage when the light bars are chained together cannot exceed power output from power supply adaptor (for safe operation, recommend total power usage from chained lightbars to be 25% lower than output wattage from power supply adaptor).



SunBrite™ Modular LED Lightbars



Installation Instructions *continued...*

Connection Lightbar to Lightbar:

There are several methods to connect the lightbars. The followings are some examples:-

Method 1. Connecting light bars with bar-to-bar connector (SSP-CN0)



Method 2. Connecting light bars with connection cable (SSP-CN10)



Method 3. Connection light bars with U-Shape Jumper between bars (SSP-CNU2)



SunBrite™ Modular LED Lightbars

by **LUMEX**
Creating LED and LCD Solutions Together™

Installation Instructions *continued...*

Method 4. Connection light bars with cable-to-cable extension joint (SSP-CN2CN)



Method 5. Connection light bars with multiple cable-to-cable extension joint (SSP-CNM0)



Connecting Lightbar to Power Adaptor (SSP-PW024):

SunBrite™ Modular LED Lightbars can be connected to the power adaptor by using the power line connection cable (SSP-CA12) between the lightbar and the power adaptor.



SunBrite™ Modular LED Lightbars

by **LUMEX**
Creating LED and LCD Solutions Together™

Installation Instructions *continued...*

Using Mini-Touch Dimmer Switch in Connection with Lightbars:

Note: In order to enable the dimming function, Mini Touch Dimmer Switch must be used in conjunction with SSP-CADM12, gray power line connection cable which come together as a set with dimmer switch.

a). Operation Description

- 1). On/Off: Use your finger to touch the sensor area shortly (single touch, ~0.5 seconds, see Fig.1)
- 2). Dimming: Continue to hold the finger on the sensor area. It will dim the lightbar brightness in a cycling pattern. Remove your finger when it reaches the desired brightness (see Fig.1).
- 3). Brightness Setting memory: The pervious selected brightness is stored until the adaptor plug is disconnected.

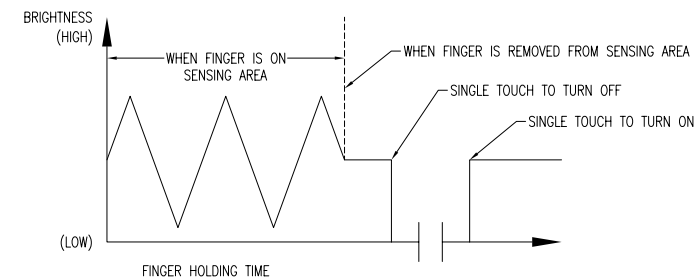

Fig. 1

- b). System Configuration – Mini Touch Dimmer Switch can be installed at any place in a light bar chain or network. Several Scenarios are illustrated below:

Scenario 1. Dimmer at the "end" of chain



SunBrite™ Modular LED Lightbars

by **LUMEX**
Creating LED and LCD Solutions Together™

Installation Instructions *continued...*

Using Mini-Touch Dimmer Switch in Connection with Lightbars: *continued...*

Scenario 2. Dimmer at the "middle" of a chain



Scenario 3. Dimmer at the "beginning" of a chain



Scenario 4. Dimmer at a branching "network"



SunBrite™ Modular LED Lightbars

by **LUMEX**
Creating LED and LCD Solutions Together™

Installation Instructions *continued...*

Mounting clips

Lumex offer 3 styles of mounting clip options for the SunBrite™ Modular LED Lightbars. You can choose from standard-style mounting clips (SSP-MTCF1), 45 degree mounting clips (SSP-MTCF2), or swivel-style mounting clips (SSP-MTCV1).

Installation is simple. Just screw in the selected mounting clip to the area you want to install the lightbar. Then, snap the lightbar to the clips. We suggest installing the lightbars with one (1) mounting clip for every 6" distance.

Standard



45 Degree



Swivel

