

REV.	DATE	DESCRIPTION
NC	01/29/98	INITIAL RELEASE
A	07/20/05	UPDATE DRAWING FORMAT

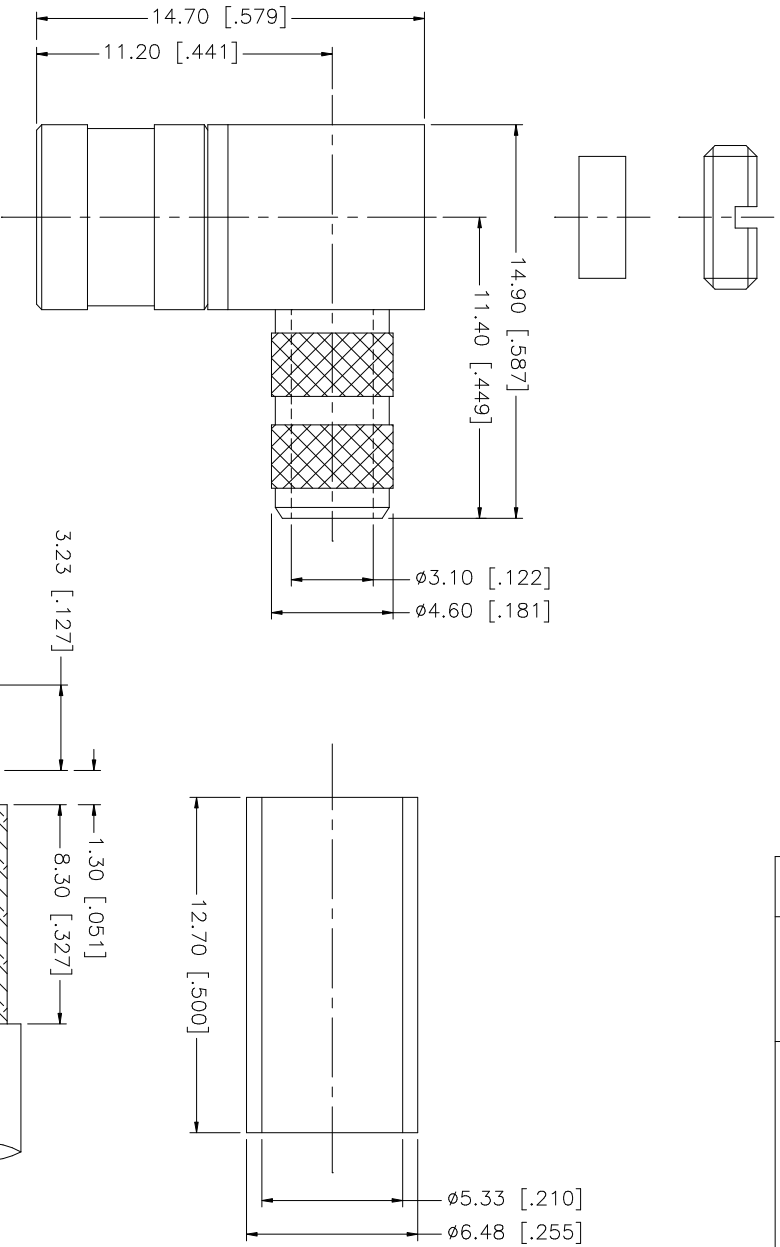

RECOMMENDED CABLE  
STRIPPING DIMENSIONS

8					UNLESS OTHERWISE SPECIFIED DIMENSIONS ARE INCHES AND FOR CUSTOMER REFERENCE ONLY.	APPROVALS	DATE	<p style="font-size: 2em; font-weight: bold; color: blue; margin: 0;">Amphenol Connex</p>										
7				UNLESS OTHERWISE SPECIFIED TOLERANCES FOR MILLIMETERS ARE:	<table border="1" style="width: 100%; border-collapse: collapse;"> <tr> <th colspan="2">APPROVALS</th> <th>DATE</th> </tr> <tr> <td>DRAWN</td> <td>G.R.S.</td> <td>07//20/05</td> </tr> <tr> <td>CHECKED</td> <td></td> <td></td> </tr> <tr> <td>ISSUED</td> <td></td> <td></td> </tr> </table>	APPROVALS			DATE	DRAWN	G.R.S.	07//20/05	CHECKED			ISSUED		
APPROVALS		DATE																
DRAWN	G.R.S.	07//20/05																
CHECKED																		
ISSUED																		
6	FERRULE	COPPER	GOLD	0.5 - 8mm ± 0.20mm	<table border="1" style="width: 100%; border-collapse: collapse;"> <tr> <th colspan="2">PART DESCRIPTION</th> </tr> <tr> <td style="text-align: center;">SMB R/A/ CRIMP PLUG (RG-58/U CABLE)</td> <td style="text-align: center;">PART NO. 142206</td> </tr> </table>	PART DESCRIPTION		SMB R/A/ CRIMP PLUG (RG-58/U CABLE)	PART NO. 142206									
PART DESCRIPTION																		
SMB R/A/ CRIMP PLUG (RG-58/U CABLE)	PART NO. 142206																	
5	NUT	BRASS	GOLD	8 - 30mm ± 0.40mm														
4	INSULATOR	P.E.	NATURAL	30 - 120mm ± 0.50mm	<table border="1" style="width: 100%; border-collapse: collapse;"> <tr> <th colspan="2">UNLESS OTHERWISE SPECIFIED TOLERANCES FOR INCHES ARE:</th> </tr> <tr> <td>.020 - .315 = ± 0.007"</td> <td rowspan="2" style="text-align: center;">SHEET 1 OF 1</td> </tr> <tr> <td>.315 - 1.180 = ± 0.015"</td> </tr> <tr> <td>1.180 - 4.724 = ± 0.020"</td> <td></td> </tr> </table>	UNLESS OTHERWISE SPECIFIED TOLERANCES FOR INCHES ARE:		.020 - .315 = ± 0.007"	SHEET 1 OF 1	.315 - 1.180 = ± 0.015"	1.180 - 4.724 = ± 0.020"							
UNLESS OTHERWISE SPECIFIED TOLERANCES FOR INCHES ARE:																		
.020 - .315 = ± 0.007"	SHEET 1 OF 1																	
.315 - 1.180 = ± 0.015"																		
1.180 - 4.724 = ± 0.020"																		
3	CONTACT PIN	BER. COPPER	GOLD		<table border="1" style="width: 100%; border-collapse: collapse;"> <tr> <th colspan="2">CAD FILE</th> <th>DWG. NO.</th> <th>REV.</th> <th>SIZE</th> <th>SCALE</th> </tr> <tr> <td colspan="2">C:/142/142206.DWG</td> <td>142206.DWG</td> <td>A</td> <td>A</td> <td>NA</td> </tr> </table>	CAD FILE		DWG. NO.	REV.	SIZE	SCALE	C:/142/142206.DWG		142206.DWG	A	A	NA	
CAD FILE		DWG. NO.	REV.	SIZE		SCALE												
C:/142/142206.DWG		142206.DWG	A	A	NA													
2	INSULATOR	TEFLON	NATURAL															
1	BODY	BRASS	GOLD															
DESCRIPTION				MATERIAL	FINISH	QTY	DO NOT SCALE DRAWING											