

TUBULAR CABLE LUGS

Standard type
 Material: E-copper
 Surface: tin plated
 with or without inspection hole

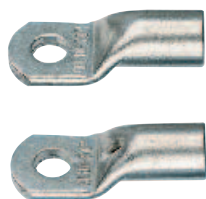
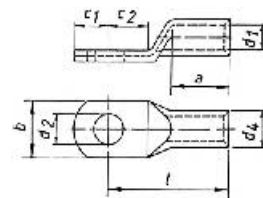

Conductor mm ²	Bolt Ø	Part No. *	Dimensions mm								Tools	100 pcs ~ kg	pcs
			d ₁	a	b	d ₂	d ₄	c ₁	c ₂	l			
6	M 5	1 R/5	3.5	9	10	5.5	6.5	6.5	7.5	21	Chart page 1.29 – 1.30	0.500 0.470 0.540 0.590 0.630	100
	M 6	1 R/6			12	6.5		6.5	7.5	21			
	M 8	1 R/8			15	8.5		10	10	23			
	M 10	1 R/10			17	10.5		12	12	25			
	M 12	1 R/12			19	13		13	13	28			
10	M 5	2 R/5	4.5	10	12	5.5	7	6.5	7.5	22		0.500 0.490 0.580 0.620 0.640	100
	M 6	2 R/6			12	6.5		6.5	7.5	22			
	M 8	2 R/8			15	8.5		10	10	25			
	M 10	2 R/10			17	10.5		12	12	27			
	M 12	2 R/12			19	13		13	13	29			
16	M 5	3 R/5	5.5	13	12	5.5	8.5	5.5	6.5	26		0.840 0.860 0.930 0.990 1.020	100
	M 6	3 R/6			12	6.5		6.25	7.5	27			
	M 8	3 R/8			15	8.5		8.5	9.5	29			
	M 10	3 R/10			17	10.5		10.5	11.5	31			
	M 12	3 R/12			19	13		12	13	33			
25	M 5	4 R/5	7	15	14	5.5	10	7.5	7.5	30		1.220 1.200 1.310 1.570 1.390 1.490	25 100 100 100 25 25
	M 6	4 R/6			14	6.5		7.5	7.5	30			
	M 8	4 R/8			16	8.5		10	10	32			
	M 10	4 R/10			18	10.5		12	12	34			
	M 12	4 R/12			19	13		13	13	35			
	M 14	4 R/14			21	15		14.5	14.5	38			
35	M 6	5 R/6	8.5	17	17	6.5	12	7.5	7.5	32		1.850 2.000 2.130 2.120 2.180 2.240	100 100 100 100 25 25
	M 8	5 R/8			17	8.5		10	10	34			
	M 10	5 R/10			19	10.5		12	12	37			
	M 12	5 R/12			21	13		13	13	38			
	M 14	5 R/14			21	15		14.5	14.5	40			
	M 16	5 R/16			26	17		16	16	42			
50	M 6	6 R/6	10	19	20	6.5	14	10	10	37		3.000 2.930 3.080 3.230 3.320 3.380 3.460	25 50 50 50 25 25 25
	M 8	6 R/8			20	8.5		10	10	37			
	M 10	6 R/10			20	10.5		12	12	39			
	M 12	6 R/12			23	13		13	13	43			
	M 14	6 R/14			23	15		14.5	14.5	45			
	M 16	6 R/16			28	17		16	16	46			
	M 20	6 R/20			30	21		19	19	48			

* Part number for inspection hole version with appendix "ms"