

AV

AVERES



TECHNICAL MANUAL
Relay socket RM4/RM5
EKF AVERES

1 DESCRIPTION

The relay sockets RM4/RM5 EKF AVERES are used to mount interface relays onto 35mm DIN rails. The relay socket carries terminals for switching contacts and the coil. Push-in sockets are fitted with push-in terminals, other types of sockets are fitted with screw terminals.

NOTE: Interface relays RP are not covered by the delivery scope of relay sockets RM!

2 TECHNICAL DATA

Table 1 - Main characteristics

Characteristics	Values
Degree of protection	IP20
Cross-section of connected wires, mm ²	0,5-1,5
Insulation dielectric strength, V	2500
Rated current, A	10
Rated voltage, V	300
Mounting type	DIN rail
Operating temperature, °C	from -40 to +70
Tightening torque, N•m	0,5

Table 2

Item code	Name
rm4-22-3	Relay socket RM4 22/3 EKF AVERES
rm4-22-4	Relay socket RM4 22/4 EKF AVERES
rm5-22-30	Relay socket RM5 22/3 EKF AVERES
rm5-22-4	Relay socket RM5 22/4 EKF AVERES
rm-22-36d	Relay holder RM-22-36 EKF AVERES
rm-22-xzb	Marking plate RM-XZB EKF AVERES

Table 2 continued

Item code	Name
rm5-22-2	Relay socket RM5 22/2 EKF AVERES
rm5-25-1	Relay socket RM5 25/1 EKF AVERES
rm5-22-4-push	Relay socket RM5 22/4 Push-in EKF AVERES
rm5-22-2-push	Relay socket RM5 22/2 Push-in EKF AVERES
rm5-25-1-push	Relay socket RM5 25/1 Push-in EKF AVERES

WIRING DIAGRAMS

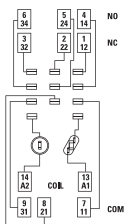

rm4-22-3

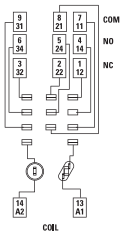

rm5-22-30

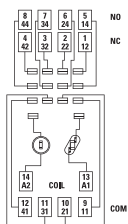

rm4-22-4

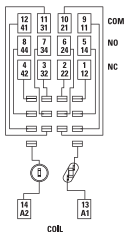

rm5-22-4

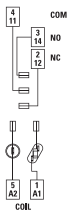

rm5-25-1

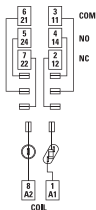

rm5-22-2

3 OVERALL AND INSTALLATION DIMENSIONS

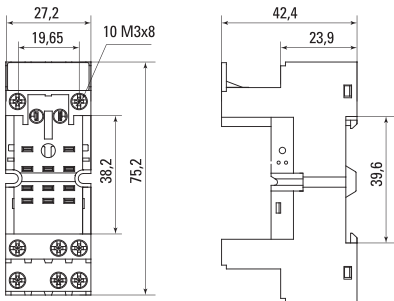

Fig. 1 - Overall dimensions of relay socket RM4 22/3 EKF AVERES

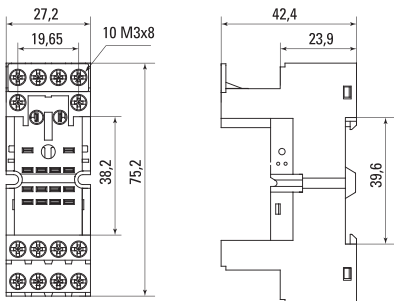

Fig. 2 - Overall dimensions of relay socket RM4 22/4 EKF AVERES

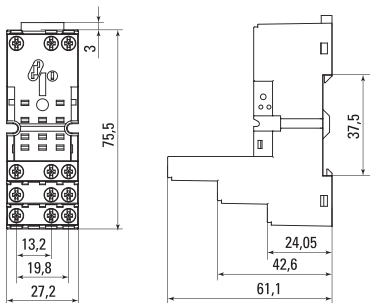

Fig. 3 - Overall dimensions of relay socket RM5 22/3 EKF AVERES

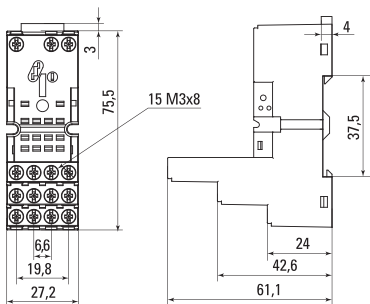

Fig. 4 - Overall dimensions of relay socket RM5 22/4 EKF AVERES

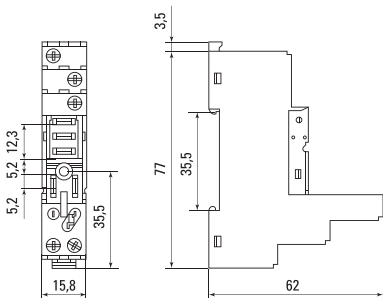

Fig. 5 - Overall dimensions of relay socket RM5 25/1 EKF AVERES

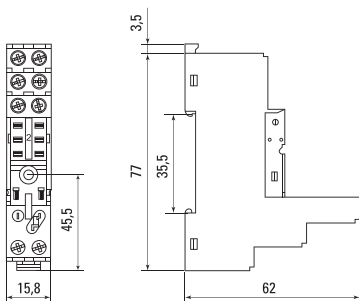

Fig. 6 - Overall dimensions of relay socket RM5 22/2 EKF AVERES

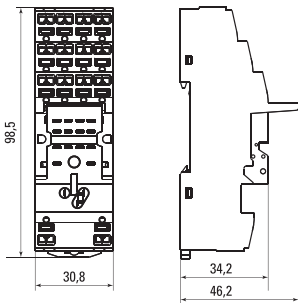

Fig. 7 - Overall dimensions of relay socket RM5 22/4 Push-in EKF AVERES

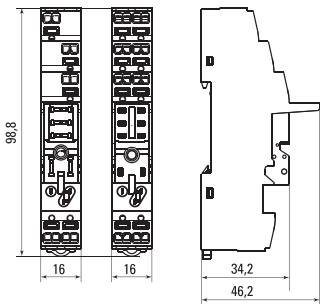

Fig. 8 - Overall dimensions of relay socket RM5 25/1 and 22/2 Push-in EKF AVERES

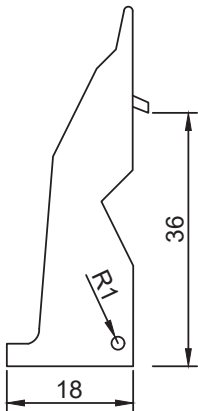

Fig. 9 - Overall dimensions of relay holder RM-22-36 EKF AVERES

4 DELIVERY SCOPE

Relay sockets are supplied in a group package.

For all available documentation, scan the QR-code on the insert or on the inside of the package.

5 TRANSPORTATION AND STORAGE

The relay sockets can be transported by any means of enclosed transport that prevents the packed products from mechanical impact and weather exposure. The relay sockets shall be stored in the original package at the ambient temperature from -50°C to +70°C and relative humidity of max. 90%.

6 DISPOSAL

Life-expired and failed products shall be disposed of in compliance with the national and local laws and regulations in force. To dispose of the product, send it to an authorized company for recycling in compliance with the national and local laws and regulations in force.

7 MANUFACTURER'S WARRANTY

The manufacturer guarantees the products comply with the declared characteristics, provided that consumers follow the operation, transportation and storage conditions.

Warranty period: 10 years from the date of sale specified in the sales receipt.

Shelf life: 10 years from the date of manufacture specified on the product packaging or housing.

Service life: 10 years.

Manufacturer: For information, refer to the product package.

Importer and EKF trademark service representative:

EKF ELECTRICAL SOLUTION – FZCO, Dubai Silicon Oasis, DDP,
Building A2, Dubai, United Arab Emirates.

Importer and EKF trademark service representative on the territory of the Russian Federation: OOO «Electroresheniya», Otradnaya st., 2b bld. 9, 5th floor, 127273, Moscow, Russia.
Tel.: +7 (495) 788-88-15.

Importer and EKF trademark service representative on the territory of the Republic of Kazakhstan:

TOO «Energoresheniya Kazakhstan», Kazakhstan, Almaty,
Bostandyk district, Turgut Ozal st., 247, apt 4.

8 CERTIFICATE OF ACCEPTANCE

The relay socket RM EKF AVERES has been manufactured in compliance with laws and regulations in force and has been approved for operation.

Date of manufacture: for information, refer to the product package.

Quality control stamp



EAC



v3

ekfgroup.com

