

INTRODUCTION



microSD* Card Connector 1.42mm (.056") Height Normal Mount, SMT Shielded Push-Pull Type

Molex's new Push-Pull-style microSD Memory Card Connector offers the lowest profile in the industry and enhanced features for superior reliability in compact mobile applications

Molex developed its new Push-Pull-style microSD connector for internal mobile phone applications where the card function is placed under the battery pack. In these applications, a low profile and small overall size are the key requirements. At the same time, designing in tight coplanarity features, as well as full shielding and a detect switch, met customers' requirements for reliable solder joint connections, EMI and physical protection and positive card identification.

Molex's new 104031 series offers the lowest profile of any full size Push-Pull version in the market. In addition, it can save between 25 to 40 percent of space versus Push-Push types and is lower cost as a result of not needing eject mechanism components.

Specifications:

- Voltage: 10V AC (RMS) or DC
- Current: 0.5A
- Contact Resistance: 100 milliohms max.
- Dielectric Withstanding Voltage: 500V AC
- Insulation Resistance: 1000 Megohms min.
- Durability: 10,000 cycles
- Operating Temperature: -25 to +85°C

Series 104031 With Card Detect Switch



Features

- Compact Push-Pull design and low profile height
- Tight coplanarity control
- Inner-lead terminal design
- Reliable detect switch
- Simple design without eject mechanism

Benefits

- Space savings for compact mobile applications
- High reliability for reflow soldering
- Prevents damage to terminals from stubbing
- Assurance for card identification
- Cost savings versus Push-Push types

← Card Insertion

The direction of card insertion is the same as the direction of the terminals, which provides for smooth mating and prevents terminal stubbing.

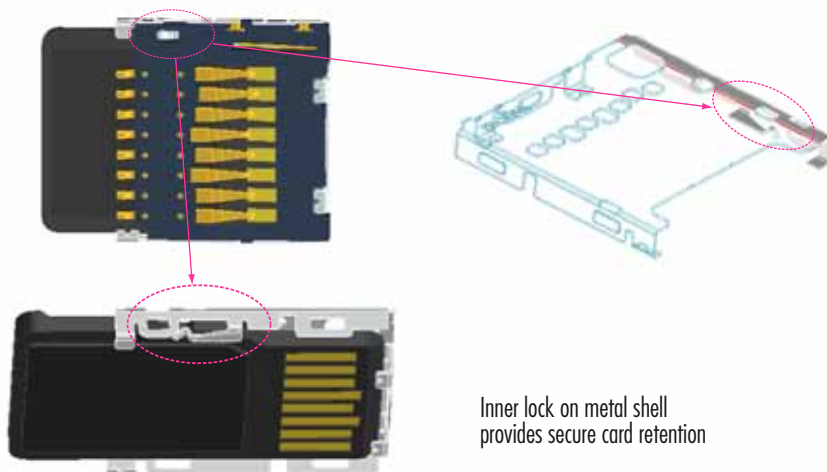

Inner lock on metal shell provides secure card retention

MARKETS AND APPLICATIONS

- Cell phones
- Digital still and video cameras
- Portable audio players
- Portable games
- Car navigation
- Personal navigators



* microSD is a trademark of the SD Card Association

ORDERING INFORMATION



microSD* Card Connector
1.42mm (.056") Height
Normal Mount, SMT
Shielded Push-Pull Type

Series 104031
With Card Detect Switch

Connector

Order Number	Description	Pitch	Height
104031-0811	microSD Memory Card Connector	1.10mm (.043")	1.42mm (.056")

* microSD is a trademark of the SD Card Association

molex[®]
one company › a world of innovation