

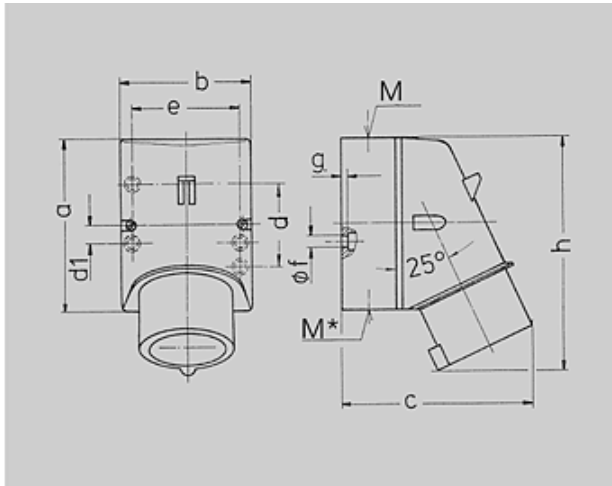

: 348







Wall mounted inlet

Cable entry facility also from the rear by use knock outs.



Drawing	Amp.	16			32		
		2 MB 32 Poles			3	4	5
Dim. in mm	a	87	100	100	128	128	128
	b	64	75	75	84	84	84
	c	93	106	110	133	133	135
	d	40	—	—	—	—	—
	d1	—	10,5	10,5	11	11	11
	e	50,5	59	59	68	68	68
	f	4,5	5	5	5,3	5,3	5,3
	g	4	4	4	4	4	4
	h	122	133	135	169	169	170
	M	20	20	20	25	25	32
	M*	M 20 (blind) to be cut out			M 25 (blind) to be cut out		
	Max. cabel diam. (mm)	13	18	18	25	25	25
	Terminal for cond. cross section (mm ²) min.-max.	1	1	1	2,5	2,5	2,5
	—	2,5	—	—	—	—	

	: 2045
	voltages : 400V
	rated current : 32A
	pole : 4 pole
	IP protection types : IP44
	position of ground contact : 6h
	packing unit : 0010
	: 370 g

		110	230	400	500	>50-500	
		50,60	50,60	50,60	50,60	100-300	300-500
							
16 A	3	331	332	333			
	4	334	335	336ZA	337	921	922
	5	340	341	342ZA	2359	2668	2400
32 A	3	343	344	345			
	4	346	347	348	349		
	5	352	353	354	2386		