

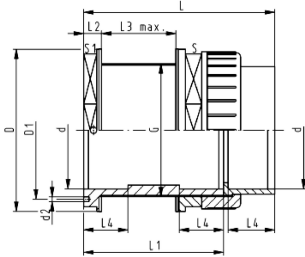

**Tank adaptor type 050 PVC-U**  
**Union with solvent cement socket metric**

**Model:**

- Gaskets: flat gaskets EPDM
- Washer: PP
- Run-out holes: two holes in octagonal head
- FKM flat gaskets available for tank adaptor type 050



| d<br>(mm) | PN<br>(bar) | Code               | SP | Weight<br>(kg) |
|-----------|-------------|--------------------|----|----------------|
| 16        | 16          | <b>161 050 245</b> | 1  | 0.064          |
| 20        | 16          | <b>161 050 246</b> | 1  | 0.070          |
| 25        | 16          | <b>161 050 247</b> | 1  | 0.100          |
| 32        | 16          | <b>161 050 248</b> | 1  | 0.196          |
| 40        | 16          | <b>161 050 249</b> | 1  | 0.328          |
| 50        | 16          | <b>161 050 250</b> | 1  | 0.395          |
| 63        | 16          | <b>161 050 251</b> | 1  | 0.530          |

| d<br>(mm) | L<br>(mm) | L2<br>(mm) | L1<br>(mm) | D<br>(mm) | L3<br>max<br>(mm) | Diameter<br>of bore in<br>tank side<br>(mm) | S1<br>(mm) | L4<br>(mm) | d2<br>(mm) | D1<br>(mm) | S<br>(mm) | G<br>(inch) |
|-----------|-----------|------------|------------|-----------|-------------------|---|------------|------------|------------|------------|-----------|-------------|
| 16        | 77        | 11         | 58         | 44        | 19                | 28  | 40         | 14         | 5          | 29         | 32        | 3/4         |
| 20        | 83        | 12         | 61         | 54        | 17                | 35  | 50         | 16         | 5          | 35         | 40        | 1           |
| 25        | 90        | 13         | 65         | 60        | 18                | 43  | 55         | 19         | 5          | 42         | 50        | 1 1/4       |
| 32        | 95        | 13         | 67         | 69        | 19                | 49  | 65         | 22         | 5          | 49         | 56        | 1 1/2       |
| 40        | 104       | 13         | 72         | 84        | 16                | 61  | 80         | 26         | 5          | 59         | 69        | 2           |
| 50        | 113       | 15         | 76         | 92        | 16                | 67  | 85         | 31         | 5          | 70         | 76        | 2 1/4       |
| 63        | 128       | 15         | 84         | 108       | 19                | 83  | 100        | 38         | 5          | 82         | 95        | 2 3/4       |

The technical data are not binding. They neither constitute expressly warranted characteristics nor guaranteed properties nor a guaranteed durability. They are subject to modification. Our General Terms of Sale apply.

Georg Fischer Piping Systems Ltd, Postfach, CH-8201 Schaffhausen/Switzerland

Phone +41 -(0)52-631 1111

e-mail: [info.ps@georgfischer.com](mailto:info.ps@georgfischer.com)

Internet: <http://www.gfps.com>