

15

KLB 1

Jack connectors



Jack chassis socket acc. to JIS C 6560 JC25P2B, 2.5 mm, 2 poles/mono, with break contact and solder eyes, for back side mounting

State: Active

15

KLB 1

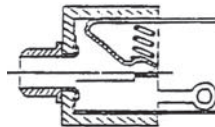
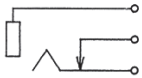
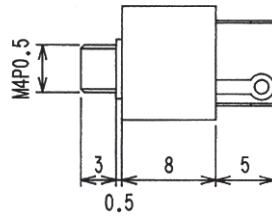
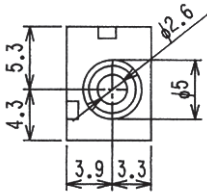

Environmental conditions

Temperature range -20 °C/+70 °C

Materials

Insulating body PC, V-2 according to UL94
Contact spring CuZn, nickel-plated/silver-plated
Knurled nut nickel-plated

Mechanical data

Mating cycles ≥ 5000
Insertion force 5–20 N
Withdrawal force 4–20 N

Electrical data (at T_{amb} 20 °C)

Contact resistance ≤ 20 m Ω
Rated current 0,5 A
Rated voltage 34 V AC/DC
Rated impulse voltage 250 V/60 s
Insulation resistance ≥ 100 M Ω

Associated products

Counterparts
☞ KLS 1 ☞ KLS 10

Accessories
☞ 1597 01 ☞ 1597 03

15

KLB 1

Designation	Pole Number	PU (Pieces)	MDQ (Pieces)
KLB 1	2	500	500

Packaging:

in bulk, in a cardboard box or a plastic bag