

Deep groove ball bearings, single row, seal on both sides

Principal dimensions			Basic load ratings		Fatigue load limit P_u	Speed ratings		Mass	Designation
d	D	B	dynamic C	static C_0		Reference speed	Limiting speed		
mm			kN		kN	r/min		kg	-
20	52	15	16,8	7,8	0,335	-	9500	0,14	6304-2RSH *

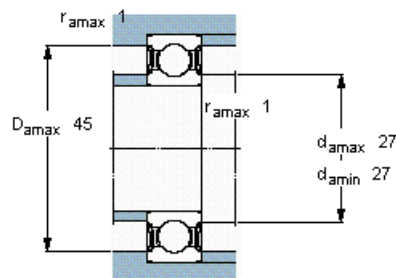
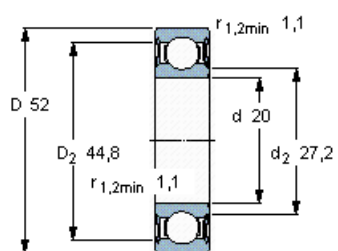

Calculation factors

$k_r = 0,03$

$f_0 = 12$