

Single level switches LS-1900, LS-1900T, LS-1950E, LS-74780



| | |
|--------------|---------------|
| RS Stock no. | Gems Part no. |
| 3957050 | 011-1900 |
| 3957072 | 010-3457 |
| 3957088 | 010-3089 |
| 3959343 | 011-1950 |
| 3957094 | 010-0391 |



LS-1900
With large float displacement, switch withstands rough service; is suitable for high viscosity liquids.

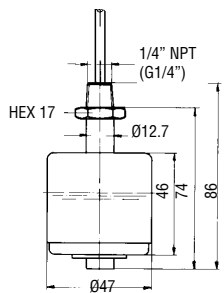

LS-1900T
Resists build-up of foreign material or sticky media. Float travel remains uninhibited in viscous or corrosive liquids.

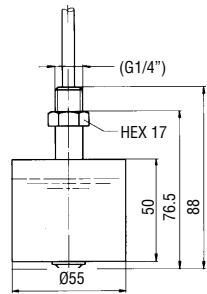

LS-1950E
Exceptionally accurate and rugged for higher temperatures and in pressurized or corrosive liquids. For oils, water and chemicals.

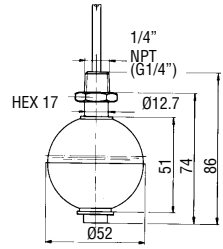

LS-74780
Particularly well suited for rough service. Ideal for use in chemical and plating applications.

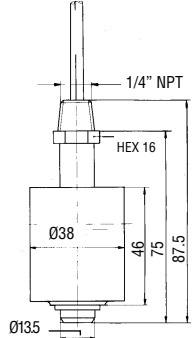

Specifications

| | LS-1900 | LS-1900T | LS-1950 | LS-74780 |
|--|--|--|---|---|
| Materials | | | | |
| Stem | Brass or S Steel | PTFE | S Steel | CPVC |
| Float | Buna N | PTFE | S Steel | CPVC |
| Operating pressure | 10 bar | 3 bar | 30 bar | 1 bar |
| Temperature: -40°C to | +80 °C Water | +150°C | +150°C | +80°C |
| NOTE: PVC cable limited to +80°C Ambient | +110°C Oil | | Hi-temp. version - Fly lead:+200°C | |
| Depth of immersion at a density of 1 | ~19 mm | ~ 34 mm | ~ 30 mm | ~ 28 mm |
| Min. specific gravity of the liquid | 0.55 g/cm ³ | 0.80 g/cm ³ | 0.75 g/cm ³ | 0.85 g/cm ³ |
| Type of reed switch | SPST 100 VA; SPDT 20 VA | SPST 100 VA; SPDT 20 VA | SPST 100 VA; SPDT 20 VA | SPST 20 VA |
| Electrical connection (Length approx. 1m) | Fly lead: AWG 20 FEP Cable: 0.34mm ² PVC | Fly lead: AWG 20 FEP Cable: 0.5mm ² silicone | Fly lead: AWG 20 FEP Cable: 0.5mm ² silicone* Cable: 0.34mm ² PVC Hi-temp. version - AWG 18 PTFE | Fly lead: AWG 18 PVC (Length appr. 0.6m) |
| Mounting thread | 1/4" NPT*; -G 1/4 | G 1/4 | G 1/4 | 1/4" NPT |
| Protection rating | IP64 | IP64 | IP64 Hi-temp IP60 | IP64 |
| Weight approx. | 110 g | 120g | 125g | 65g |

Order data

| Stem, Float, Mounting Electrical Connection | LS-1900 | LS-1900T | LS-1950E | LS-74780 |
|---|------------------------------|-------------------------|------------------------------|-------------|
| Brass/Buna, NPT, cable | 010-2934 NO/NC 010-2936 SPDT | | | |
| Brass/Buna, NPT, leads | 013-5676 NO/NC 010-2575 SPDT | | | |
| Brass/Buna, G, cable | 011-1900 NO/NC | | | |
| S Steel/Buna, NPT, cable | 010-2935 NO/NC 010-2937 SPDT | | | |
| S Steel/Buna, NPT, leads | 013-5682 NO/NC 010-2576 SPDT | | | |
| S Steel/S Steel, G, cable PVC | | | 011-1950 NO/NC | |
| S Steel/S Steel, G, leads | | | 014-1254 NO/NC 010-3109 SPDT | |
| S Steel/S Steel, G, cable Silicon | | | 010-3457 NO/NC 010-3089 SPDT | |
| S Steel/S Steel, NPT, leads, Hi-Temp | | | 013-6186 NO/NC | |
| S Steel/S Steel, G, leads, Hi-Temp | | | 010-0391 NO/NC | |
| S Steel/S Steel, NPT, cable Silicon | | | 010-2942 NO/NC 010-2943 SPDT | |
| S Steel/S Steel/NPT, leads | | | 012-6717 NO/NC 012-3498 SPDT | |
| PTFE/PTFE, G, cable | | 010-2697 NO 010-2866 NC | | |
| PTFE/PTFE, G, leads | | 010-3451 NO 010-3450 NC | | |
| PTFE/PTFE, G, cable | | 010-3054 SPDT | | |
| PTFE/PTFE, G, leads | | 010-3452 SPDT | | |
| CPVC/CPVC, NPT, leads | | | | 74780 NO/NC |