

- High flow rate**
- Compact design**
- Proven sealing system**
- Manual override as standard**
- Low Maintenance**
- Low power consumption solenoids**
- Air Pilot options available**
- Will control vacuum or pressure**
- Manifold system for easy assembly**
- Design multi pressure system manifolds**



### Technical data

#### Medium:

Compressed air, filtered to 50 µm, lubricated\* or non lubricated.

#### Operation:

Electromagnetically or pneumatically controlled

#### Mounting position:

Optional

#### Connection:

G 1/8 up to G 1/2

#### Operating pressure:

1,5/2 up to 8/10 bar

#### Flow direction:

Internal pilot supply: fixed

External pilot supply: optional

#### Flow:

Size	3/2, 5/2	2 x 3/2, 5/3
G1/8	750	500
G1/4	1300	950
G3/8	2600	1900
G1/2	4200	

#### Ambient temperature:

-10°C to +50°C

#### Fluid temperature:

-10°C to +50°C

Consult our Technical Service for use below +2°C.

### Materials

Housing and base plate: aluminium

Spindle: stainless steel,

Piston, spacers and cover: synthetic material Static and dynamic seals: NBR,

Screws: zinc plated

Springs: stainless steel.

\* Oil recommendation: Shell Hydrol DO 32, ESSO Febis K 32 (as of 07/92) or comparable oils with DVI values < 8 (DIN 53521) and ISO viscosity class 32 to 46 (DIN 51519)

### Ordering information

To place an order, choose the valve design and order the coil and plug separately

#### Typical Example:

You require a 1/8 bsp 5/2 Double Solenoid - operated valve with a 24 VDC Coil & Plug

From the table you can choose :

Valve = V60A511A-A2000

Coil = QM/48/13J/21

Plug = M/P19063XF

Standard Manual Override is

Push and turn to Lock

### Din Plug Connector types

Solenoid according to DIN EN 175 301-803 (DIN 43650 B).

### Connector types

Standard see data sheet 7.7.002

AS-i see data sheet 7.7.003

### Alternative models

NPT ports.





**5/2 directional control valves, solenoid actuated**

Symbol	Model	Port size	Pilot supply	Pilot exhaust	Solenoid variant	Flow (l/min)	Operating pressure (bar)	Pilot pressure (bar)	kg	Dimensional drawing no.
	V60A517A-A2000	G1/8	Internal	Not collected	1	750	2 ... 8	–	0,24	9
	V60A527A-A2000	G1/8	External	Not collected	1	750	-0,9 ... 8	3 ... 8	0,24	9
	V61B517A-A2000	G1/4	Internal	Not collected	1	1300	2 ... 8	–	0,33	9
	V61B527A-A2000	G1/4	External	Not collected	1	1300	-0,9 ... 8	3 ... 8	0,33	9
	V62C517A-A2000	G3/8	Internal	Not collected	1	2600	2 ... 8	–	0,62	9
	V62C527A-A2000	G3/8	External	Not collected	1	2600	-0,9 ... 8	3 ... 8	0,62	9
	V63D517A-A2000	G1/2	Internal	Not collected	1	4200	2 ... 8	–	0,96	12
	V63D527A-A2000	G1/2	External	Not collected	1	4200	-0,9 ... 8	3 ... 8	0,96	12

\*\*\* Insert coil code from table below or 000 for version without solenoid. For manual override options, substitute 'x' as follows: 1 = without manual override, 2 = push and lock, 3 = push only

**Coil & voltage codes**

Solenoid variant 1 (solenoid rotates 4 x 90°)  
22 mm coil DIN EN 175 301-803 (DIN 43650 B)

Voltage	Coil code	Power inrush/hold	Model
12 V d.c.	12L	2 W	V10626-A12L
24 V d.c.	13L	2 W	V10626-A13L
24 V 50/60 Hz	14L	4/2,5 VA	V10626-A14L
48 V 50/60 Hz	16L	4/2,5 VA	V10626-A16L
110/120 V 50/60 Hz	18L	4/2,5 VA	V10626-A18L
220/240 V 50/60 Hz	19L	6/5 VA	V10626-A19L

22 mm coil industrial standard

Voltage	Coil code	Power inrush/hold	Model
12 V d.c.	12J	2 W	QM/48/12J/21
24 V d.c.	13J	2 W	QM/48/13J/21
24 V 50/60 Hz	14J	4/2,5 VA	QM/48/14J/21
48 V 50/60 Hz	16J	4/2,5 VA	QM/48/16J/21
110/120 V 50/60 Hz	18J	4/2,5 VA	QM/48/18J/21
220/240 V 50/60 Hz	19J	6/5 VA	QM/48/19J/21

**Solenoid variant 2**

Double solenoid DIN EN 175 301-803 (DIN 43650 type C) 4 pin

Voltage	Coil code	Power inrush/hold	Manual override	Model
24 V d.c.	13 A	2 W	Push only	9031703900002400
24 V d.c.	13 A	2 W	Turn & lock	9031704900002400
24 V d.c.	13 A	2 W	Without	9031705900002400

Connector plugs must be ordered separately – see page 16

**Electrical details**

Voltage tolerance:	±10%
Rating:	100% E.D.
Protection class:	IP 65 with sealed plugs (ISO 6952)

**Plug configuration, valve side/twin pilot**

Symbol	Plug no.	Function	Actuation
	1	(+)	12 (Solenoid 2)
	2	(-)	12 + 14
	3	(+)	14 (Solenoid 1)



Drawing dimensions

9

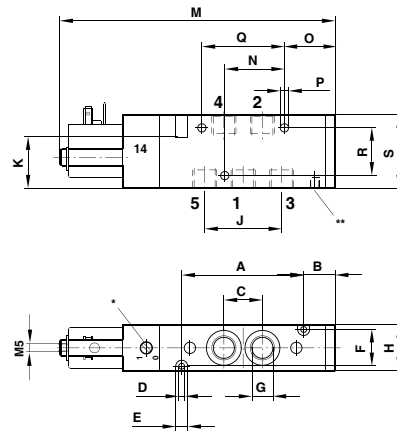

11

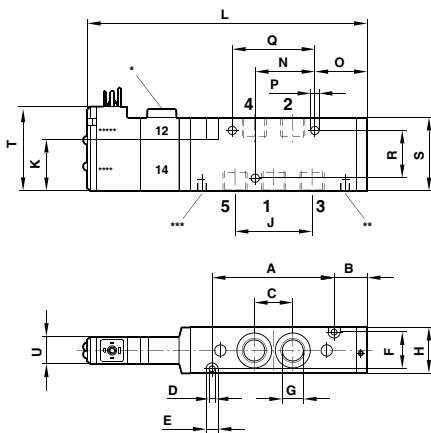

12

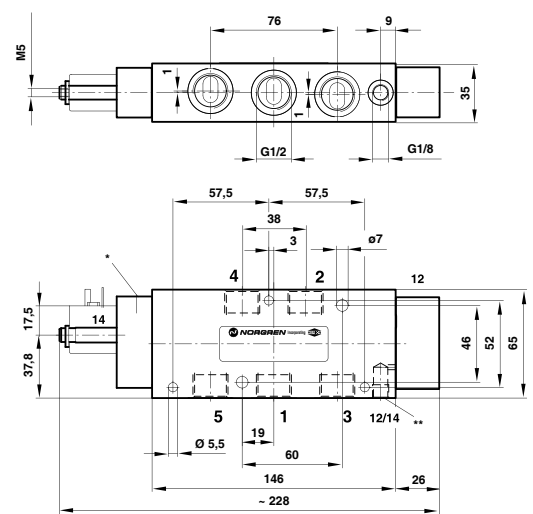

- \* Manual override
- \*\* External pilot supply (M5)
- \*\*\* Collected pilot exhaust (M5)
- \*\*\*\* Solenoid 1
- \*\*\*\*\* Solenoid 2









Dimensional drawing no.	Type	A	B	C	D	E	F	G	H	J	K	L	M	N	O	P	Q	R	S	T	U
9	V60	50	17	16,2	3,2	6,5	17	G1/8; 8 deep	22	32,4	28	-	129	25	25	4,5	33,6	26	35	-	-
9	V61	66	18	21	3,2	6,5	20	G1/4; 10 deep	25	42	28	-	150	32	29	4,5	44	26	40	-	-
9	V62	78	21	24,4	4,5	8	28	G3/8; 11,5 deep	34	48,8	44	-	170	12	60	4,5	26	36	55	-	-
10	V60	50	-	16,2	3,2	6,5	17	G1/8; 8 deep	22	32,4	28	175	-	25	-	4,5	33,6	26	35	-	-
10	V61	66	-	21	3,2	6,5	20	G1/4; 10 deep	25	42	28	199	-	32	-	4,5	44	26	40	-	-
10	V62	78	-	24,4	4,5	8	28	G3/8; 11,5 deep	34	48,8	44	218	-	12	-	4,5	26	36	55	-	-
11	V60	50	17	16,2	3,2	6,5	17	G1/8; 8 deep	22	32,4	28	134	-	25	25	4,5	33,6	26	35	46	15
11	V61	66	18	21	3,2	6,5	20	G1/4; 10 deep	25	42	28	153	-	32	29	4,5	44	26	40	46	15
11	V62	78	22	24,4	4,5	8	28	G3/8; 11,5 deep	34	48,8	44	172	-	12	61	4,5	26	36	55	54	15

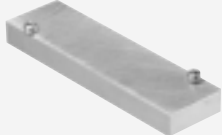







## Accessories





### Manifolds

				
Blanking plate	Blanking plug for 2 station and 3 station manifolds	Pressure shut-off part for 4 station up to 20 station manifolds	Intermediate supply/exhaust plate (instead of a valve)	Adapter plate to connect different manifold sizes
0100561 (V60) 0,050 kg	0701208 (V60) 0,006 kg	0100567 (V60) 0,010 kg	0101808 (V60) 0,110 kg	0102158 (V60□V61) on request
0100563 (V61) 0,060 kg	0701209 (V61) 0,012 kg	0100569 (V61) 0,015 kg	0101797 (V61) 0,220 kg	0102160 (V61□V62) on request
0100565 (V62) 0,100 kg	0701210 (V62) 0,020 kg	0100571 (V62) 0,020 kg	0101809 (V62) 0,390 kg	0102162 (V60□V62) on request
				
Pressure switch adapter plate	DIN Rail fixing kit	Blanking plug for port 12/14 and 82/84	Blanking plug for port 1, 3, 5	
0102146 (V60) 0,130 kg	0101796 (V60□V62) 0,010 kg	160050018 (V60□V62) 0,008 kg	160050028 (V60) 0,015 kg	
0102148 (V61) 0,160 kg			160050038 (V61) 0,020 kg	
0102150 (V62) 0,260 kg			160050048 (V62) 0,035 kg	

### Valves

				
Silencer sintered bronze	Exhaust flow regulator without silencer	Exhaust flow regulator with silencer	Diffusor for pilot exhaust	Circlip for coil fixing
0014400 M5 0,025 kg	4048004 G1/8 0,025 kg	4048005 G1/8 0,025 kg	81110800 0,002 kg	81021600 0,001 kg
0014510 G1/8 0,008 kg	4048104 G1/4 0,060 kg	4048105 G1/4 0,060 kg		
0014610 G1/4 0,010 kg	(G3/8 on request)	(G3/8 on request)		
0014710 G3/8 0,025 kg				
0014810 G1/2 0,060 kg				

### Connectors

				
Industrial standard 22 mm 2-pole + PE	DIN EN 175301-803 (DIN 43650 B)	DIN EN 175301-803 (DIN 43650 C)	DIN EN 175301-803 (DIN 43650 B)	DIN EN 175301-803 (DIN 43650 B)
M/P 19063 0,005 kg	0680003 0,005 kg	0588666 0,002 kg	0101033 0,030 kg	0101032 0,030 kg
12...250 V a.c./d.c.	12...250 V a.c./d.c.	12...250 V a.c./d.c.	1 output	1 output + 2 inputs with M12 x 1
0680000 0,005 kg	0664811 0,005 kg	0102144 0,200 kg		
15...30 V d.c.; LED, surge suppression	15...30 V d.c.; LED, surge suppression	12...250 V a.c./d.c.; cable 3 m		
0680001 0,005 kg	0664812 0,005 kg			
150...250 V a.c.; glim lamp	150...250 V a.c.; glim lamp			