

### KTIR0911S

#### Features

- Ultra-small
- Minimal influence from stray light
- Low collector-emitter saturation voltage
- ROHS Compliant.

#### Applications

- Optical control equipment.
- Cameras.
- Floppy disk drives.

#### Package Dimensions

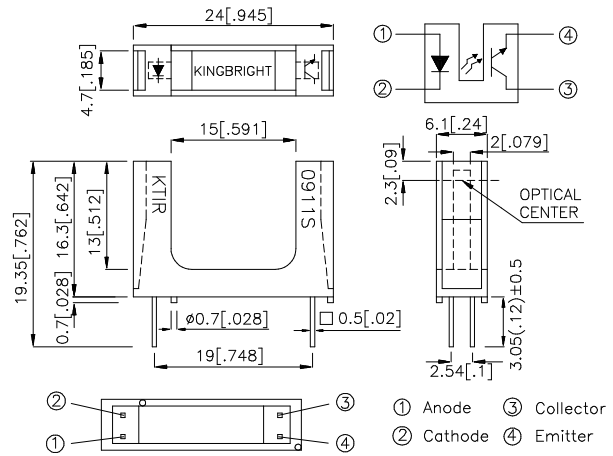

#### Notes:

1. All dimensions are in millimeters (inches).
2. Tolerance is  $\pm 0.25$  (0.01") unless otherwise noted.
3. Lead spacing is measured where the lead emerge package.
4. Specifications are subject to change without notice.

#### Absolute Maximum Ratings ( $T_a=25^\circ\text{C}$ )

Parameter		Symbol	Rating	Unit
Input	Forward current	$I_F$	50	mA
	Reverse voltage	$V_R$	6	V
	Power dissipation	P	75	mW
Output	Collector-emitter voltage	$V_{CEO}$	35	V
	Emitter-collector voltage	$V_{ECO}$	6	V
	Collector current	$I_C$	20	mA
	Collector power dissipation	$P_C$	75	mW
Operating temperature		$T_{opr}$	-25~+85	$^\circ\text{C}$
Storage temperature		$T_{stg}$	-40~+100	$^\circ\text{C}$
Soldering temperature (1/16 inch from body for 5 seconds)		$T_{sol}$	260	$^\circ\text{C}$

## Electro-optical Characteristics (T<sub>a</sub>=25°C)

Parameter		Symbol	Conditions	Min.	Typ.	Max.	Unit
Input	Forward voltage	V <sub>F</sub>	I <sub>F</sub> =20mA	1.0	1.2	1.5	V
	Reverse current	I <sub>R</sub>	V <sub>R</sub> =6V	—	—	10	μA
Output	Collector dark current	I <sub>CEO</sub>	V <sub>CE</sub> =20V	—	—	100	nA
Transfer characteristics	Collector-emitter saturation voltage	V <sub>CE(sat)</sub>	I <sub>C</sub> =1mA I <sub>F</sub> =40mA	—	—	0.4	V
	Current transfer ratio	CTR	V <sub>CE</sub> =5V I <sub>F</sub> =20mA	—	9.5	—	%
	Response time	Rise time	t <sub>r</sub>	V <sub>CE</sub> =2V I <sub>C</sub> =2mA R <sub>L</sub> =100Ω	—	5	25
Fall time		t <sub>f</sub>	—		4	20	μsec

**Fig.1 Forward Current vs. Forward Voltage**

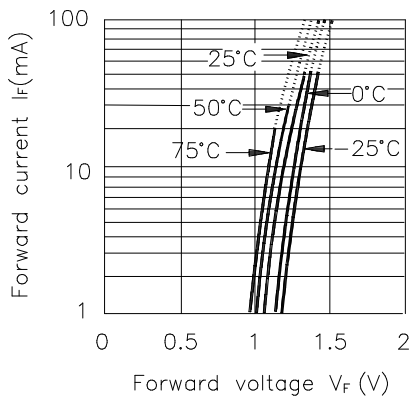

**Fig.2 Collector Current vs. Forward Current**

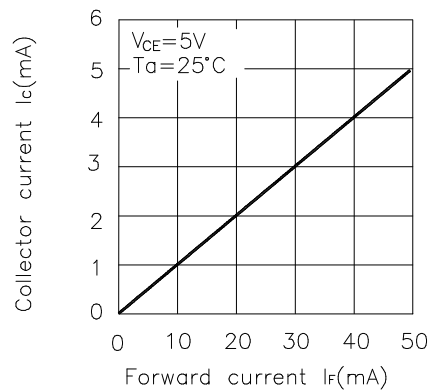

**Fig.3 Collector Current vs. Collector-emitter Voltage**

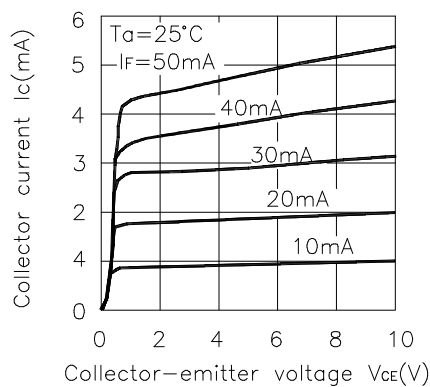

**Fig.4 Collector Current vs. Ambient Temperature**

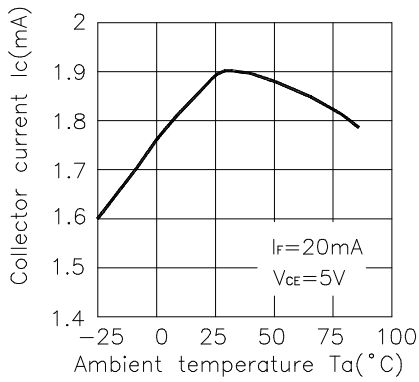

**Fig.5 Collector-emitter Saturation Voltage vs. Ambient Temperature**

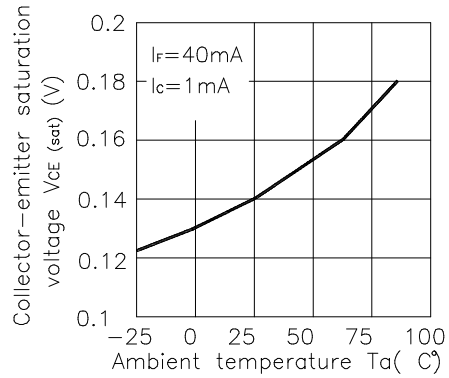

**Fig.6 Relative Collector Current vs. Shield Distance(1)**

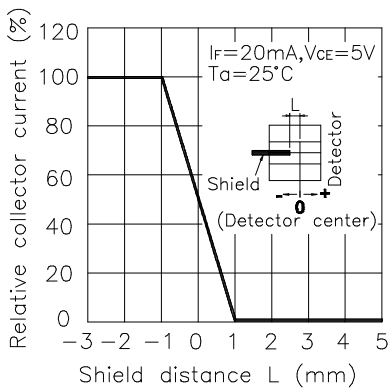

**Fig.7 Relative Collector Current vs. Shield Distance(2)**

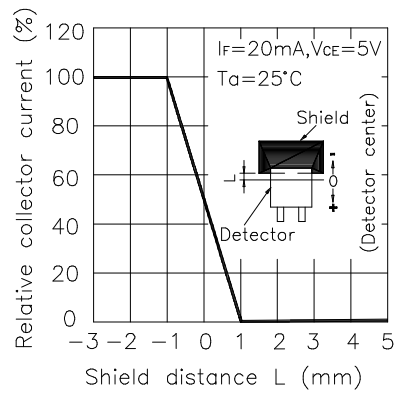

**Fig.8 Response Time vs. Load Resistance**

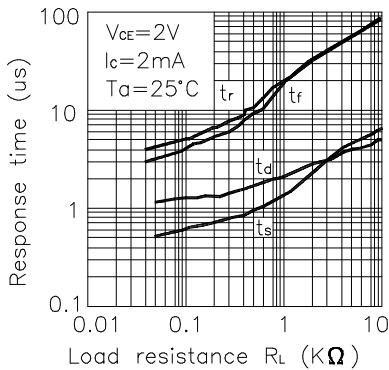

**Test Circuit for Response Time**

