

PRODUCT NUMBER  
10075025-XXX-XXXLF

- PLATING
- S = 0.38µm GOLD/GXT ON CONTACT AREA  
2µm MIN MATTE TIN ON TAIL
  - G = 0.76µm GOLD/GXT ON CONTACT AREA  
2µm MIN MATTE TIN ON TAIL
  - F = GOLD FLASH ON CONTACT AREA  
2µm MIN MATTE TIN ON TAIL  
1.27µm MIN NICKEL UNDERPLATING
- LEAD FREE  
ROHS COMPATIBLE  
NOTE 7
- PACKAGING  
NOTE 5
- TOTAL NUMBER OF  
POSITIONS 04 TO 50

PIN STYLE	TAIL LENGTH	MISSING PIN POSITION
01	2.00	
02	2.50	
03	2.00	A01

NOTES:

1. MATERIAL HOUSING: HIGH TEMP. THERMOPLASTIC  
UL 94V-0, COLOR NATURAL
2. MATERIAL TERMINAL: COPPER ALLOY
3. TO DETERMINE DIMENSIONS:  
N = NUMBER OF POSITIONS PER ROW
4. 7N MIN. PIN RETENTION IN EITHER DIRECTION.
5. PACKAGING:  
= STANDARD PACKAGING IN POLYBAG  
U = TUBE AVAILABLE FROM 03 TO 25 POS PER ROW  
A = TAPE & REEL WITH PICK UP CAP, AS AVAILABLE.
6. POLARIZATION :  
- SEE TABLE FOR AVAILABILITY  
- FOR NEW REQUEST, PLEASE TO CONTACT FCI
7. ROHS COMPATIBLE PRODUCT SPECIFICATIONS

- a - PLATING:  
- "LF" MEANS THE PRODUCT IS LEAD-FREE,  
2µm MINIMUM MATTE TIN OVER 1.27µm  
MINIMUM NICKEL UNDERPLATE.
- b - MANUFACTURING PROCESS COMPATIBILITY  
- THE HOUSING WILL WITHSTAND EXPOSURE TO  
260°C PEAK TEMPERATURE FOR 30 SECONDS MAX  
IN A CONVECTION, INFRA-RED, OR VAPOR PHASE  
OR REFLOW OVEN
- c - LABELLING:  
- MEETS PACKAGING SPECS AS PER GS-14-920
- d - LEGAL STATEMENT : SEE GS-47-0004

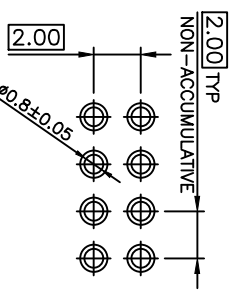
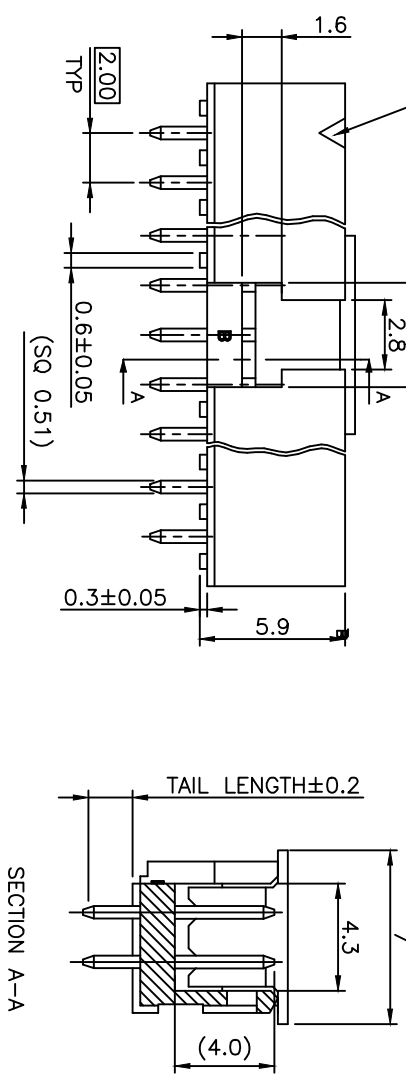
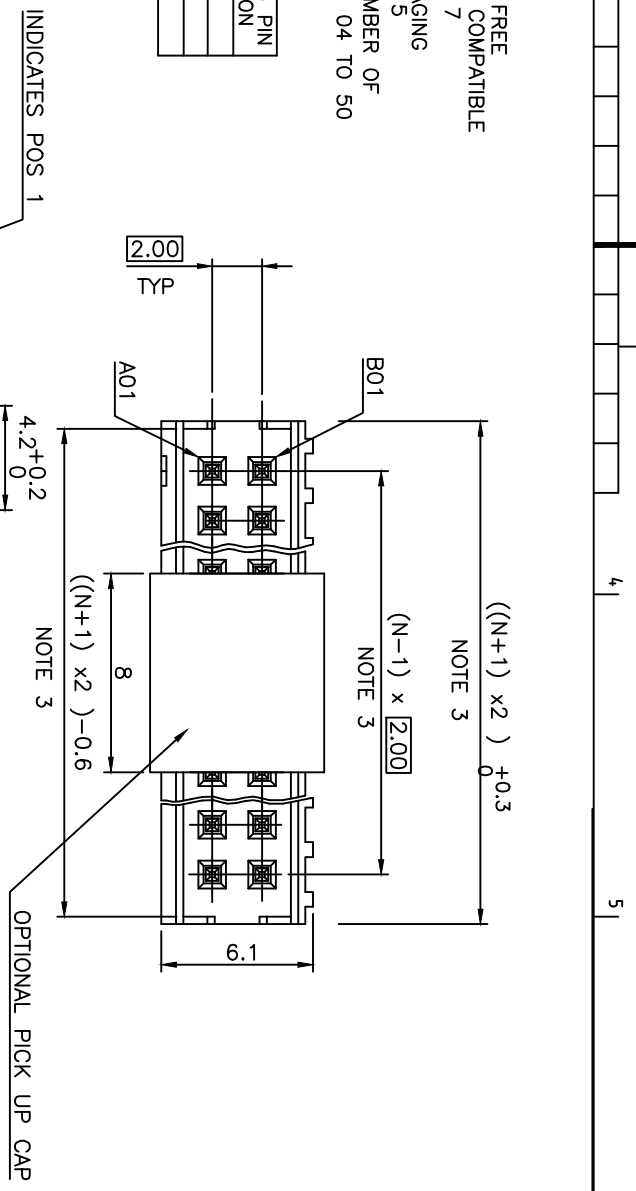

RECOMMENDED 1.6mm THICK PCB LAYOUT  
STENCIL DESIGN RECOMMENDATIONS  
AS PER TA-896

mat'l. code	surface	tolerance	projection	product family
lfr	ecn no	dr	date	ISO 1302
F-23051	AMA	16.01.15		ISO 416
S	F-24837	AMA	16.08.29	ISO 1101
T	F-24838	LWD	16.08.29	tolerance unless otherwise specified
M	B-20079	AMA	15.01.23	linear xx ±0.3
N	B-20254	LWD	15.02.16	xxx ±0.05
P	B-21209	AMA	15.06.22	Scale 5:1
sheet	revision	T	B	mm
index	sheet	1	2	mm

title: UNSHR.HEADER  
dwg no: 10075025  
sheet 1 of 2  
type: CUSTOMER Drawing

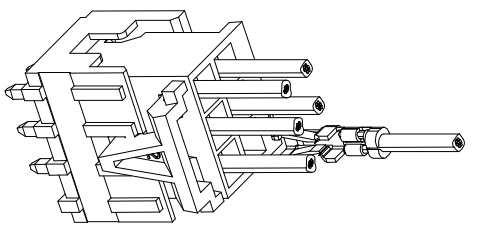
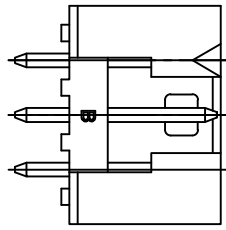
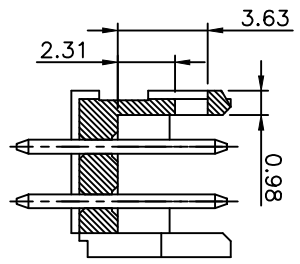
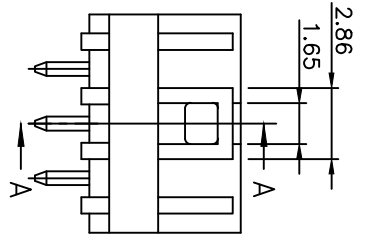

2x3 POS AND 2x4 POS CONFIGURATION  
NO LATCHING AVAILABLE FOR 2x2 POS

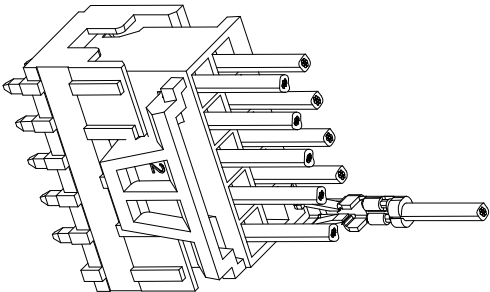
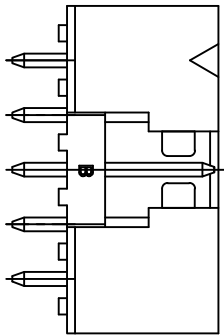
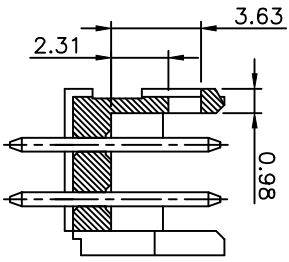
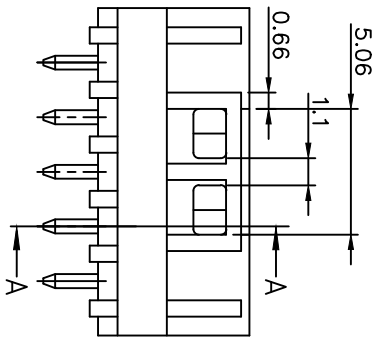

2x5 POS UP TO 2x25 POS CONFIGURATION

LATCHING FEATURES WHEN USED IN COMBINATION  
WITH ACTIVE LATCH HOUSING 10073599

mat'l. code	surface	tolerance	projection	product family
ISO 1302	ISO 406	ISO 1101	MINTEK	
tolerances unless otherwise specified	linear xx ±0.15	xx ±0.05	Scale 5:1	
angles	Linear			
dr L MULIN 07.12.04	enfr J.COMPARAGON 07.12.04	chr appd JM.C 07.12.04	UNSHR.HEADER	sheet no 10075025
2.00 mm VERTICAL PIP			sheet 2 of 2	size A3
			type CUSTOMER	Drawing