

3 Jan.1.2022 Copyright 2022 HIROSE ELECTRIC CO., LTD. All Rights Reserved.
 2 In case of consideration for using Automotive equipment / device which demand high reliability, kindly contact our sales window correspondents.

COUNT	DESCRIPTION OF REVISIONS	BY	CHKD	DATE	COUNT	DESCRIPTION OF REVISIONS	BY	CHKD	DATE
△					△				
△					△				
△					△				

- NOTE
- 1 APPLICABLE CRIMP CONTACT : RP34L-SC1-212(01)(CL113-5151-8-01).
 - 2 APPLICABLE CRIMP CONTACT EXTRACTION TOOL : RP6-SC-TP(CL150-0039-0).
 - 3 APPLICABLE CRIMPING JIG : RP34-TC-01(CL150-0074-1).
 - 4 THIS PRODUCT DISASSEMBLED WHEN DELIVERED.

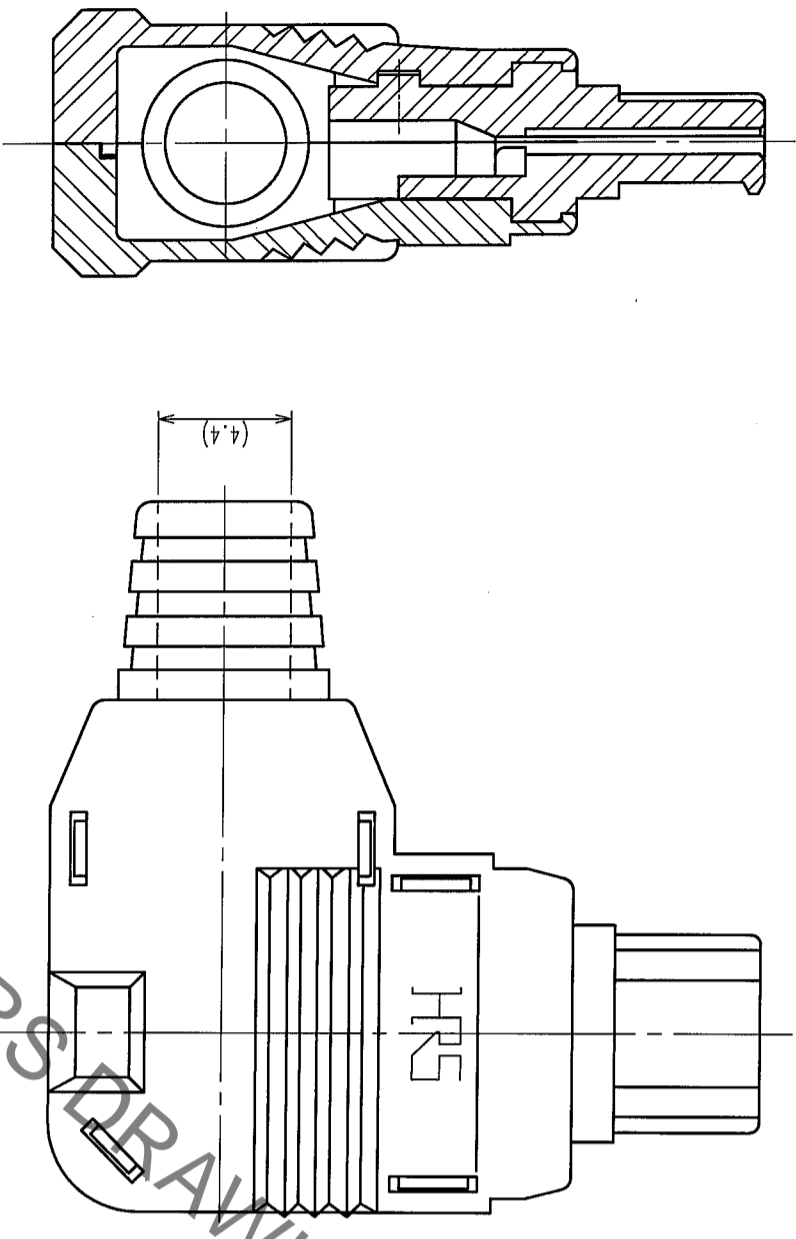
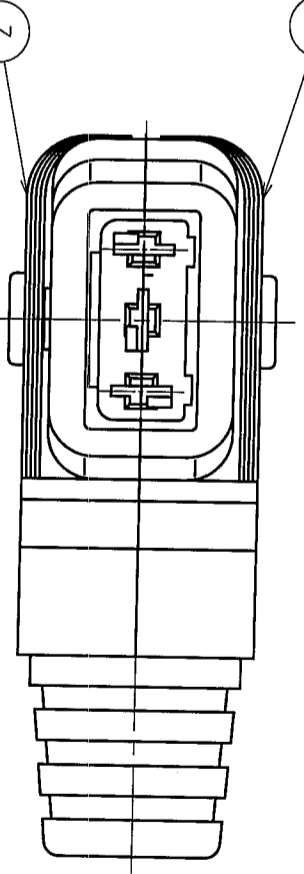
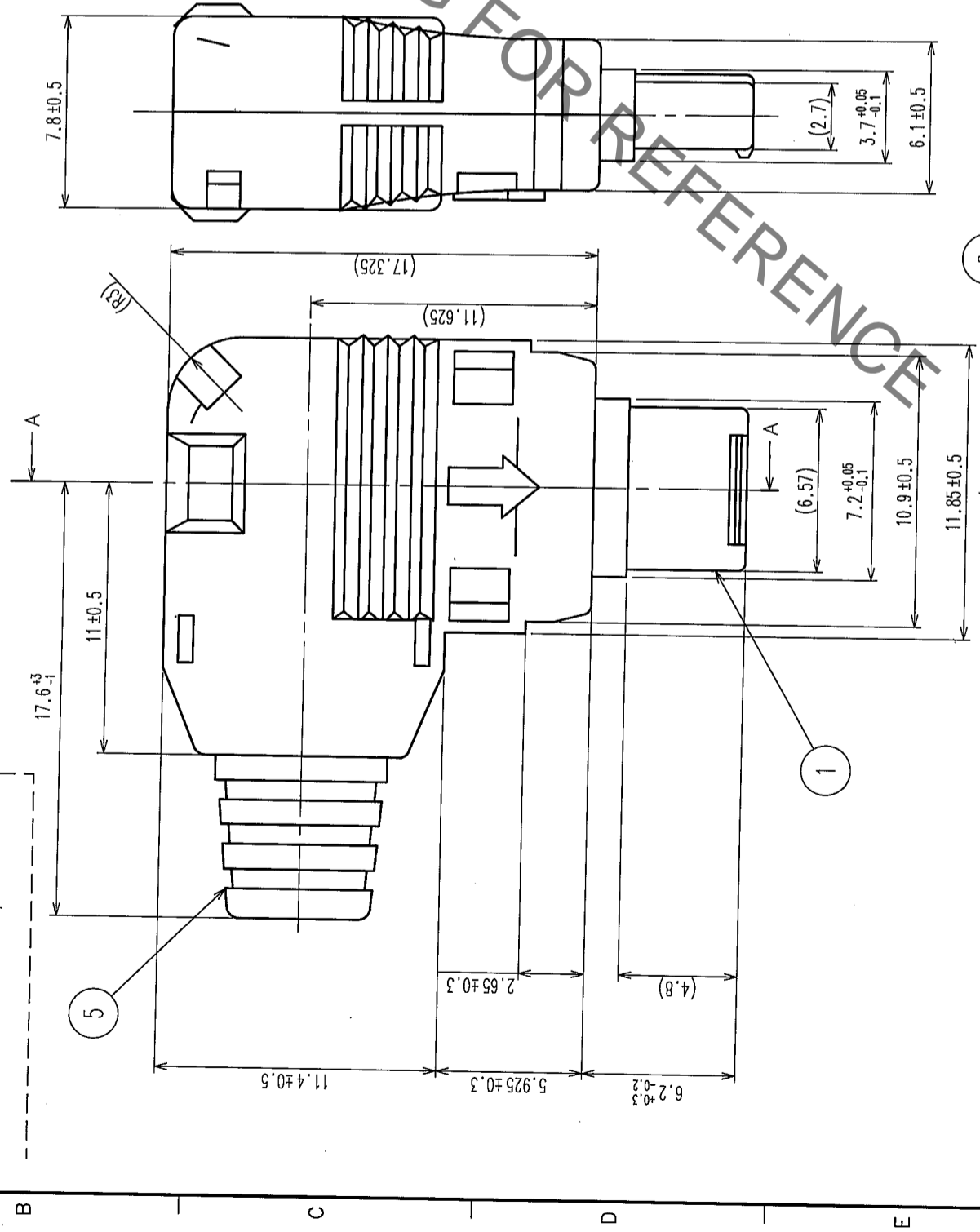

3	POLYCARBONATE (BLACK) UL94V-0	5	VINYLE (BLACK) UL94V-0		
2	POLYCARBONATE (BLACK) UL94V-0	4	BRASS		
1	PPS (BLACK) UL94V-0				
NO.	MATERIAL	FINISH, REMARKS	NO.	MATERIAL	FINISH, REMARKS
CODE NO. (OLD) CL					
DRAWN M. Ishihara		DESIGNED E. Yamino		CHECKED H. Zamba	
		05.9.26		05.09.26	
				05.09.28	
DRAWING NO. EDC3-111810-71			PART NO. RP34L-5LP-3SC(71)		
SCALE 4 : 1			CODE NO. CL113-5161-1-71		
UNITS mm			HIROSE ELECTRIC CO., LTD		

TO
R

Mouser Electronics

Authorized Distributor

Click to View Pricing, Inventory, Delivery & Lifecycle Information:

[Hirose Electric:](#)

[RP34L-5LP-3SC\(71\)](#)